

HEXAGONAL BOLT WITH THREAD UP TO THE HEAD

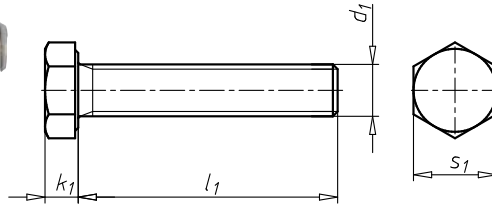
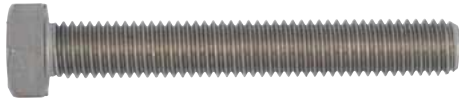

ISO 4017, stainless steel A2-50 and A2-70, plain

Notice

ISO 4017 replaces DIN 933 | There is some compatibility | Nominal size extended | Widths across flats for M10, M12, M14 and M22 changed. A2-70 strength up to and including nominal size M24 | above nominal size M27 strength A2-50

Norms	ISO 4017
Material	Stainless steel A2
Surface	Bare
RoHS-compliant	Yes
Head type	Hexagon head
Drive type	Outer hexagon
Thread type	Metric thread
Thread format	Standard metric thread
Thread design	Full thread

Thread type x nominal diameter (d ₁)	Length (l ₁)	Head height (k ₁)	External drive (s ₁)	Property class	Product class	Art. No.	P. Qty.
M2	4 mm	1.4 mm	WS4	70	A	0096 2 4	1000
M2	5 mm	1.4 mm	WS4	70	A	0096 2 5	1000
M2	6 mm	1.4 mm	WS4	70	A	0096 2 6	500
M2	12 mm	1.4 mm	WS4	70	A	0096 2 12	1000
M2	14 mm	1.4 mm	WS4	70	A	0096 2 14	1000
M2	20 mm	1.4 mm	WS4	70	A	0096 2 20	100
M2	25 mm	1.4 mm	WS4	70	B	0096 2 25	100
M2	30 mm	1.4 mm	WS4	70	B	0096 2 30	100
M2	35 mm	1.4 mm	WS4	70	B	0096 2 35	100
M2	40 mm	1.4 mm	WS4	70	B	0096 2 40	100
M2	55 mm	1.4 mm	WS4	70	B	0096 2 55	100
M2.5	4 mm	1.7 mm	WS5	70	A	0096 25 4	1000
M2.5	5 mm	1.7 mm	WS5	70	A	0096 25 5	1000
M2.5	10 mm	1.7 mm	WS5	70	A	0096 25 10	1000
M2.5	20 mm	1.7 mm	WS5	70	A	0096 25 20	100
M3	4 mm	2 mm	WS5.5	70	A	0096 3 4	1000
M3	5 mm	2 mm	WS5.5	70	A	0096 3 5	500
M3	6 mm	2 mm	WS5.5	70	A	0096 3 6	1000
M3	8 mm	2 mm	WS5.5	70	A	0096 3 8	1000
M3	10 mm	2 mm	WS5.5	70	A	0096 3 10	1000
M3	12 mm	2 mm	WS5.5	70	A	0096 3 12	1000
M3	14 mm	2 mm	WS5.5	70	A	0096 3 14	1000
M3	16 mm	2 mm	WS5.5	70	A	0096 3 16	1000
M3	18 mm	2 mm	WS5.5	70	A	0096 3 18	1000
M3	20 mm	2 mm	WS5.5	70	A	0096 3 20	1000
M3	22 mm	2 mm	WS5.5	70	A	0096 3 22	1000
M3	25 mm	2 mm	WS5.5	70	A	0096 3 25	500
M3	30 mm	2 mm	WS5.5	70	A	0096 3 30	500
M3	35 mm	2 mm	WS5.5	70	B	0096 3 35	500
M3	40 mm	2 mm	WS5.5	70	B	0096 3 40	500
M3	50 mm	2 mm	WS5.5	70	B	0096 3 50	200
M3	70 mm	2 mm	WS5.5	70	B	0096 3 70	200