

# HEXAGONAL BOLT WITH THREAD UP TO THE HEAD

ISO 4017, stainless steel A2-50 and A2-70, plain

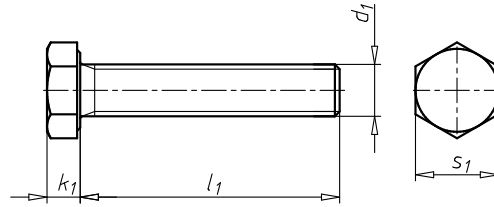

Thread type x nominal diameter (d <sub>1</sub> )	Length (l <sub>1</sub> )	Head height (k <sub>1</sub> )	External drive (s <sub>1</sub> )	Property class	Product class	Art. No.	P. Qty.
M6	6 mm	4 mm	WS10	70	A	<b>0096 6 6</b>	100
M6	8 mm	4 mm	WS10	70	A	<b>0096 6 8</b>	200
M6	10 mm	4 mm	WS10	70	A	<b>0096 6 10</b>	100
M6	12 mm	4 mm	WS10	70	A	<b>0096 6 12</b>	100
M6	14 mm	4 mm	WS10	70	A	<b>0096 6 14</b>	100
M6	15 mm	4 mm	WS10	70	A	<b>0096 6 15</b>	1000
M6	16 mm	4 mm	WS10	70	A	<b>0096 6 16</b>	100
M6	18 mm	4 mm	WS10	70	A	<b>0096 6 18</b>	100
M6	20 mm	4 mm	WS10	70	A	<b>0096 6 20</b>	100
M6	22 mm	4 mm	WS10	70	A	<b>0096 6 22</b>	100
M6	25 mm	4 mm	WS10	70	A	<b>0096 6 25</b>	100
M6	28 mm	4 mm	WS10	70	A	<b>0096 6 28</b>	100
M6	30 mm	4 mm	WS10	70	A	<b>0096 6 30</b>	100
M6	35 mm	4 mm	WS10	70	A	<b>0096 6 35</b>	100
M6	40 mm	4 mm	WS10	70	A	<b>0096 6 40</b>	100
M6	45 mm	4 mm	WS10	70	A	<b>0096 6 45</b>	100
M6	50 mm	4 mm	WS10	70	A	<b>0096 6 50</b>	100
M6	55 mm	4 mm	WS10	70	A	<b>0096 6 55</b>	100
M6	60 mm	4 mm	WS10	70	A	<b>0096 6 60</b>	100
M6	65 mm	4 mm	WS10	70	B	<b>0096 6 65</b>	100
M6	70 mm	4 mm	WS10	70	B	<b>0096 6 70</b>	100
M6	75 mm	4 mm	WS10	70	B	<b>0096 6 75</b>	100
M6	80 mm	4 mm	WS10	70	B	<b>0096 6 80</b>	100
M6	90 mm	4 mm	WS10	70	B	<b>0096 6 90</b>	100
M6	95 mm	4 mm	WS10	70	B	<b>0096 6 95</b>	100
M6	100 mm	4 mm	WS10	70	B	<b>0096 6 100</b>	100
M6	110 mm	4 mm	WS10	70	B	<b>0096 6 110</b>	100
M6	120 mm	4 mm	WS10	70	B	<b>0096 6 120</b>	100
M6	140 mm	4 mm	WS10	70	B	<b>0096 6 140</b>	50
M6	170 mm	4 mm	WS10	70	B	<b>0096 6 170</b>	50