

HEXAGONAL BOLT WITH THREAD UP TO THE HEAD

ISO 4017, stainless steel A2-50 and A2-70, plain

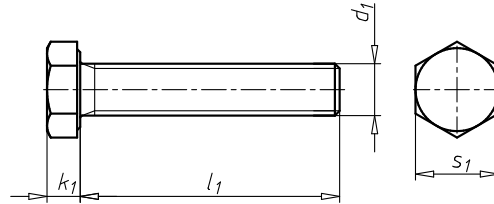

Thread type x nominal diameter (d ₁)	Length (l ₁)	Head height (k ₁)	External drive (s ₁)	Property class	Product class	Art. No.	P. Qty.
M20	20 mm	12.5 mm	WS30	70	A	0096 20 20	25
M20	25 mm	12.5 mm	WS30	70	A	0096 20 25	25
M20	30 mm	12.5 mm	WS30	70	A	0096 20 30	25
M20	35 mm	12.5 mm	WS30	70	A	0096 20 35	25
M20	40 mm	12.5 mm	WS30	70	A	0096 20 40	25
M20	45 mm	12.5 mm	WS30	70	A	0096 20 45	25
M20	50 mm	12.5 mm	WS30	70	A	0096 20 50	25
M20	55 mm	12.5 mm	WS30	70	A	0096 20 55	25
M20	60 mm	12.5 mm	WS30	70	A	0096 20 60	25
M20	65 mm	12.5 mm	WS30	70	A	0096 20 65	25
M20	70 mm	12.5 mm	WS30	70	A	0096 20 70	25
M20	75 mm	12.5 mm	WS30	70	A	0096 20 75	25
M20	80 mm	12.5 mm	WS30	70	A	0096 20 80	25
M20	85 mm	12.5 mm	WS30	70	A	0096 20 85	25
M20	90 mm	12.5 mm	WS30	70	A	0096 20 90	25
M20	95 mm	12.5 mm	WS30	70	A	0096 20 95	25
M20	100 mm	12.5 mm	WS30	70	A	0096 20 100	25
M20	110 mm	12.5 mm	WS30	70	A	0096 20 110	25
M20	120 mm	12.5 mm	WS30	70	A	0096 20 120	25
M20	130 mm	12.5 mm	WS30	70	A	0096 20 130	10
M20	140 mm	12.5 mm	WS30	70	A	0096 20 140	10
M20	150 mm	12.5 mm	WS30	70	A	0096 20 150	10
M20	160 mm	12.5 mm	WS30	70	B	0096 20 160	10
M20	170 mm	12.5 mm	WS30	70	B	0096 20 170	10
M20	180 mm	12.5 mm	WS30	70	B	0096 20 180	10
M20	190 mm	12.5 mm	WS30	70	B	0096 20 190	10
M20	200 mm	12.5 mm	WS30	70	B	0096 20 200	10
M20	210 mm	12.5 mm	WS30	70	B	0096 20 210	10
M20	220 mm	12.5 mm	WS30	70	B	0096 20 220	10
M20	300 mm	12.5 mm	WS30	70	B	0096 20 300	10
M22	45 mm	14 mm	WS32	70	A	0096 922 45	10
M22	50 mm	14 mm	WS32	70	A	0096 922 50	10
M22	55 mm	14 mm	WS32	70	A	0096 922 55	10
M22	60 mm	14 mm	WS32	70	A	0096 922 60	10
M22	65 mm	14 mm	WS32	70	A	0096 922 65	10
M22	70 mm	14 mm	WS32	70	A	0096 922 70	10
M22	80 mm	14 mm	WS32	70	A	0096 922 80	10
M22	90 mm	14 mm	WS32	70	A	0096 922 90	10
M22	100 mm	14 mm	WS32	70	A	0096 922 100	10
M22	110 mm	14 mm	WS32	70	A	0096 922 110	10
M22	120 mm	14 mm	WS32	70	A	0096 922 120	10
M22	130 mm	14 mm	WS32	70	A	0096 922 130	10
M22	140 mm	14 mm	WS32	70	A	0096 922 140	10
M22	150 mm	14 mm	WS32	70	A	0096 922 150	10