

HEXAGONAL BOLT WITH THREAD UP TO THE HEAD

ISO 4017, stainless steel A2-50 and A2-70, plain

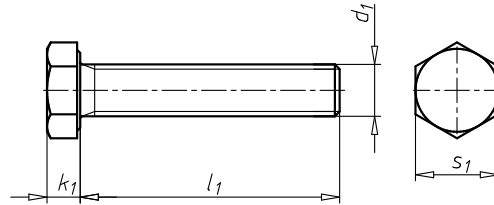

Thread type x nominal diameter (d ₁)	Length (l ₁)	Head height (k ₁)	External drive (s ₁)	Property class	Product class	Art. No.	P. Qty.
M24	30 mm	15 mm	WS36	70	A	0096 24 30	25
M24	35 mm	15 mm	WS36	70	A	0096 24 35	20
M24	40 mm	15 mm	WS36	70	A	0096 24 40	10
M24	45 mm	15 mm	WS36	70	A	0096 24 45	10
M24	50 mm	15 mm	WS36	70	A	0096 24 50	10
M24	55 mm	15 mm	WS36	70	A	0096 24 55	10
M24	60 mm	15 mm	WS36	70	A	0096 24 60	10
M24	65 mm	15 mm	WS36	70	A	0096 24 65	10
M24	70 mm	15 mm	WS36	70	A	0096 24 70	10
M24	75 mm	15 mm	WS36	70	A	0096 24 75	25
M24	80 mm	15 mm	WS36	70	A	0096 24 80	10
M24	85 mm	15 mm	WS36	70	A	0096 24 85	10
M24	90 mm	15 mm	WS36	70	A	0096 24 90	10
M24	100 mm	15 mm	WS36	70	A	0096 24 100	10
M24	110 mm	15 mm	WS36	70	A	0096 24 110	10
M24	120 mm	15 mm	WS36	70	A	0096 24 120	10
M24	130 mm	15 mm	WS36	70	A	0096 24 130	10
M24	140 mm	15 mm	WS36	70	A	0096 24 140	10
M24	150 mm	15 mm	WS36	70	A	0096 24 150	10
M24	160 mm	15 mm	WS36	70	B	0096 24 160	10
M24	170 mm	15 mm	WS36	70	B	0096 24 170	5
M24	180 mm	15 mm	WS36	70	B	0096 24 180	5
M24	190 mm	15 mm	WS36	70	B	0096 24 190	5
M24	220 mm	15 mm	WS36	70	B	0096 24 220	5
M27	60 mm	17 mm	WS41	50	B	0096 27 60	5
M27	65 mm	17 mm	WS41	50	B	0096 27 65	5
M27	70 mm	17 mm	WS41	50	B	0096 27 70	5
M27	80 mm	17 mm	WS41	50	B	0096 27 80	5
M27	85 mm	17 mm	WS41	50	B	0096 27 85	5
M27	90 mm	17 mm	WS41	50	B	0096 27 90	5
M27	95 mm	17 mm	WS41	50	B	0096 27 95	10
M27	100 mm	17 mm	WS41	50	B	0096 27 100	5
M27	110 mm	17 mm	WS41	50	B	0096 27 110	5
M27	120 mm	17 mm	WS41	50	B	0096 27 120	5
M27	130 mm	17 mm	WS41	50	B	0096 27 130	5
M27	140 mm	17 mm	WS41	50	B	0096 27 140	5
M27	150 mm	17 mm	WS41	50	B	0096 27 150	5