

## SANDING BELTS

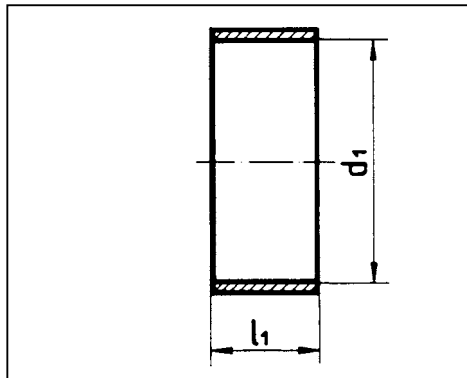

$d_1$ mm	$l_1$ mm	P 50 <b>Art. No.</b>	P 80 <b>Art. No.</b>	P 150 <b>Art. No.</b>	P 240 <b>Art. No.</b>	Pack Qty.
12	10	-	<b>0589 112 102</b>	<b>0589 112 103</b>	<b>0589 112 104</b>	10
22	20	-	<b>0589 122 202</b>	<b>0589 122 203</b>	<b>0589 122 204</b>	
30	30	<b>0589 130 301</b>	<b>0589 130 302</b>	<b>0589 130 303</b>	-	
45		<b>0589 145 301</b>	<b>0589 145 302</b>	<b>0589 145 303</b>	-	
60		<b>0589 160 301</b>	<b>0589 160 302</b>	<b>0589 160 303</b>	-	

### Linen backed sanding belts with aluminium oxide grain.

- Aluminium oxide (corundum).
- Linen with synthetic resin bonding.
- Centrifugal clamping ensures non-slip seating of sanding belt.
- High working capacity due to flexibility of support material.
- Cool sanding action ensures no tarnishing of work pieces.
- Synthetic resin and fillers can be worked with an appropriately coarse grain.

### Application Areas:

Forged steel, malleable cast iron, nodular cast iron, carbon steel, deep-drawing steel, strip steel, Cr-Ni and other stainless steels, non-ferrous metals, wood, cast resin and fillers.

## RUBBER BELT SUPPORT

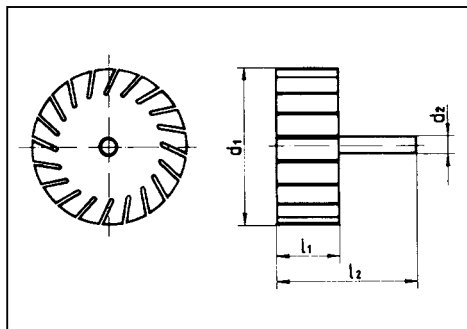
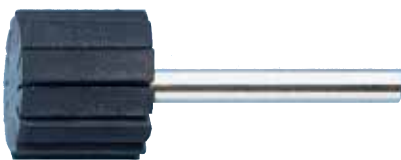

$d_1$ mm	$d_2$ mm	$l_1$ mm	$l_2$ mm	Max. Permissible Speed r.p.m. <sup>-1</sup>	<b>Art. No.</b>	Pack Qty.
12	6	10	50	48,000	<b>0589 112 100</b>	1
22		20	60	23,000	<b>0589 122 200</b>	
30		30	70	19,000	<b>0589 130 300</b>	
45				13,000	<b>0589 145 300</b>	
60				9,500	<b>0589 160 300</b>	

### Rubber-ended mandrel for sanding belts.

- Hard wearing rubber compound.
- Flexible to allow for easy fitment.