

Screw seal, self-centring

Steel washer with moulded-on rubber sealing lip

- Galvanised steel, blue passivated (A2K)
- Steel washer with moulded-on rubber sealing lip; for sealing bolt heads (primarily used with metric hexagon bolts in accordance with German DIN standard) and flange connections.
- For high pressure, vacuum and broad temperature ranges.
- Optimum sealing effect due to precisely defined lip formation.
- No pressing out, even under extreme pressure conditions thanks to metal-metal contact.
- Minimal tightening torque
- No retightening of installed seal
- Replaces other previously used seals
- Can be used several times
- Quick, easy and reliable installation.
- Overhead installation possible
- No special machining of metal surface required.
- Temperature resistant from -35°C to $+120^{\circ}\text{C}$
- Hardness of rubber seal: 65-75 Shore



Material	Steel
Surface	Zinc plated
RoHS-compliant	Yes
Shore A hardness	70 +/- 5

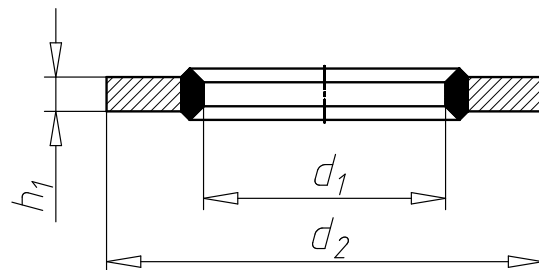

Suitable for screw	Internal diameter (d_1)	Outer diameter (d_2)	Thickness (h_1)	Art. no.	P. Qty.
M4	4 mm	8 mm	1 mm	0469 004	50
M5	5 mm	9 mm	1 mm	0469 005	50/1000
M6	6 mm	10 mm	1 mm	0469 006	50
M8	8 mm	14 mm	1 mm	0469 008	50
M10	10 mm	17 mm	1.5 mm	0469 001 0	50
M12	12 mm	19 mm	1.5 mm	0469 001 2	50
M14	14 mm	22 mm	1.5 mm	0469 001 4	50
M16	16 mm	24 mm	1.5 mm	0469 001 6	50
M18	18 mm	27 mm	2 mm	0469 001 8	50
M20	20 mm	30 mm	2 mm	0469 002 0	50/200
M22	22 mm	32 mm	2 mm	0469 002 2	50
M24	24 mm	36 mm	2 mm	0469 002 4	50

Can be stored in ORSY system

Instructions

Professional installation:

It is recommended that a centring recess is provided for the sealing washer to prevent the seal being placed in an eccentric position.

