

Wing repair washer

According to DIN 522, galvanised steel, blue passivated (A2K)

Standards	DIN 522
Material	Steel
Vickers hardness, HV	140 HV
Surface	Zinc plated
RoHS-compliant	Yes

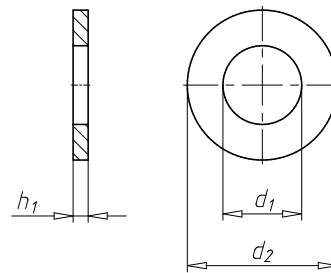

Suitable for screw thread	Internal diameter (d_1)	Outer diameter (d_2)	Thickness (h_1)	Art. no.	P. Qty.
M3	3.2 mm	7 mm	0.5 mm	0411 3 7	10000
M3	3.2 mm	10 mm	0.8 mm	0411 3 10	100/500 /1000 /10000
M3	3.2 mm	20 mm	1.25 mm	0411 3 20	100/500 /1000
M4	4.3 mm	12 mm	1.25 mm	0411 4 12	100/500 /1000 /2000
M4	4.3 mm	16 mm	1.5 mm	0411 04 16	2000
M4	4.3 mm	20 mm	1.25 mm	0411 4 20	100/300 /1000 /2000
M5	5.3 mm	15 mm	1.25 mm	0411 5 15	100/500 /1000 /2000
M5	5.3 mm	20 mm	1.25 mm	0411 5 20	100 /250/500 /1000 /2000
M5	5.3 mm	20 mm	1.5 mm	0411 5 205	1000
M5	5.3 mm	25 mm	1.25 mm	0411 5 25	100/300 /1000 /2000
M5	5.3 mm	25 mm	1.5 mm	0411 5 255	1000

Suitable for screw thread	Internal diameter (d ₁)	Outer diameter (d ₂)	Thickness (h ₁)	Art. no.	P. Qty.
M5	5.3 mm	30 mm	1.25 mm	0411 5 30	100 /300/500 /1000
M6	6.4 mm	15 mm	1.5 mm	0411 6 15	100/500 /1000
M6	6.4 mm	18 mm	1.5 mm	0411 6 18	100/500 /1000 /2000
M6	6.4 mm	20 mm	1.25 mm	0411 6 20	100 /250/500 /1000 /2000
M6	6.4 mm	20 mm	1.5 mm	0411 6 201	2000
M6	6.4 mm	20 mm	2 mm	0411 6 202	100/300 /500
M6	6.4 mm	25 mm	1.25 mm	0411 6 25	100 /300/500 /1000
M6	6.4 mm	30 mm	1.25 mm	0411 6 30	100/300 /500
M6	6.4 mm	30 mm	1.5 mm	0411 6 301	500
M6	6.4 mm	30 mm	2 mm	0411 6 302	100/300 /400
M6	6.4 mm	40 mm	1.5 mm	0411 6 40	100/300 /500
M6	6.4 mm	40 mm	2 mm	0411 6 402	500
M6	6.4 mm	40 mm	3 mm	0411 6 403	100/200
M7	7.4 mm	20 mm	1.25 mm	0411 7 20	100
M7	7.4 mm	25 mm	1.25 mm	0411 7 25	100
M8	8.4 mm	16 mm	2 mm	0411 8 16	100/2000
M8	8.4 mm	20 mm	1.25 mm	0411 8 20	100 /300/500 /1000
M8	8.4 mm	25 mm	1.25 mm	0411 8 24	100 /300/500 /1000
M8	8.4 mm	25 mm	1.5 mm	0411 8 25	100/300 /1000
M8	8.4 mm	25 mm	2 mm	0411 8 252	100/500 /1000
M8	8.4 mm	25 mm	3 mm	0411 8 243	100/300 /600
M8	8.4 mm	30 mm	1.5 mm	0411 8 30	100/300 /750
M8	8.4 mm	30 mm	2 mm	0411 8 301	500
M8	8.4 mm	30 mm	2.5 mm	0411 8 302	100/500
M8	8.4 mm	32 mm	2.5 mm	0411 08 32	500
M8	8.4 mm	40 mm	2 mm	0411 8 40	100/300
M8	8.4 mm	40 mm	3 mm	0411 8 403	100/200 /300
M10	10 mm	16 mm	0.5 mm	0411 10 16	5000
M10	10 mm	20 mm	2 mm	0411 10 22	1000
M10	10.5 mm	20 mm	1.5 mm	0411 10 20	100/500 /2000
M10	10.5 mm	25 mm	1.5 mm	0411 10 25	100/500 /1000
M10	10.5 mm	25 mm	4 mm	0411 10 24	100/500

Suitable for screw thread	Internal diameter (d ₁)	Outer diameter (d ₂)	Thickness (h ₁)	Art. no.	P. Qty.
M10	10.5 mm	30 mm	1.5 mm	0411 10 30	100/500 /750
M10	10.5 mm	30 mm	3 mm	0411 10 303	100/300 /400
M10	10.5 mm	30 mm	4 mm	0411 10 304	100/300
M10	10.5 mm	40 mm	2 mm	0411 10 40	100/300
M10	10.5 mm	40 mm	2.5 mm	0411 010 40	300
M12	13 mm	26 mm	2.5 mm	0411 12 26	100/500
M12	13 mm	32 mm	1.5 mm	0411 12 30	100/300 /500
M12	13 mm	36 mm	2.5 mm	0411 012 36	300
M12	13 mm	40 mm	2 mm	0411 12 40	100/300
M12	13 mm	40 mm	4 mm	0411 12 404	100/200
M12	13 mm	48 mm	3 mm	0411 012 48	400
M12	13 mm	50 mm	2.5 mm	0411 12 50	50/100
M14	14.5 mm	42 mm	3 mm	0411 014 42	100
M14	15 mm	30 mm	1.5 mm	0411 14 30	50/100 /1000
M14	15 mm	40 mm	2 mm	0411 14 40	50/100
M14	15 mm	40 mm	4 mm	0411 14 404	50/200
M14	15 mm	45 mm	2 mm	0411 14 45	50/100
M14	15 mm	50 mm	2.5 mm	0411 14 50	50/100 /200
M16	17 mm	40 mm	2 mm	0411 16 40	50/100
M16	17 mm	50 mm	2 mm	0411 16 50	50/100
M16	17 mm	50 mm	4 mm	0411 16 504	50/100