

Countersunk head screw with recessed head, H

DIN 965, steel 4.8, galvanised, blue passivated (A2K)

Standards	DIN 965
Material	Steel
Property class	4.8
Surface	Zinc plated
RoHS-compliant	Yes

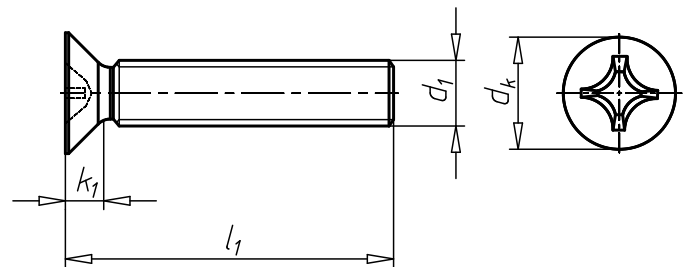
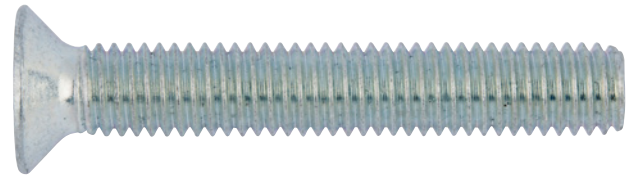

Thread type x nominal diameter (d ₁)	Length (l ₁)	Head diameter (d _k)	Head height (k ₁)	Internal drive	Art. no.	P. Qty.
M1.6	4 mm	3 mm	0.96 mm	H0	0048 16 4	1000
M2	3 mm	3.8 mm	1.2 mm	H1	0048 2 3	2000
M2	4 mm	3.8 mm	1.2 mm	H1	0048 2 4	2000
M2	5 mm	3.8 mm	1.2 mm	H1	0048 2 5	5000
M2	6 mm	3.8 mm	1.2 mm	H1	0048 2 6	2000
M2	8 mm	3.8 mm	1.2 mm	H1	0048 2 8	2000
M2	10 mm	3.8 mm	1.2 mm	H1	0048 2 10	2000
M2	12 mm	3.8 mm	1.2 mm	H1	0048 2 12	4000
M2	16 mm	3.8 mm	1.2 mm	H1	0048 2 16	2000
M2	20 mm	3.8 mm	1.2 mm	H1	0048 2 20	2000
M2.5	4 mm	4.7 mm	1.5 mm	H1	0048 25 4	2000
M2.5	5 mm	4.7 mm	1.5 mm	H1	0048 25 5	500/2000
M2.5	6 mm	4.7 mm	1.5 mm	H1	0048 25 6	500/2000
M2.5	8 mm	4.7 mm	1.5 mm	H1	0048 25 8	500/2000
M2.5	10 mm	4.7 mm	1.5 mm	H1	0048 25 10	1000
M2.5	12 mm	4.7 mm	1.5 mm	H1	0048 25 12	1000 /2000
M2.5	16 mm	4.7 mm	1.5 mm	H1	0048 25 16	1000
M2.5	20 mm	4.7 mm	1.5 mm	H1	0048 25 20	2000
M2.5	30 mm	4.7 mm	1.5 mm	H1	0048 25 30	2000
M3	4 mm	5.6 mm	1.65 mm	H1	0048 3 4	500/2000
M3	5 mm	5.6 mm	1.65 mm	H1	0048 3 5	100/2000
M3	6 mm	5.6 mm	1.65 mm	H1	0048 3 6	500/2000
M3	8 mm	5.6 mm	1.65 mm	H1	0048 3 8	500/1000 /2000
M3	10 mm	5.6 mm	1.65 mm	H1	0048 3 10	500/2000
M3	12 mm	5.6 mm	1.65 mm	H1	0048 3 12	500/2000
M3	14 mm	5.6 mm	1.65 mm	H1	0048 3 14	2000
M3	16 mm	5.6 mm	1.65 mm	H1	0048 3 16	500/2000
M3	18 mm	5.6 mm	1.65 mm	H1	0048 3 18	2000
M3	20 mm	5.6 mm	1.65 mm	H1	0048 3 20	500/2000

Thread type x nominal diameter (d ₁)	Length (l ₁)	Head diameter (d _k)	Head height (k ₁)	Internal drive	Art. no.	P. Qty.
M3	25 mm	5.6 mm	1.65 mm	H1	0048 3 25	500
M3	28 mm	5.6 mm	1.65 mm	H1	0048 3 28	2000
M3	30 mm	5.6 mm	1.65 mm	H1	0048 3 30	500/2000
M3	35 mm	5.6 mm	1.65 mm	H1	0048 3 35	500
M3	40 mm	5.6 mm	1.65 mm	H1	0048 3 40	1000
M3	45 mm	5.6 mm	1.65 mm	H1	0048 3 45	1000
M3	50 mm	5.6 mm	1.65 mm	H1	0048 3 50	100
M3	60 mm	5.6 mm	1.65 mm	H1	0048 3 60	500
M3	85 mm	5.6 mm	1.65 mm	H1	0048 3 85	200
M3.5	5 mm	6.5 mm	1.93 mm	H2	0048 35 5	2000
M3.5	6 mm	6.5 mm	1.93 mm	H2	0048 35 6	2000
M3.5	8 mm	6.5 mm	1.93 mm	H2	0048 35 8	2000
M3.5	10 mm	6.5 mm	1.93 mm	H2	0048 35 10	2000
M3.5	12 mm	6.5 mm	1.93 mm	H2	0048 35 12	2000
M3.5	16 mm	6.5 mm	1.93 mm	H2	0048 35 16	2000
M3.5	20 mm	6.5 mm	1.93 mm	H2	0048 35 20	2000
M4	5 mm	7.5 mm	2.2 mm	H2	0048 4 5	2000
M4	6 mm	7.5 mm	2.2 mm	H2	0048 4 6	100/500 /2000
M4	8 mm	7.5 mm	2.2 mm	H2	0048 4 8	100/500 /2000
M4	10 mm	7.5 mm	2.2 mm	H2	0048 4 10	250/1000 /2000
M4	12 mm	7.5 mm	2.2 mm	H2	0048 4 12	250/1000 /2000
M4	14 mm	7.5 mm	2.2 mm	H2	0048 4 14	2000
M4	15 mm	7.5 mm	2.2 mm	H2	0048 4 15	2000
M4	16 mm	7.5 mm	2.2 mm	H2	0048 4 16	250/1000 /2000
M4	18 mm	7.5 mm	2.2 mm	H2	0048 4 18	250/2000
M4	20 mm	7.5 mm	2.2 mm	H2	0048 4 20	250/1000 /2000
M4	22 mm	7.5 mm	2.2 mm	H2	0048 4 22	1000 /5000
M4	25 mm	7.5 mm	2.2 mm	H2	0048 4 25	100/250 /2000
M4	28 mm	7.5 mm	2.2 mm	H2	0048 4 28	1000
M4	30 mm	7.5 mm	2.2 mm	H2	0048 4 30	100/250 /1000
M4	35 mm	7.5 mm	2.2 mm	H2	0048 4 35	100/250 /1000
M4	40 mm	7.5 mm	2.2 mm	H2	0048 4 40	100/250 /1000
M4	45 mm	7.5 mm	2.2 mm	H2	0048 4 45	100
M4	50 mm	7.5 mm	2.2 mm	H2	0048 4 50	100/250
M4	55 mm	7.5 mm	2.2 mm	H2	0048 4 55	500
M4	60 mm	7.5 mm	2.2 mm	H2	0048 4 60	500
M4	65 mm	7.5 mm	2.2 mm	H2	0048 4 65	500
M4	70 mm	7.5 mm	2.2 mm	H2	0048 4 70	100
M4	80 mm	7.5 mm	2.2 mm	H2	0048 4 80	200
M4	90 mm	7.5 mm	2.2 mm	H2	0048 4 90	100
M4	100 mm	7.5 mm	2.2 mm	H2	0048 4 100	200
M5	6 mm	9.2 mm	2.5 mm	H2	0048 5 6	1000 /2000

Thread type x nominal diameter (d ₁)	Length (l ₁)	Head diameter (d _k)	Head height (k ₁)	Internal drive	Art. no.	P. Qty.
M5	8 mm	9.2 mm	2.5 mm	H2	0048 5 8	250/1000 /2000
M5	10 mm	9.2 mm	2.5 mm	H2	0048 5 10	100/250 /2000
M5	12 mm	9.2 mm	2.5 mm	H2	0048 5 12	250/1000
M5	14 mm	9.2 mm	2.5 mm	H2	0048 5 14	1000
M5	16 mm	9.2 mm	2.5 mm	H2	0048 5 16	250/1000 /2000
M5	18 mm	9.2 mm	2.5 mm	H2	0048 5 18	1000
M5	20 mm	9.2 mm	2.5 mm	H2	0048 5 20	100/250 /1000
M5	22 mm	9.2 mm	2.5 mm	H2	0048 5 22	1000
M5	25 mm	9.2 mm	2.5 mm	H2	0048 5 25	100/1000
M5	28 mm	9.2 mm	2.5 mm	H2	0048 5 28	1000
M5	30 mm	9.2 mm	2.5 mm	H2	0048 5 30	100/500
M5	35 mm	9.2 mm	2.5 mm	H2	0048 5 35	100/500
M5	40 mm	9.2 mm	2.5 mm	H2	0048 5 40	100/500
M5	45 mm	9.2 mm	2.5 mm	H2	0048 5 45	100/500
M5	50 mm	9.2 mm	2.5 mm	H2	0048 5 50	100
M5	55 mm	9.2 mm	2.5 mm	H2	0048 5 55	100/500
M5	60 mm	9.2 mm	2.5 mm	H2	0048 5 60	200
M5	65 mm	9.2 mm	2.5 mm	H2	0048 5 65	200
M5	70 mm	9.2 mm	2.5 mm	H2	0048 5 70	200
M5	75 mm	9.2 mm	2.5 mm	H2	0048 5 75	200
M5	80 mm	9.2 mm	2.5 mm	H2	0048 5 80	200
M5	85 mm	9.2 mm	2.5 mm	H2	0048 5 85	1000
M5	90 mm	9.2 mm	2.5 mm	H2	0048 5 90	200
M5	100 mm	9.2 mm	2.5 mm	H2	0048 5 100	200
M6	8 mm	11 mm	3 mm	H3	0048 6 8	100/1000
M6	10 mm	11 mm	3 mm	H3	0048 6 10	250/1000
M6	12 mm	11 mm	3 mm	H3	0048 6 12	250/1000
M6	14 mm	11 mm	3 mm	H3	0048 6 14	1000
M6	16 mm	11 mm	3 mm	H3	0048 6 16	100/250 /1000
M6	18 mm	11 mm	3 mm	H3	0048 6 18	250
M6	20 mm	11 mm	3 mm	H3	0048 6 20	100/300 /500
M6	22 mm	11 mm	3 mm	H3	0048 6 22	500
M6	25 mm	11 mm	3 mm	H3	0048 6 25	100/300 /500
M6	30 mm	11 mm	3 mm	H3	0048 6 30	100/300 /500
M6	35 mm	11 mm	3 mm	H3	0048 6 35	100/500
M6	40 mm	11 mm	3 mm	H3	0048 6 40	100/500
M6	45 mm	11 mm	3 mm	H3	0048 6 45	100
M6	50 mm	11 mm	3 mm	H3	0048 6 50	100/200
M6	55 mm	11 mm	3 mm	H3	0048 6 55	100
M6	60 mm	11 mm	3 mm	H3	0048 6 60	100/200
M6	65 mm	11 mm	3 mm	H3	0048 6 65	100/200
M6	70 mm	11 mm	3 mm	H3	0048 6 70	100
M6	75 mm	11 mm	3 mm	H3	0048 6 75	200
M6	80 mm	11 mm	3 mm	H3	0048 6 80	100
M6	85 mm	11 mm	3 mm	H3	0048 6 85	500
M6	90 mm	11 mm	3 mm	H3	0048 6 90	100

Thread type x nominal diameter (d ₁)	Length (l ₁)	Head diameter (d _k)	Head height (k ₁)	Internal drive	Art. no.	P. Qty.
M6	95 mm	11 mm	3 mm	H3	0048 6 95	100
M6	100 mm	11 mm	3 mm	H3	0048 6 100	50
M6	105 mm	11 mm	3 mm	H3	0048 6 105	1000
M6	110 mm	11 mm	3 mm	H3	0048 6 110	100
M8	10 mm	14.5 mm	4 mm	H4	0048 8 10	100
M8	12 mm	14.5 mm	4 mm	H4	0048 8 12	100
M8	14 mm	14.5 mm	4 mm	H4	0048 8 14	500
M8	16 mm	14.5 mm	4 mm	H4	0048 8 16	100/500
M8	18 mm	14.5 mm	4 mm	H4	0048 8 18	500
M8	20 mm	14.5 mm	4 mm	H4	0048 8 20	100/500
M8	25 mm	14.5 mm	4 mm	H4	0048 8 25	100
M8	30 mm	14.5 mm	4 mm	H4	0048 8 30	100/500
M8	35 mm	14.5 mm	4 mm	H4	0048 8 35	100/200
M8	37 mm	14.5 mm	4 mm	H4	0048 8 37	1
M8	40 mm	14.5 mm	4 mm	H4	0048 8 40	100/200
M8	45 mm	14.5 mm	4 mm	H4	0048 8 45	100
M8	50 mm	14.5 mm	4 mm	H4	0048 8 50	100
M8	55 mm	14.5 mm	4 mm	H4	0048 8 55	100
M8	60 mm	14.5 mm	4 mm	H4	0048 8 60	50
M8	65 mm	14.5 mm	4 mm	H4	0048 8 65	200
M8	70 mm	14.5 mm	4 mm	H4	0048 8 70	50/100
M8	75 mm	14.5 mm	4 mm	H4	0048 8 75	50
M8	80 mm	14.5 mm	4 mm	H4	0048 8 80	50
M8	90 mm	14.5 mm	4 mm	H4	0048 8 90	50/100
M8	100 mm	14.5 mm	4 mm	H4	0048 8 100	100
M10	16 mm	18 mm	5 mm	H4	0048 10 16	200
M10	20 mm	18 mm	5 mm	H4	0048 10 20	200
M10	25 mm	18 mm	5 mm	H4	0048 10 25	200
M10	30 mm	18 mm	5 mm	H4	0048 10 30	100
M10	35 mm	18 mm	5 mm	H4	0048 10 35	200
M10	40 mm	18 mm	5 mm	H4	0048 10 40	200
M10	45 mm	18 mm	5 mm	H4	0048 10 45	100
M10	50 mm	18 mm	5 mm	H4	0048 10 50	200
M10	60 mm	18 mm	5 mm	H4	0048 10 60	100
M10	70 mm	18 mm	5 mm	H4	0048 10 70	100
M10	80 mm	18 mm	5 mm	H4	0048 10 80	100

Notice

DIN 965 has been withdrawn and replaced by ISO 7046 part 1/part 2. There is some limited similarity (some head heights and head diameters have been changed | Thread lengths changed | nominal Ø M1.6 removed | strength class 5.8 and A4-70 omitted | thread lengths changed | recessed head penetration depths changed).