

Pan head screw with H cross recess

DIN 7985 A2 stainless steel, plain

Standards	DIN 7985
Material	Stainless steel A2
Property class	70
Surface	Plain
RoHS-compliant	Yes

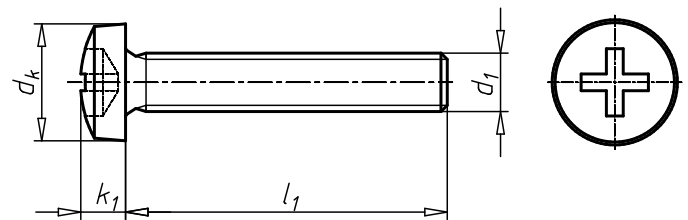
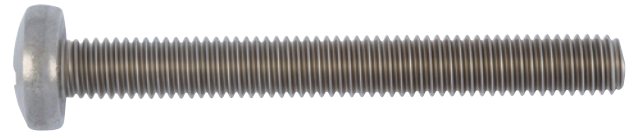

Thread type x nominal diameter (d ₁)	Length (l ₁)	Head diameter (d _k)	Head height (k ₁)	Internal drive	Art. no.	P. Qty.
M1.6	6 mm	3.2 mm	1.3 mm	H0	0283 16 6	1000
M1.6	10 mm	3.2 mm	1.3 mm	H0	0283 16 10	1000
M1.6	12 mm	3.2 mm	1.3 mm	H0	0283 16 12	1000
M1.6	16 mm	3.2 mm	1.3 mm	H0	0283 16 16	1000 /2000
M2	3 mm	4 mm	1.6 mm	H1	0283 2 3	2000
M2	4 mm	4 mm	1.6 mm	H1	0283 2 4	2000
M2	5 mm	4 mm	1.6 mm	H1	0283 2 5	2000
M2	6 mm	4 mm	1.6 mm	H1	0283 2 6	1000 /2000
M2	8 mm	4 mm	1.6 mm	H1	0283 2 8	1000
M2	10 mm	4 mm	1.6 mm	H1	0283 2 10	1000
M2	12 mm	4 mm	1.6 mm	H1	0283 2 12	2000
M2	14 mm	4 mm	1.6 mm	H1	0283 2 14	1000
M2	16 mm	4 mm	1.6 mm	H1	0283 2 16	1000
M2	18 mm	4 mm	1.6 mm	H1	0283 2 18	1000
M2	20 mm	4 mm	1.6 mm	H1	0283 2 20	1000
M2	24 mm	4 mm	1.6 mm	H1	0283 2 24	100
M2.5	3 mm	5 mm	2 mm	H1	0283 25 3	1000
M2.5	4 mm	5 mm	2 mm	H1	0283 25 4	1000
M2.5	5 mm	5 mm	2 mm	H1	0283 25 5	1000
M2.5	6 mm	5 mm	2 mm	H1	0283 25 6	500/1000
M2.5	8 mm	5 mm	2 mm	H1	0283 25 8	500/1000
M2.5	10 mm	5 mm	2 mm	H1	0283 25 10	500/2000
M2.5	12 mm	5 mm	2 mm	H1	0283 25 12	2000
M2.5	14 mm	5 mm	2 mm	H1	0283 25 14	1000
M2.5	16 mm	5 mm	2 mm	H1	0283 25 16	1000
M2.5	18 mm	5 mm	2 mm	H1	0283 25 18	1000
M2.5	20 mm	5 mm	2 mm	H1	0283 25 20	1000
M2.5	22 mm	5 mm	2 mm	H1	0283 25 22	1000
M2.5	25 mm	5 mm	2 mm	H1	0283 25 25	1000
M3	4 mm	6 mm	2.4 mm	H1	0283 3 4	500/1000
M3	5 mm	6 mm	2.4 mm	H1	0283 3 5	500/1000

Thread type x nominal diameter (d ₁)	Length (l ₁)	Head diameter (d _k)	Head height (k ₁)	Internal drive	Art. no.	P. Qty.
M3	6 mm	6 mm	2.4 mm	H1	0283 3 6	500/1000
M3	8 mm	6 mm	2.4 mm	H1	0283 3 8	500/1000 /2000
M3	10 mm	6 mm	2.4 mm	H1	0283 3 10	500/1000 /2000
M3	12 mm	6 mm	2.4 mm	H1	0283 3 12	500/1000
M3	14 mm	6 mm	2.4 mm	H1	0283 3 14	1000
M3	16 mm	6 mm	2.4 mm	H1	0283 3 16	500/1000
M3	18 mm	6 mm	2.4 mm	H1	0283 3 18	1000
M3	20 mm	6 mm	2.4 mm	H1	0283 3 20	500/1000
M3	22 mm	6 mm	2.4 mm	H1	0283 3 22	1000
M3	25 mm	6 mm	2.4 mm	H1	0283 3 25	500/1000
M3	28 mm	6 mm	2.4 mm	H1	0283 3 28	1000
M3	30 mm	6 mm	2.4 mm	H1	0283 3 30	500/1000
M3	35 mm	6 mm	2.4 mm	H1	0283 3 35	1000
M3	40 mm	6 mm	2.4 mm	H1	0283 3 40	1000
M3	45 mm	6 mm	2.4 mm	H1	0283 3 45	1000
M3	50 mm	6 mm	2.4 mm	H1	0283 3 50	1000
M3	60 mm	6 mm	2.4 mm	H1	0283 3 60	500
M3.5	8 mm	7 mm	2.7 mm	H2	0283 35 8	1000
M3.5	20 mm	7 mm	2.7 mm	H2	0283 35 20	1000
M3.5	30 mm	7 mm	2.7 mm	H2	0283 35 30	1000
M4	4 mm	8 mm	3.1 mm	H2	0283 4 4	1000
M4	5 mm	8 mm	3.1 mm	H2	0283 4 5	1000
M4	6 mm	8 mm	3.1 mm	H2	0283 4 6	200/500 /1000
M4	8 mm	8 mm	3.1 mm	H2	0283 4 8	200/500 /1000
M4	10 mm	8 mm	3.1 mm	H2	0283 4 10	200/500 /1000
M4	12 mm	8 mm	3.1 mm	H2	0283 4 12	200/500 /1000
M4	14 mm	8 mm	3.1 mm	H2	0283 4 14	200/1000
M4	16 mm	8 mm	3.1 mm	H2	0283 4 16	200/500 /1000
M4	18 mm	8 mm	3.1 mm	H2	0283 4 18	1000
M4	20 mm	8 mm	3.1 mm	H2	0283 4 20	200/500 /1000
M4	22 mm	8 mm	3.1 mm	H2	0283 4 22	1000
M4	25 mm	8 mm	3.1 mm	H2	0283 4 25	200/500
M4	28 mm	8 mm	3.1 mm	H2	0283 4 28	500
M4	30 mm	8 mm	3.1 mm	H2	0283 4 30	200/500
M4	35 mm	8 mm	3.1 mm	H2	0283 4 35	200/500
M4	40 mm	8 mm	3.1 mm	H2	0283 4 40	500
M4	45 mm	8 mm	3.1 mm	H2	0283 4 45	500
M4	50 mm	8 mm	3.1 mm	H2	0283 4 50	500
M4	60 mm	8 mm	3.1 mm	H2	0283 4 60	500
M4	65 mm	8 mm	3.1 mm	H2	0283 4 65	500
M4	70 mm	8 mm	3.1 mm	H2	0283 4 70	500
M4	75 mm	8 mm	3.1 mm	H2	0283 4 75	100
M4	100 mm	8 mm	3.1 mm	H2	0283 4 100	500
M5	6 mm	10 mm	3.8 mm	H2	0283 5 6	100/500
M5	8 mm	10 mm	3.8 mm	H2	0283 5 8	100/500
M5	10 mm	10 mm	3.8 mm	H2	0283 5 10	100/500

Thread type x nominal diameter (d ₁)	Length (l ₁)	Head diameter (d _k)	Head height (k ₁)	Internal drive	Art. no.	P. Qty.
M5	12 mm	10 mm	3.8 mm	H2	0283 5 12	100/500 /1000
M5	14 mm	10 mm	3.8 mm	H2	0283 5 14	500
M5	16 mm	10 mm	3.8 mm	H2	0283 5 16	100/500 /1000
M5	18 mm	10 mm	3.8 mm	H2	0283 5 18	500
M5	20 mm	10 mm	3.8 mm	H2	0283 5 20	100/500 /1000
M5	22 mm	10 mm	3.8 mm	H2	0283 5 22	1000
M5	25 mm	10 mm	3.8 mm	H2	0283 5 25	100/500
M5	28 mm	10 mm	3.8 mm	H2	0283 5 28	500
M5	30 mm	10 mm	3.8 mm	H2	0283 5 30	100/500
M5	35 mm	10 mm	3.8 mm	H2	0283 5 35	100/500
M5	40 mm	10 mm	3.8 mm	H2	0283 5 40	100/200 /500
M5	45 mm	10 mm	3.8 mm	H2	0283 5 45	200
M5	50 mm	10 mm	3.8 mm	H2	0283 5 50	100/200
M5	55 mm	10 mm	3.8 mm	H2	0283 5 55	100
M5	60 mm	10 mm	3.8 mm	H2	0283 5 60	100/200
M5	70 mm	10 mm	3.8 mm	H2	0283 5 70	200
M5	80 mm	10 mm	3.8 mm	H2	0283 5 80	200
M5	90 mm	10 mm	3.8 mm	H2	0283 5 90	200
M6	8 mm	12 mm	4.6 mm	H3	0283 6 8	100/200
M6	10 mm	12 mm	4.6 mm	H3	0283 6 10	100/200
M6	12 mm	12 mm	4.6 mm	H3	0283 6 12	100/200
M6	14 mm	12 mm	4.6 mm	H3	0283 6 14	200
M6	16 mm	12 mm	4.6 mm	H3	0283 6 16	100
M6	18 mm	12 mm	4.6 mm	H3	0283 6 18	500
M6	20 mm	12 mm	4.6 mm	H3	0283 6 20	100/200
M6	22 mm	12 mm	4.6 mm	H3	0283 6 22	200
M6	25 mm	12 mm	4.6 mm	H3	0283 6 25	100/500
M6	30 mm	12 mm	4.6 mm	H3	0283 6 30	100/200
M6	35 mm	12 mm	4.6 mm	H3	0283 6 35	100
M6	40 mm	12 mm	4.6 mm	H3	0283 6 40	100/200
M6	45 mm	12 mm	4.6 mm	H3	0283 6 45	100
M6	50 mm	12 mm	4.6 mm	H3	0283 6 50	100
M6	60 mm	12 mm	4.6 mm	H3	0283 6 60	100
M6	70 mm	12 mm	4.6 mm	H3	0283 6 70	100/200
M6	80 mm	12 mm	4.6 mm	H3	0283 6 80	100
M8	12 mm	16 mm	6 mm	H4	0283 8 12	100
M8	16 mm	16 mm	6 mm	H4	0283 8 16	100
M8	20 mm	16 mm	6 mm	H4	0283 8 20	100
M8	25 mm	16 mm	6 mm	H4	0283 8 25	100
M8	30 mm	16 mm	6 mm	H4	0283 8 30	100
M8	35 mm	16 mm	6 mm	H4	0283 8 35	100
M8	40 mm	16 mm	6 mm	H4	0283 8 40	100
M8	45 mm	16 mm	6 mm	H4	0283 8 45	100
M8	50 mm	16 mm	6 mm	H4	0283 8 50	100/200
M8	60 mm	16 mm	6 mm	H4	0283 8 60	100
M8	70 mm	16 mm	6 mm	H4	0283 8 70	100
M8	80 mm	16 mm	6 mm	H4	0283 8 80	100
M8	90 mm	16 mm	6 mm	H4	0283 8 90	100
M8	100 mm	16 mm	6 mm	H4	0283 8 100	100

Thread type x nominal diameter (d ₁)	Length (l ₁)	Head diameter (d _k)	Head height (k ₁)	Internal drive	Art. no.	P. Qty.
M10	25 mm	20 mm	7.5 mm	H4	0283 10 25	100
M10	35 mm	20 mm	7.5 mm	H4	0283 10 35	200

Details/Application

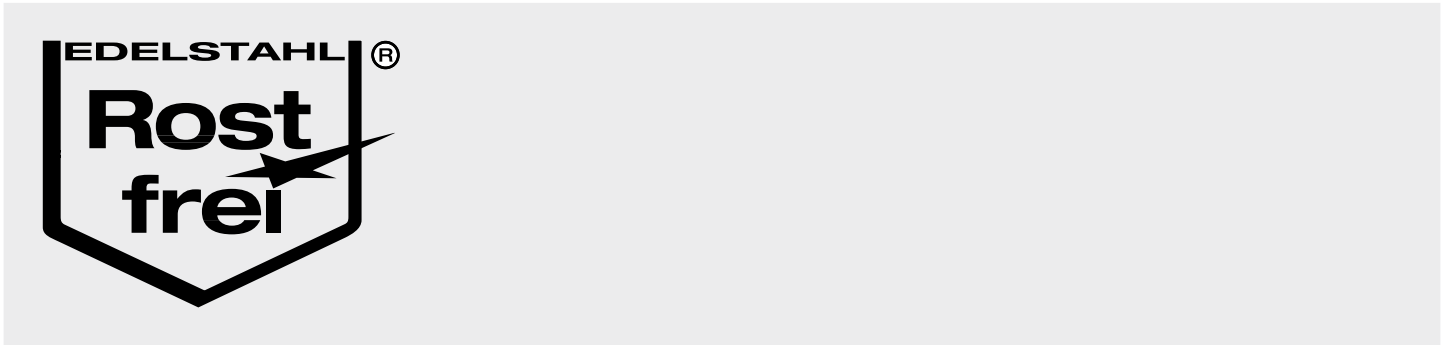

Notice

DIN 7985 has been withdrawn and replaced by ISO 7045. There is some similarity (some head heights and head diameters changed | thread lengths changed | penetration depths of recessed heads changed | standard title of raised countersunk head screw changed to flat head screw).