

Hexagon Socket Head Cap Screw ISO 4762/DIN 912, steel 10.9, plain

Material	Steel
Surface	Plain
Property class	10.9
RoHS-compliant	Yes

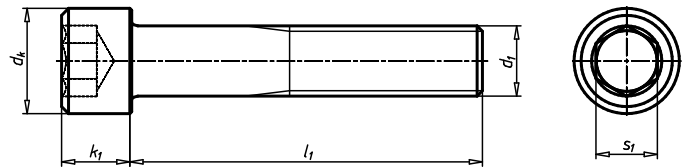

Thread type x nominal diameter (d ₁)	Length (l ₁)	Head diameter (d _k)	Head height (k ₁)	Internal drive (s ₁)	Standards	Art. no.	P. Qty.
M3	6 mm	5.5 mm	3 mm	HS2.5	ISO 4762	0080 3 6	500
M3	8 mm	5.5 mm	3 mm	HS2.5	ISO 4762	0080 3 8	200/1000
M3	10 mm	5.5 mm	3 mm	HS2.5	ISO 4762	0080 3 10	1000
M3	12 mm	5.5 mm	3 mm	HS2.5	ISO 4762	0080 3 12	200/1000
M3	16 mm	5.5 mm	3 mm	HS2.5	ISO 4762	0080 3 16	500
M3	20 mm	5.5 mm	3 mm	HS2.5	ISO 4762	0080 3 20	500
M3	25 mm	5.5 mm	3 mm	HS2.5	ISO 4762	0080 3 25	500
M3	30 mm	5.5 mm	3 mm	HS2.5	ISO 4762	0080 3 30	500
M3	35 mm	5.5 mm	3 mm	HS2.5	ISO 4762	0080 3 35	500
M3	40 mm	5.5 mm	3 mm	HS2.5	ISO 4762	0080 3 40	500
M3	45 mm	5.5 mm	3 mm	HS2.5	ISO 4762	0080 3 45	500
M3	50 mm	5.5 mm	3 mm	HS2.5	ISO 4762	0080 3 50	500
M3	55 mm	5.5 mm	3 mm	HS2.5	ISO 4762	0080 3 55	100
M3	60 mm	5.5 mm	3 mm	HS2.5	ISO 4762	0080 3 60	50
M3	70 mm	5.5 mm	3 mm	HS2.5	ISO 4762	0080 3 70	100
M4	6 mm	7 mm	4 mm	HS3	ISO 4762	0080 4 6	500
M4	8 mm	7 mm	4 mm	HS3	ISO 4762	0080 4 8	200/1000
M4	10 mm	7 mm	4 mm	HS3	ISO 4762	0080 4 10	500
M4	12 mm	7 mm	4 mm	HS3	ISO 4762	0080 4 12	200/500
M4	14 mm	7 mm	4 mm	HS3	ISO 4762	0080 4 14	500
M4	16 mm	7 mm	4 mm	HS3	ISO 4762	0080 4 16	200/1000
M4	18 mm	7 mm	4 mm	HS3	ISO 4762	0080 4 18	500
M4	20 mm	7 mm	4 mm	HS3	ISO 4762	0080 4 20	200/500
M4	22 mm	7 mm	4 mm	HS3	ISO 4762	0080 4 22	500
M4	25 mm	7 mm	4 mm	HS3	ISO 4762	0080 4 25	500
M4	30 mm	7 mm	4 mm	HS3	ISO 4762	0080 4 30	200/500
M4	35 mm	7 mm	4 mm	HS3	ISO 4762	0080 4 35	500
M4	40 mm	7 mm	4 mm	HS3	ISO 4762	0080 4 40	500
M4	45 mm	7 mm	4 mm	HS3	ISO 4762	0080 4 45	500
M4	50 mm	7 mm	4 mm	HS3	ISO 4762	0080 4 50	500
M4	55 mm	7 mm	4 mm	HS3	ISO 4762	0080 4 55	500
M4	60 mm	7 mm	4 mm	HS3	ISO 4762	0080 4 60	200
M4	70 mm	7 mm	4 mm	HS3	ISO 4762	0080 4 70	200
M4	90 mm	7 mm	4 mm	HS3	ISO 4762	0080 4 90	200

Thread type x nominal diameter (d ₁)	Length (l ₁)	Head diameter (d _k)	Head height (k ₁)	Internal drive (s ₁)	Standards	Art. no.	P. Qty.
M4	100 mm	7 mm	4 mm	HS3	ISO 4762	0080 4 100	200
M5	6 mm	8.5 mm	5 mm	HS4	ISO 4762	0080 5 6	500
M5	8 mm	8.5 mm	5 mm	HS4	ISO 4762	0080 5 8	500
M5	10 mm	8.5 mm	5 mm	HS4	ISO 4762	0080 5 10	200/500
M5	12 mm	8.5 mm	5 mm	HS4	ISO 4762	0080 5 12	200/500
M5	14 mm	8.5 mm	5 mm	HS4	ISO 4762	0080 5 14	500
M5	15 mm	8.5 mm	5 mm	HS4	ISO 4762	0080 5 15	50
M5	16 mm	8.5 mm	5 mm	HS4	ISO 4762	0080 5 16	200/500
M5	18 mm	8.5 mm	5 mm	HS4	ISO 4762	0080 5 18	500
M5	20 mm	8.5 mm	5 mm	HS4	ISO 4762	0080 5 20	200/500
M5	22 mm	8.5 mm	5 mm	HS4	ISO 4762	0080 5 22	500
M5	25 mm	8.5 mm	5 mm	HS4	ISO 4762	0080 5 25	200/500
M5	30 mm	8.5 mm	5 mm	HS4	ISO 4762	0080 5 30	200/500
M5	35 mm	8.5 mm	5 mm	HS4	ISO 4762	0080 5 35	400
M5	40 mm	8.5 mm	5 mm	HS4	ISO 4762	0080 5 40	200/500
M5	45 mm	8.5 mm	5 mm	HS4	ISO 4762	0080 5 45	200
M5	50 mm	8.5 mm	5 mm	HS4	ISO 4762	0080 5 50	200
M5	55 mm	8.5 mm	5 mm	HS4	ISO 4762	0080 5 55	200
M5	60 mm	8.5 mm	5 mm	HS4	ISO 4762	0080 5 60	200
M5	65 mm	8.5 mm	5 mm	HS4	ISO 4762	0080 5 65	200
M5	70 mm	8.5 mm	5 mm	HS4	ISO 4762	0080 5 70	100/200
M5	75 mm	8.5 mm	5 mm	HS4	ISO 4762	0080 5 75	200
M5	80 mm	8.5 mm	5 mm	HS4	ISO 4762	0080 5 80	200
M5	85 mm	8.5 mm	5 mm	HS4	ISO 4762	0080 5 85	200
M5	90 mm	8.5 mm	5 mm	HS4	ISO 4762	0080 5 90	200
M5	95 mm	8.5 mm	5 mm	HS4	ISO 4762	0080 5 95	100
M5	100 mm	8.5 mm	5 mm	HS4	ISO 4762	0080 5 100	200
M5	105 mm	8.5 mm	5 mm	HS4	ISO 4762	0080 5 105	100
M5	110 mm	8.5 mm	5 mm	HS4	ISO 4762	0080 5 110	100
M5	115 mm	8.5 mm	5 mm	HS4	ISO 4762	0080 5 115	100
M5	120 mm	8.5 mm	5 mm	HS4	ISO 4762	0080 5 120	100
M5	125 mm	8.5 mm	5 mm	HS4	ISO 4762	0080 5 125	200
M5	130 mm	8.5 mm	5 mm	HS4	ISO 4762	0080 5 130	200
M5	135 mm	8.5 mm	5 mm	HS4	ISO 4762	0080 5 135	25
M5	140 mm	8.5 mm	5 mm	HS4	ISO 4762	0080 5 140	100
M5	145 mm	8.5 mm	5 mm	HS4	ISO 4762	0080 5 145	100
M5	150 mm	8.5 mm	5 mm	HS4	ISO 4762	0080 5 150	200
M5	160 mm	8.5 mm	5 mm	HS4	ISO 4762	0080 5 160	200
M5	165 mm	8.5 mm	5 mm	HS4	ISO 4762	0080 5 165	50
M5	175 mm	8.5 mm	5 mm	HS4	ISO 4762	0080 5 175	100
M5	180 mm	8.5 mm	5 mm	HS4	ISO 4762	0080 5 180	100
M5	185 mm	8.5 mm	5 mm	HS4	ISO 4762	0080 5 185	100
M5	190 mm	8.5 mm	5 mm	HS4	ISO 4762	0080 5 190	100
M5	195 mm	8.5 mm	5 mm	HS4	ISO 4762	0080 5 195	100
M5	200 mm	8.5 mm	5 mm	HS4	ISO 4762	0080 5 200	200
M5	210 mm	8.5 mm	5 mm	HS4	ISO 4762	0080 5 210	50
M5	220 mm	8.5 mm	5 mm	HS4	ISO 4762	0080 5 220	50
M5	250 mm	8.5 mm	5 mm	HS4	ISO 4762	0080 5 250	100
M5	260 mm	8.5 mm	5 mm	HS4	ISO 4762	0080 5 260	25
M6	8 mm	10 mm	6 mm	HS5	ISO 4762	0080 6 8	500
M6	10 mm	10 mm	6 mm	HS5	ISO 4762	0080 6 10	200/500
M6	12 mm	10 mm	6 mm	HS5	ISO 4762	0080 6 12	200/500
M6	14 mm	10 mm	6 mm	HS5	ISO 4762	0080 6 14	500

Thread type x nominal diameter (d ₁)	Length (l ₁)	Head diameter (d _k)	Head height (k ₁)	Internal drive (s ₁)	Standards	Art. no.	P. Qty.
M6	16 mm	10 mm	6 mm	HS5	ISO 4762	0080 6 16	200/500
M6	18 mm	10 mm	6 mm	HS5	ISO 4762	0080 6 18	500
M6	20 mm	10 mm	6 mm	HS5	ISO 4762	0080 6 20	200/500
M6	22 mm	10 mm	6 mm	HS5	ISO 4762	0080 6 22	500
M6	25 mm	10 mm	6 mm	HS5	ISO 4762	0080 6 25	200/500
M6	30 mm	10 mm	6 mm	HS5	ISO 4762	0080 6 30	200/500
M6	35 mm	10 mm	6 mm	HS5	ISO 4762	0080 6 35	200/500
M6	40 mm	10 mm	6 mm	HS5	ISO 4762	0080 6 40	200
M6	45 mm	10 mm	6 mm	HS5	ISO 4762	0080 6 45	200
M6	50 mm	10 mm	6 mm	HS5	ISO 4762	0080 6 50	200
M6	55 mm	10 mm	6 mm	HS5	ISO 4762	0080 6 55	200
M6	60 mm	10 mm	6 mm	HS5	ISO 4762	0080 6 60	200
M6	65 mm	10 mm	6 mm	HS5	ISO 4762	0080 6 65	200
M6	70 mm	10 mm	6 mm	HS5	ISO 4762	0080 6 70	200
M6	75 mm	10 mm	6 mm	HS5	ISO 4762	0080 6 75	200
M6	80 mm	10 mm	6 mm	HS5	ISO 4762	0080 6 80	200
M6	85 mm	10 mm	6 mm	HS5	ISO 4762	0080 6 85	100
M6	90 mm	10 mm	6 mm	HS5	ISO 4762	0080 6 90	100
M6	95 mm	10 mm	6 mm	HS5	ISO 4762	0080 6 95	100
M6	100 mm	10 mm	6 mm	HS5	ISO 4762	0080 6 100	100
M6	110 mm	10 mm	6 mm	HS5	ISO 4762	0080 6 110	100
M6	120 mm	10 mm	6 mm	HS5	ISO 4762	0080 6 120	200
M6	125 mm	10 mm	6 mm	HS5	ISO 4762	0080 6 125	100
M6	130 mm	10 mm	6 mm	HS5	ISO 4762	0080 6 130	100
M6	135 mm	10 mm	6 mm	HS5	ISO 4762	0080 6 135	100
M6	140 mm	10 mm	6 mm	HS5	ISO 4762	0080 6 140	100
M6	145 mm	10 mm	6 mm	HS5	ISO 4762	0080 6 145	100
M6	150 mm	10 mm	6 mm	HS5	ISO 4762	0080 6 150	100
M6	155 mm	10 mm	6 mm	HS5	ISO 4762	0080 6 155	50
M6	160 mm	10 mm	6 mm	HS5	ISO 4762	0080 6 160	100
M6	165 mm	10 mm	6 mm	HS5	ISO 4762	0080 6 165	100
M6	170 mm	10 mm	6 mm	HS5	ISO 4762	0080 6 170	100
M6	175 mm	10 mm	6 mm	HS5	ISO 4762	0080 6 175	10
M6	185 mm	10 mm	6 mm	HS5	ISO 4762	0080 6 185	100
M6	190 mm	10 mm	6 mm	HS5	ISO 4762	0080 6 190	100
M6	195 mm	10 mm	6 mm	HS5	ISO 4762	0080 6 195	50
M6	200 mm	10 mm	6 mm	HS5	ISO 4762	0080 6 200	100
M6	210 mm	10 mm	6 mm	HS5	ISO 4762	0080 6 210	100
M6	220 mm	10 mm	6 mm	HS5	ISO 4762	0080 6 220	100
M6	230 mm	10 mm	6 mm	HS5	ISO 4762	0080 6 230	25
M6	240 mm	10 mm	6 mm	HS5	ISO 4762	0080 6 240	50
M6	250 mm	10 mm	6 mm	HS5	ISO 4762	0080 6 250	5
M6	270 mm	10 mm	6 mm	HS5	ISO 4762	0080 6 270	25
M6	290 mm	10 mm	6 mm	HS5	ISO 4762	0080 6 290	10
M8	10 mm	13 mm	8 mm	HS6	ISO 4762	0080 8 10	200
M8	12 mm	13 mm	8 mm	HS6	ISO 4762	0080 8 12	200
M8	16 mm	13 mm	8 mm	HS6	ISO 4762	0080 8 16	200
M8	18 mm	13 mm	8 mm	HS6	ISO 4762	0080 8 18	200
M8	20 mm	13 mm	8 mm	HS6	ISO 4762	0080 8 20	200
M8	22 mm	13 mm	8 mm	HS6	ISO 4762	0080 8 22	200
M8	25 mm	13 mm	8 mm	HS6	ISO 4762	0080 8 25	200
M8	30 mm	13 mm	8 mm	HS6	ISO 4762	0080 8 30	200
M8	35 mm	13 mm	8 mm	HS6	ISO 4762	0080 8 35	200

Thread type x nominal diameter (d ₁)	Length (l ₁)	Head diameter (d _k)	Head height (k ₁)	Internal drive (s ₁)	Standards	Art. no.	P. Qty.
M8	40 mm	13 mm	8 mm	HS6	ISO 4762	0080 8 40	200
M8	45 mm	13 mm	8 mm	HS6	ISO 4762	0080 8 45	200
M8	50 mm	13 mm	8 mm	HS6	ISO 4762	0080 8 50	200
M8	55 mm	13 mm	8 mm	HS6	ISO 4762	0080 8 55	200
M8	60 mm	13 mm	8 mm	HS6	ISO 4762	0080 8 60	200
M8	65 mm	13 mm	8 mm	HS6	ISO 4762	0080 8 65	200
M8	70 mm	13 mm	8 mm	HS6	ISO 4762	0080 8 70	200
M8	75 mm	13 mm	8 mm	HS6	ISO 4762	0080 8 75	100
M8	80 mm	13 mm	8 mm	HS6	ISO 4762	0080 8 80	100/200
M8	85 mm	13 mm	8 mm	HS6	ISO 4762	0080 8 85	100
M8	90 mm	13 mm	8 mm	HS6	ISO 4762	0080 8 90	100
M8	95 mm	13 mm	8 mm	HS6	ISO 4762	0080 8 95	100
M8	100 mm	13 mm	8 mm	HS6	ISO 4762	0080 8 100	100
M8	105 mm	13 mm	8 mm	HS6	ISO 4762	0080 8 105	100
M8	110 mm	13 mm	8 mm	HS6	ISO 4762	0080 8 110	100
M8	115 mm	13 mm	8 mm	HS6	ISO 4762	0080 8 115	100
M8	120 mm	13 mm	8 mm	HS6	ISO 4762	0080 8 120	100
M8	125 mm	13 mm	8 mm	HS6	ISO 4762	0080 8 125	100
M8	130 mm	13 mm	8 mm	HS6	ISO 4762	0080 8 130	100
M8	140 mm	13 mm	8 mm	HS6	ISO 4762	0080 8 140	100
M8	145 mm	13 mm	8 mm	HS6	ISO 4762	0080 8 145	100
M8	150 mm	13 mm	8 mm	HS6	ISO 4762	0080 8 150	100
M8	155 mm	13 mm	8 mm	HS6	ISO 4762	0080 8 155	50
M8	160 mm	13 mm	8 mm	HS6	ISO 4762	0080 8 160	50/100
M8	170 mm	13 mm	8 mm	HS6	ISO 4762	0080 8 170	50
M8	180 mm	13 mm	8 mm	HS6	ISO 4762	0080 8 180	50
M8	190 mm	13 mm	8 mm	HS6	ISO 4762	0080 8 190	50
M8	200 mm	13 mm	8 mm	HS6	ISO 4762	0080 8 200	25/100
M8	220 mm	13 mm	8 mm	HS6	ISO 4762	0080 8 220	50
M8	230 mm	13 mm	8 mm	HS6	ISO 4762	0080 8 230	50
M8	300 mm	13 mm	8 mm	HS6	ISO 4762	0080 8 300	25
M8	310 mm	13 mm	8 mm	HS6	ISO 4762	0080 8 310	50
M8	320 mm	13 mm	8 mm	HS6	ISO 4762	0080 8 320	50
M10	10 mm	16 mm	10 mm	HS8	ISO 4762	0080 10 10	200
M10	12 mm	16 mm	10 mm	HS8	ISO 4762	0080 10 12	200
M10	16 mm	16 mm	10 mm	HS8	ISO 4762	0080 10 16	200
M10	18 mm	16 mm	10 mm	HS8	ISO 4762	0080 10 18	200
M10	20 mm	16 mm	10 mm	HS8	ISO 4762	0080 10 20	200
M10	22 mm	16 mm	10 mm	HS8	ISO 4762	0080 10 22	100
M10	25 mm	16 mm	10 mm	HS8	ISO 4762	0080 10 25	200
M10	30 mm	16 mm	10 mm	HS8	ISO 4762	0080 10 30	200
M10	35 mm	16 mm	10 mm	HS8	ISO 4762	0080 10 35	100
M10	40 mm	16 mm	10 mm	HS8	ISO 4762	0080 10 40	100
M10	45 mm	16 mm	10 mm	HS8	ISO 4762	0080 10 45	100
M10	50 mm	16 mm	10 mm	HS8	ISO 4762	0080 10 50	100
M10	55 mm	16 mm	10 mm	HS8	ISO 4762	0080 10 55	100
M10	60 mm	16 mm	10 mm	HS8	ISO 4762	0080 10 60	100
M10	65 mm	16 mm	10 mm	HS8	ISO 4762	0080 10 65	50
M10	70 mm	16 mm	10 mm	HS8	ISO 4762	0080 10 70	100
M10	75 mm	16 mm	10 mm	HS8	ISO 4762	0080 10 75	100
M10	80 mm	16 mm	10 mm	HS8	ISO 4762	0080 10 80	100
M10	85 mm	16 mm	10 mm	HS8	ISO 4762	0080 10 85	100
M10	90 mm	16 mm	10 mm	HS8	ISO 4762	0080 10 90	100

Thread type x nominal diameter (d ₁)	Length (l ₁)	Head diameter (d _k)	Head height (k ₁)	Internal drive (s ₁)	Standards	Art. no.	P. Qty.
M10	95 mm	16 mm	10 mm	HS8	ISO 4762	0080 10 95	100
M10	100 mm	16 mm	10 mm	HS8	ISO 4762	0080 10 100	50/100
M10	105 mm	16 mm	10 mm	HS8	ISO 4762	0080 10 105	50
M10	110 mm	16 mm	10 mm	HS8	ISO 4762	0080 10 110	50
M10	115 mm	16 mm	10 mm	HS8	ISO 4762	0080 10 115	50
M10	120 mm	16 mm	10 mm	HS8	ISO 4762	0080 10 120	50
M10	125 mm	16 mm	10 mm	HS8	ISO 4762	0080 10 125	50
M10	130 mm	16 mm	10 mm	HS8	ISO 4762	0080 10 130	50
M10	140 mm	16 mm	10 mm	HS8	ISO 4762	0080 10 140	25/50
M10	145 mm	16 mm	10 mm	HS8	ISO 4762	0080 10 145	50
M10	150 mm	16 mm	10 mm	HS8	ISO 4762	0080 10 150	25
M10	155 mm	16 mm	10 mm	HS8	ISO 4762	0080 10 155	100
M10	160 mm	16 mm	10 mm	HS8	ISO 4762	0080 10 160	25/50
M10	170 mm	16 mm	10 mm	HS8	ISO 4762	0080 10 170	50
M10	180 mm	16 mm	10 mm	HS8	ISO 4762	0080 10 180	25/50
M10	185 mm	16 mm	10 mm	HS8	ISO 4762	0080 10 185	50
M10	190 mm	16 mm	10 mm	HS8	ISO 4762	0080 10 190	50
M10	195 mm	16 mm	10 mm	HS8	ISO 4762	0080 10 195	25
M10	200 mm	16 mm	10 mm	HS8	ISO 4762	0080 10 200	25
M10	210 mm	16 mm	10 mm	HS8	ISO 4762	0080 10 210	25
M10	220 mm	16 mm	10 mm	HS8	ISO 4762	0080 10 220	25
M10	230 mm	16 mm	10 mm	HS8	ISO 4762	0080 10 230	25
M10	240 mm	16 mm	10 mm	HS8	ISO 4762	0080 10 240	25
M10	250 mm	16 mm	10 mm	HS8	ISO 4762	0080 10 250	50
M10	260 mm	16 mm	10 mm	HS8	ISO 4762	0080 10 260	50
M10	270 mm	16 mm	10 mm	HS8	ISO 4762	0080 10 270	25
M10	280 mm	16 mm	10 mm	HS8	ISO 4762	0080 10 280	25
M10	290 mm	16 mm	10 mm	HS8	ISO 4762	0080 10 290	25
M10	300 mm	16 mm	10 mm	HS8	ISO 4762	0080 10 300	25
M10	310 mm	16 mm	10 mm	HS8	ISO 4762	0080 10 310	50
M12	10 mm	18 mm	12 mm	HS10	ISO 4762	0080 12 10	100
M12	16 mm	18 mm	12 mm	HS10	ISO 4762	0080 12 16	100
M12	20 mm	18 mm	12 mm	HS10	ISO 4762	0080 12 20	100
M12	25 mm	18 mm	12 mm	HS10	ISO 4762	0080 12 25	100
M12	30 mm	18 mm	12 mm	HS10	ISO 4762	0080 12 30	100
M12	35 mm	18 mm	12 mm	HS10	ISO 4762	0080 12 35	100
M12	40 mm	18 mm	12 mm	HS10	ISO 4762	0080 12 40	100
M12	45 mm	18 mm	12 mm	HS10	ISO 4762	0080 12 45	100
M12	50 mm	18 mm	12 mm	HS10	ISO 4762	0080 12 50	100
M12	55 mm	18 mm	12 mm	HS10	ISO 4762	0080 12 55	100
M12	60 mm	18 mm	12 mm	HS10	ISO 4762	0080 12 60	100
M12	65 mm	18 mm	12 mm	HS10	ISO 4762	0080 12 65	50
M12	70 mm	18 mm	12 mm	HS10	ISO 4762	0080 12 70	50
M12	75 mm	18 mm	12 mm	HS10	ISO 4762	0080 12 75	50
M12	80 mm	18 mm	12 mm	HS10	ISO 4762	0080 12 80	50
M12	85 mm	18 mm	12 mm	HS10	ISO 4762	0080 12 85	50
M12	90 mm	18 mm	12 mm	HS10	ISO 4762	0080 12 90	50
M12	95 mm	18 mm	12 mm	HS10	ISO 4762	0080 12 95	50
M12	100 mm	18 mm	12 mm	HS10	ISO 4762	0080 12 100	50
M12	110 mm	18 mm	12 mm	HS10	ISO 4762	0080 12 110	50
M12	115 mm	18 mm	12 mm	HS10	ISO 4762	0080 12 115	50
M12	120 mm	18 mm	12 mm	HS10	ISO 4762	0080 12 120	50
M12	125 mm	18 mm	12 mm	HS10	ISO 4762	0080 12 125	50

Thread type x nominal diameter (d ₁)	Length (l ₁)	Head diameter (d _k)	Head height (k ₁)	Internal drive (s ₁)	Standards	Art. no.	P. Qty.
M12	130 mm	18 mm	12 mm	HS10	ISO 4762	0080 12 130	50
M12	135 mm	18 mm	12 mm	HS10	ISO 4762	0080 12 135	50
M12	140 mm	18 mm	12 mm	HS10	ISO 4762	0080 12 140	25/50
M12	145 mm	18 mm	12 mm	HS10	ISO 4762	0080 12 145	50
M12	150 mm	18 mm	12 mm	HS10	ISO 4762	0080 12 150	25
M12	160 mm	18 mm	12 mm	HS10	ISO 4762	0080 12 160	25
M12	170 mm	18 mm	12 mm	HS10	ISO 4762	0080 12 170	25
M12	175 mm	18 mm	12 mm	HS10	ISO 4762	0080 12 175	1
M12	180 mm	18 mm	12 mm	HS10	ISO 4762	0080 12 180	25/50
M12	190 mm	18 mm	12 mm	HS10	ISO 4762	0080 12 190	50
M12	200 mm	18 mm	12 mm	HS10	ISO 4762	0080 12 200	25
M12	210 mm	18 mm	12 mm	HS10	ISO 4762	0080 12 210	25
M12	220 mm	18 mm	12 mm	HS10	ISO 4762	0080 12 220	25
M12	230 mm	18 mm	12 mm	HS10	ISO 4762	0080 12 230	25
M12	240 mm	18 mm	12 mm	HS10	ISO 4762	0080 12 240	25
M12	250 mm	18 mm	12 mm	HS10	ISO 4762	0080 12 250	25
M12	260 mm	18 mm	12 mm	HS10	ISO 4762	0080 12 260	25
M12	270 mm	18 mm	12 mm	HS10	ISO 4762	0080 12 270	25
M12	280 mm	18 mm	12 mm	HS10	ISO 4762	0080 12 280	25
M12	290 mm	18 mm	12 mm	HS10	ISO 4762	0080 12 290	50
M12	300 mm	18 mm	12 mm	HS10	ISO 4762	0080 12 300	25
M12	320 mm	18 mm	12 mm	HS10	ISO 4762	0080 12 320	50
M12	340 mm	18 mm	12 mm	HS10	ISO 4762	0080 12 340	10
M12	380 mm	18 mm	12 mm	HS10	ISO 4762	0080 12 380	10
M14	20 mm	21 mm	14 mm	HS12	ISO 4762	0080 14 20	100
M14	22 mm	21 mm	14 mm	HS12	ISO 4762	0080 14 22	100
M14	25 mm	21 mm	14 mm	HS12	ISO 4762	0080 14 25	100
M14	30 mm	21 mm	14 mm	HS12	ISO 4762	0080 14 30	100
M14	35 mm	21 mm	14 mm	HS12	ISO 4762	0080 14 35	100
M14	40 mm	21 mm	14 mm	HS12	ISO 4762	0080 14 40	100
M14	45 mm	21 mm	14 mm	HS12	ISO 4762	0080 14 45	50
M14	50 mm	21 mm	14 mm	HS12	ISO 4762	0080 14 50	50
M14	55 mm	21 mm	14 mm	HS12	ISO 4762	0080 14 55	50
M14	60 mm	21 mm	14 mm	HS12	ISO 4762	0080 14 60	50
M14	65 mm	21 mm	14 mm	HS12	ISO 4762	0080 14 65	50
M14	70 mm	21 mm	14 mm	HS12	ISO 4762	0080 14 70	50
M14	75 mm	21 mm	14 mm	HS12	ISO 4762	0080 14 75	25
M14	80 mm	21 mm	14 mm	HS12	ISO 4762	0080 14 80	50
M14	85 mm	21 mm	14 mm	HS12	ISO 4762	0080 14 85	50
M14	90 mm	21 mm	14 mm	HS12	ISO 4762	0080 14 90	50
M14	95 mm	21 mm	14 mm	HS12	ISO 4762	0080 14 95	50
M14	100 mm	21 mm	14 mm	HS12	ISO 4762	0080 14 100	50
M14	105 mm	21 mm	14 mm	HS12	ISO 4762	0080 14 105	50
M14	110 mm	21 mm	14 mm	HS12	ISO 4762	0080 14 110	50
M14	120 mm	21 mm	14 mm	HS12	ISO 4762	0080 14 120	50
M14	125 mm	21 mm	14 mm	HS12	ISO 4762	0080 14 125	50
M14	130 mm	21 mm	14 mm	HS12	ISO 4762	0080 14 130	25
M14	135 mm	21 mm	14 mm	HS12	ISO 4762	0080 14 135	50
M14	140 mm	21 mm	14 mm	HS12	ISO 4762	0080 14 140	25
M14	145 mm	21 mm	14 mm	HS12	ISO 4762	0080 14 145	25
M14	150 mm	21 mm	14 mm	HS12	ISO 4762	0080 14 150	25
M14	160 mm	21 mm	14 mm	HS12	ISO 4762	0080 14 160	25
M14	170 mm	21 mm	14 mm	HS12	ISO 4762	0080 14 170	25

Cl01_3511140104, Rev: 0.279, State: 01.06.2023

Thread type x nominal diameter (d ₁)	Length (l ₁)	Head diameter (d _k)	Head height (k ₁)	Internal drive (s ₁)	Standards	Art. no.	P. Qty.
M14	175 mm	21 mm	14 mm	HS12	ISO 4762	0080 14 175	25
M14	180 mm	21 mm	14 mm	HS12	ISO 4762	0080 14 180	50
M14	200 mm	21 mm	14 mm	HS12	ISO 4762	0080 14 200	25
M16	20 mm	24 mm	16 mm	HS14	ISO 4762	0080 16 20	50
M16	25 mm	24 mm	16 mm	HS14	ISO 4762	0080 16 25	50
M16	30 mm	24 mm	16 mm	HS14	ISO 4762	0080 16 30	50
M16	35 mm	24 mm	16 mm	HS14	ISO 4762	0080 16 35	50
M16	40 mm	24 mm	16 mm	HS14	ISO 4762	0080 16 40	50
M16	45 mm	24 mm	16 mm	HS14	ISO 4762	0080 16 45	50
M16	50 mm	24 mm	16 mm	HS14	ISO 4762	0080 16 50	50
M16	55 mm	24 mm	16 mm	HS14	ISO 4762	0080 16 55	50
M16	60 mm	24 mm	16 mm	HS14	ISO 4762	0080 16 60	50
M16	65 mm	24 mm	16 mm	HS14	ISO 4762	0080 16 65	25
M16	70 mm	24 mm	16 mm	HS14	ISO 4762	0080 16 70	25
M16	75 mm	24 mm	16 mm	HS14	ISO 4762	0080 16 75	25
M16	80 mm	24 mm	16 mm	HS14	ISO 4762	0080 16 80	25
M16	85 mm	24 mm	16 mm	HS14	ISO 4762	0080 16 85	50
M16	90 mm	24 mm	16 mm	HS14	ISO 4762	0080 16 90	25
M16	95 mm	24 mm	16 mm	HS14	ISO 4762	0080 16 95	25
M16	100 mm	24 mm	16 mm	HS14	ISO 4762	0080 16 100	25
M16	105 mm	24 mm	16 mm	HS14	ISO 4762	0080 16 105	25
M16	110 mm	24 mm	16 mm	HS14	ISO 4762	0080 16 110	25
M16	120 mm	24 mm	16 mm	HS14	ISO 4762	0080 16 120	25
M16	130 mm	24 mm	16 mm	HS14	ISO 4762	0080 16 130	25
M16	140 mm	24 mm	16 mm	HS14	ISO 4762	0080 16 140	25
M16	145 mm	24 mm	16 mm	HS14	ISO 4762	0080 16 145	10
M16	150 mm	24 mm	16 mm	HS14	ISO 4762	0080 16 150	25
M16	160 mm	24 mm	16 mm	HS14	ISO 4762	0080 16 160	25
M16	170 mm	24 mm	16 mm	HS14	ISO 4762	0080 16 170	25
M16	180 mm	24 mm	16 mm	HS14	ISO 4762	0080 16 180	25
M16	190 mm	24 mm	16 mm	HS14	ISO 4762	0080 16 190	25
M16	200 mm	24 mm	16 mm	HS14	ISO 4762	0080 16 200	25
M16	210 mm	24 mm	16 mm	HS14	ISO 4762	0080 16 210	25
M16	220 mm	24 mm	16 mm	HS14	ISO 4762	0080 16 220	25
M16	230 mm	24 mm	16 mm	HS14	ISO 4762	0080 16 230	25
M16	240 mm	24 mm	16 mm	HS14	ISO 4762	0080 16 240	25
M16	250 mm	24 mm	16 mm	HS14	ISO 4762	0080 16 250	25
M16	260 mm	24 mm	16 mm	HS14	ISO 4762	0080 16 260	25
M16	270 mm	24 mm	16 mm	HS14	ISO 4762	0080 16 270	25
M16	280 mm	24 mm	16 mm	HS14	ISO 4762	0080 16 280	25
M16	300 mm	24 mm	16 mm	HS14	ISO 4762	0080 16 300	25
M16	310 mm	24 mm	16 mm	HS14	ISO 4762	0080 16 310	10
M16	320 mm	24 mm	16 mm	HS14	ISO 4762	0080 16 320	10
M16	340 mm	24 mm	16 mm	HS14	ISO 4762	0080 16 340	10
M16	360 mm	24 mm	16 mm	HS14	ISO 4762	0080 16 360	1
M16	390 mm	24 mm	16 mm	HS14	ISO 4762	0080 16 390	10
M16	400 mm	24 mm	16 mm	HS14	ISO 4762	0080 16 400	10
M16	440 mm	24 mm	16 mm	HS14	ISO 4762	0080 16 440	1
M16	520 mm	24 mm	16 mm	HS14	ISO 4762	0080 16 520	10
M18	30 mm	27 mm	18 mm	HS14	DIN 912	0080 18 30	50
M18	35 mm	27 mm	18 mm	HS14	DIN 912	0080 18 35	50
M18	40 mm	27 mm	18 mm	HS14	DIN 912	0080 18 40	50
M18	45 mm	27 mm	18 mm	HS14	DIN 912	0080 18 45	50

Thread type x nominal diameter (d ₁)	Length (l ₁)	Head diameter (d _k)	Head height (k ₁)	Internal drive (s ₁)	Standards	Art. no.	P. Qty.
M18	50 mm	27 mm	18 mm	HS14	DIN 912	0080 18 50	25
M18	55 mm	27 mm	18 mm	HS14	DIN 912	0080 18 55	50
M18	60 mm	27 mm	18 mm	HS14	DIN 912	0080 18 60	25
M18	65 mm	27 mm	18 mm	HS14	DIN 912	0080 18 65	50
M18	70 mm	27 mm	18 mm	HS14	DIN 912	0080 18 70	25
M18	75 mm	27 mm	18 mm	HS14	DIN 912	0080 18 75	100
M18	80 mm	27 mm	18 mm	HS14	DIN 912	0080 18 80	25
M18	90 mm	27 mm	18 mm	HS14	DIN 912	0080 18 90	25
M18	100 mm	27 mm	18 mm	HS14	DIN 912	0080 18 100	25
M18	110 mm	27 mm	18 mm	HS14	DIN 912	0080 18 110	25
M18	120 mm	27 mm	18 mm	HS14	DIN 912	0080 18 120	25
M18	130 mm	27 mm	18 mm	HS14	DIN 912	0080 18 130	25
M18	140 mm	27 mm	18 mm	HS14	DIN 912	0080 18 140	25
M18	150 mm	27 mm	18 mm	HS14	DIN 912	0080 18 150	25
M18	160 mm	27 mm	18 mm	HS14	DIN 912	0080 18 160	30
M18	180 mm	27 mm	18 mm	HS14	DIN 912	0080 18 180	25
M18	200 mm	27 mm	18 mm	HS14	DIN 912	0080 18 200	25
M18	220 mm	27 mm	18 mm	HS14	DIN 912	0080 18 220	25
M18	240 mm	27 mm	18 mm	HS14	DIN 912	0080 18 240	25
M18	260 mm	27 mm	18 mm	HS14	DIN 912	0080 18 260	25
M18	280 mm	27 mm	18 mm	HS14	DIN 912	0080 18 280	25
M18	300 mm	27 mm	18 mm	HS14	DIN 912	0080 18 300	25
M20	25 mm	30 mm	20 mm	HS17	ISO 4762	0080 20 25	25
M20	30 mm	30 mm	20 mm	HS17	ISO 4762	0080 20 30	25
M20	35 mm	30 mm	20 mm	HS17	ISO 4762	0080 20 35	25
M20	40 mm	30 mm	20 mm	HS17	ISO 4762	0080 20 40	25
M20	45 mm	30 mm	20 mm	HS17	ISO 4762	0080 20 45	25
M20	50 mm	30 mm	20 mm	HS17	ISO 4762	0080 20 50	25
M20	55 mm	30 mm	20 mm	HS17	ISO 4762	0080 20 55	25
M20	60 mm	30 mm	20 mm	HS17	ISO 4762	0080 20 60	25
M20	65 mm	30 mm	20 mm	HS17	ISO 4762	0080 20 65	25
M20	70 mm	30 mm	20 mm	HS17	ISO 4762	0080 20 70	25
M20	75 mm	30 mm	20 mm	HS17	ISO 4762	0080 20 75	25
M20	80 mm	30 mm	20 mm	HS17	ISO 4762	0080 20 80	25
M20	85 mm	30 mm	20 mm	HS17	ISO 4762	0080 20 85	25
M20	90 mm	30 mm	20 mm	HS17	ISO 4762	0080 20 90	25
M20	100 mm	30 mm	20 mm	HS17	ISO 4762	0080 20 100	25
M20	105 mm	30 mm	20 mm	HS17	ISO 4762	0080 20 105	1
M20	110 mm	30 mm	20 mm	HS17	ISO 4762	0080 20 110	25
M20	115 mm	30 mm	20 mm	HS17	ISO 4762	0080 20 115	25
M20	120 mm	30 mm	20 mm	HS17	ISO 4762	0080 20 120	25
M20	130 mm	30 mm	20 mm	HS17	ISO 4762	0080 20 130	25
M20	135 mm	30 mm	20 mm	HS17	ISO 4762	0080 20 135	25
M20	140 mm	30 mm	20 mm	HS17	ISO 4762	0080 20 140	25
M20	150 mm	30 mm	20 mm	HS17	ISO 4762	0080 20 150	25
M20	160 mm	30 mm	20 mm	HS17	ISO 4762	0080 20 160	10/25
M20	170 mm	30 mm	20 mm	HS17	ISO 4762	0080 20 170	25
M20	172 mm	30 mm	20 mm	HS17	ISO 4762	0080 20 175	30
M20	180 mm	30 mm	20 mm	HS17	ISO 4762	0080 20 180	10
M20	190 mm	30 mm	20 mm	HS17	ISO 4762	0080 20 190	25
M20	200 mm	30 mm	20 mm	HS17	ISO 4762	0080 20 200	1/10
M20	220 mm	30 mm	20 mm	HS17	ISO 4762	0080 20 220	10
M20	240 mm	30 mm	20 mm	HS17	ISO 4762	0080 20 240	10

Thread type x nominal diameter (d ₁)	Length (l ₁)	Head diameter (d _k)	Head height (k ₁)	Internal drive (s ₁)	Standards	Art. no.	P. Qty.
M20	250 mm	30 mm	20 mm	HS17	ISO 4762	0080 20 250	10
M20	260 mm	30 mm	20 mm	HS17	ISO 4762	0080 20 260	10
M20	270 mm	30 mm	20 mm	HS17	ISO 4762	0080 20 270	10
M20	280 mm	30 mm	20 mm	HS17	ISO 4762	0080 20 280	10
M20	300 mm	30 mm	20 mm	HS17	ISO 4762	0080 20 300	10
M20	320 mm	30 mm	20 mm	HS17	ISO 4762	0080 20 320	10
M20	330 mm	30 mm	20 mm	HS17	ISO 4762	0080 20 330	10
M20	350 mm	30 mm	20 mm	HS17	ISO 4762	0080 20 350	10
M20	370 mm	30 mm	20 mm	HS17	ISO 4762	0080 20 370	10
M20	420 mm	30 mm	20 mm	HS17	ISO 4762	0080 20 420	15
M20	440 mm	30 mm	20 mm	HS17	ISO 4762	0080 20 440	10
M20	520 mm	30 mm	20 mm	HS17	ISO 4762	0080 20 520	1
M22	55 mm	33 mm	22 mm	HS17	DIN 912	0080 22 55	25
M22	60 mm	33 mm	22 mm	HS17	DIN 912	0080 22 60	25
M22	70 mm	33 mm	22 mm	HS17	DIN 912	0080 22 70	25
M22	80 mm	33 mm	22 mm	HS17	DIN 912	0080 22 80	25
M22	90 mm	33 mm	22 mm	HS17	DIN 912	0080 22 90	25
M22	130 mm	33 mm	22 mm	HS17	DIN 912	0080 22 130	25
M22	140 mm	33 mm	22 mm	HS17	DIN 912	0080 22 140	10
M22	150 mm	33 mm	22 mm	HS17	DIN 912	0080 22 150	1
M22	160 mm	33 mm	22 mm	HS17	DIN 912	0080 22 160	10
M22	170 mm	33 mm	22 mm	HS17	DIN 912	0080 22 170	25
M22	200 mm	33 mm	22 mm	HS17	DIN 912	0080 22 200	5
M24	30 mm	36 mm	24 mm	HS19	ISO 4762	0080 24 30	25
M24	35 mm	36 mm	24 mm	HS19	ISO 4762	0080 24 35	25
M24	40 mm	36 mm	24 mm	HS19	ISO 4762	0080 24 40	25
M24	45 mm	36 mm	24 mm	HS19	ISO 4762	0080 24 45	25
M24	50 mm	36 mm	24 mm	HS19	ISO 4762	0080 24 50	25
M24	55 mm	36 mm	24 mm	HS19	ISO 4762	0080 24 55	25
M24	60 mm	36 mm	24 mm	HS19	ISO 4762	0080 24 60	10/25
M24	65 mm	36 mm	24 mm	HS19	ISO 4762	0080 24 65	25
M24	70 mm	36 mm	24 mm	HS19	ISO 4762	0080 24 70	10
M24	75 mm	36 mm	24 mm	HS19	ISO 4762	0080 24 75	25
M24	80 mm	36 mm	24 mm	HS19	ISO 4762	0080 24 80	10
M24	90 mm	36 mm	24 mm	HS19	ISO 4762	0080 24 90	1/10
M24	100 mm	36 mm	24 mm	HS19	ISO 4762	0080 24 100	10
M24	110 mm	36 mm	24 mm	HS19	ISO 4762	0080 24 110	10
M24	120 mm	36 mm	24 mm	HS19	ISO 4762	0080 24 120	10
M24	125 mm	36 mm	24 mm	HS19	ISO 4762	0080 24 125	1
M24	130 mm	36 mm	24 mm	HS19	ISO 4762	0080 24 130	15
M24	140 mm	36 mm	24 mm	HS19	ISO 4762	0080 24 140	10
M24	150 mm	36 mm	24 mm	HS19	ISO 4762	0080 24 150	10
M24	160 mm	36 mm	24 mm	HS19	ISO 4762	0080 24 160	10
M24	170 mm	36 mm	24 mm	HS19	ISO 4762	0080 24 170	10
M24	180 mm	36 mm	24 mm	HS19	ISO 4762	0080 24 180	10
M24	190 mm	36 mm	24 mm	HS19	ISO 4762	0080 24 190	10
M24	200 mm	36 mm	24 mm	HS19	ISO 4762	0080 24 200	10
M24	210 mm	36 mm	24 mm	HS19	ISO 4762	0080 24 210	10
M24	220 mm	36 mm	24 mm	HS19	ISO 4762	0080 24 220	10
M24	230 mm	36 mm	24 mm	HS19	ISO 4762	0080 24 230	10
M24	240 mm	36 mm	24 mm	HS19	ISO 4762	0080 24 240	10
M24	250 mm	36 mm	24 mm	HS19	ISO 4762	0080 24 250	10
M24	260 mm	36 mm	24 mm	HS19	ISO 4762	0080 24 260	10

Thread type x nominal diameter (d ₁)	Length (l ₁)	Head diameter (d _k)	Head height (k ₁)	Internal drive (s ₁)	Standards	Art. no.	P. Qty.
M24	280 mm	36 mm	24 mm	HS19	ISO 4762	0080 24 280	10
M24	290 mm	36 mm	24 mm	HS19	ISO 4762	0080 24 290	10
M24	300 mm	36 mm	24 mm	HS19	ISO 4762	0080 24 300	10
M24	310 mm	36 mm	24 mm	HS19	ISO 4762	0080 24 310	15
M24	320 mm	36 mm	24 mm	HS19	ISO 4762	0080 24 320	10
M24	330 mm	36 mm	24 mm	HS19	ISO 4762	0080 24 330	10
M24	350 mm	36 mm	24 mm	HS19	ISO 4762	0080 24 350	15
M24	360 mm	36 mm	24 mm	HS19	ISO 4762	0080 24 360	10
M24	380 mm	36 mm	24 mm	HS19	ISO 4762	0080 24 380	10
M24	390 mm	36 mm	24 mm	HS19	ISO 4762	0080 24 390	1
M24	400 mm	36 mm	24 mm	HS19	ISO 4762	0080 24 400	10
M24	420 mm	36 mm	24 mm	HS19	ISO 4762	0080 24 420	10
M24	480 mm	36 mm	24 mm	HS19	ISO 4762	0080 24 480	1
M24	500 mm	36 mm	24 mm	HS19	ISO 4762	0080 24 500	1
M24	580 mm	36 mm	24 mm	HS19	ISO 4762	0080 24 580	10
M24	600 mm	36 mm	24 mm	HS19	ISO 4762	0080 24 600	10
M27	50 mm	66 mm	27 mm	HS19	DIN 912	0080 27 50	10
M27	55 mm	66 mm	27 mm	HS19	DIN 912	0080 27 55	10
M27	60 mm	66 mm	27 mm	HS19	DIN 912	0080 27 60	10
M27	65 mm	66 mm	27 mm	HS19	DIN 912	0080 27 65	10
M27	70 mm	66 mm	27 mm	HS19	DIN 912	0080 27 70	10
M27	80 mm	66 mm	27 mm	HS19	DIN 912	0080 27 80	10
M27	90 mm	66 mm	27 mm	HS19	DIN 912	0080 27 90	10
M27	95 mm	66 mm	27 mm	HS19	DIN 912	0080 27 95	5
M27	100 mm	66 mm	27 mm	HS19	DIN 912	0080 27 100	10
M27	110 mm	66 mm	27 mm	HS19	DIN 912	0080 27 110	10
M27	120 mm	66 mm	27 mm	HS19	DIN 912	0080 27 120	10
M27	130 mm	66 mm	27 mm	HS19	DIN 912	0080 27 130	10
M27	140 mm	66 mm	27 mm	HS19	DIN 912	0080 27 140	10
M27	150 mm	66 mm	27 mm	HS19	DIN 912	0080 27 150	10
M27	160 mm	66 mm	27 mm	HS19	DIN 912	0080 27 160	10
M27	180 mm	66 mm	27 mm	HS19	DIN 912	0080 27 180	10
M27	200 mm	66 mm	27 mm	HS19	DIN 912	0080 27 200	10
M27	220 mm	66 mm	27 mm	HS19	DIN 912	0080 27 220	1
M27	240 mm	66 mm	27 mm	HS19	DIN 912	0080 27 240	10
M27	260 mm	66 mm	27 mm	HS19	DIN 912	0080 27 260	10
M27	290 mm	66 mm	27 mm	HS19	DIN 912	0080 27 290	1
M27	300 mm	66 mm	27 mm	HS19	DIN 912	0080 27 300	1
M27	320 mm	66 mm	27 mm	HS19	DIN 912	0080 27 320	1
M27	340 mm	66 mm	27 mm	HS19	DIN 912	0080 27 340	10
M27	380 mm	66 mm	27 mm	HS19	DIN 912	0080 27 380	1
M27	400 mm	66 mm	27 mm	HS19	DIN 912	0080 27 400	1
M30	40 mm	45 mm	30 mm	HS22	ISO 4762	0080 30 40	10
M30	45 mm	45 mm	30 mm	HS22	ISO 4762	0080 30 45	25
M30	50 mm	45 mm	30 mm	HS22	ISO 4762	0080 30 50	10
M30	55 mm	45 mm	30 mm	HS22	ISO 4762	0080 30 55	25
M30	60 mm	45 mm	30 mm	HS22	ISO 4762	0080 30 60	10
M30	65 mm	45 mm	30 mm	HS22	ISO 4762	0080 30 65	25
M30	70 mm	45 mm	30 mm	HS22	ISO 4762	0080 30 70	10
M30	75 mm	45 mm	30 mm	HS22	ISO 4762	0080 30 75	10
M30	80 mm	45 mm	30 mm	HS22	ISO 4762	0080 30 80	10
M30	90 mm	45 mm	30 mm	HS22	ISO 4762	0080 30 90	10
M30	100 mm	45 mm	30 mm	HS22	ISO 4762	0080 30 100	10

Thread type x nominal diameter (d ₁)	Length (l ₁)	Head diameter (d _k)	Head height (k ₁)	Internal drive (s ₁)	Standards	Art. no.	P. Qty.
M30	110 mm	45 mm	30 mm	HS22	ISO 4762	0080 30 110	10
M30	120 mm	45 mm	30 mm	HS22	ISO 4762	0080 30 120	10
M30	130 mm	45 mm	30 mm	HS22	ISO 4762	0080 30 130	10
M30	140 mm	45 mm	30 mm	HS22	ISO 4762	0080 30 140	10
M30	150 mm	45 mm	30 mm	HS22	ISO 4762	0080 30 150	10
M30	160 mm	45 mm	30 mm	HS22	ISO 4762	0080 30 160	10
M30	170 mm	45 mm	30 mm	HS22	ISO 4762	0080 30 170	10
M30	175 mm	45 mm	30 mm	HS22	ISO 4762	0080 30 175	10
M30	180 mm	45 mm	30 mm	HS22	ISO 4762	0080 30 180	10
M30	200 mm	45 mm	30 mm	HS22	ISO 4762	0080 30 200	10
M30	220 mm	45 mm	30 mm	HS22	ISO 4762	0080 30 220	5
M30	230 mm	45 mm	30 mm	HS22	ISO 4762	0080 30 230	10
M30	240 mm	45 mm	30 mm	HS22	ISO 4762	0080 30 240	10
M30	250 mm	45 mm	30 mm	HS22	ISO 4762	0080 30 250	10
M30	270 mm	45 mm	30 mm	HS22	ISO 4762	0080 30 270	10
M30	280 mm	45 mm	30 mm	HS22	ISO 4762	0080 30 280	10
M30	300 mm	45 mm	30 mm	HS22	ISO 4762	0080 30 300	10
M30	320 mm	45 mm	30 mm	HS22	ISO 4762	0080 30 320	10
M30	340 mm	45 mm	30 mm	HS22	ISO 4762	0080 30 340	5
M30	350 mm	45 mm	30 mm	HS22	ISO 4762	0080 30 350	1
M30	360 mm	45 mm	30 mm	HS22	ISO 4762	0080 30 360	10
M30	380 mm	45 mm	30 mm	HS22	ISO 4762	0080 30 380	8
M30	430 mm	45 mm	30 mm	HS22	ISO 4762	0080 30 430	5
M30	440 mm	45 mm	30 mm	HS22	ISO 4762	0080 30 440	10
M30	460 mm	45 mm	30 mm	HS22	ISO 4762	0080 30 460	1
M30	480 mm	45 mm	30 mm	HS22	ISO 4762	0080 30 480	1
M30	550 mm	45 mm	30 mm	HS22	ISO 4762	0080 30 550	1
M30	600 mm	45 mm	30 mm	HS22	ISO 4762	0080 30 600	1
M30	610 mm	45 mm	30 mm	HS22	ISO 4762	0080 30 610	1
M33	80 mm	50 mm	33 mm	HS24	DIN 912	0080 33 80	5
M33	100 mm	50 mm	33 mm	HS24	DIN 912	0080 33 100	1
M33	140 mm	50 mm	33 mm	HS24	DIN 912	0080 33 140	10
M33	160 mm	50 mm	33 mm	HS24	DIN 912	0080 33 160	10
M33	180 mm	50 mm	33 mm	HS24	DIN 912	0080 33 180	5
M33	240 mm	50 mm	33 mm	HS24	DIN 912	0080 33 240	5
M33	260 mm	50 mm	33 mm	HS24	DIN 912	0080 33 260	1
M36	55 mm	54 mm	36 mm	HS27	ISO 4762	0080 36 55	25
M36	60 mm	54 mm	36 mm	HS27	ISO 4762	0080 36 60	10
M36	65 mm	54 mm	36 mm	HS27	ISO 4762	0080 36 65	25
M36	70 mm	54 mm	36 mm	HS27	ISO 4762	0080 36 70	10
M36	80 mm	54 mm	36 mm	HS27	ISO 4762	0080 36 80	10
M36	90 mm	54 mm	36 mm	HS27	ISO 4762	0080 36 90	10
M36	110 mm	54 mm	36 mm	HS27	ISO 4762	0080 36 110	10
M36	120 mm	54 mm	36 mm	HS27	ISO 4762	0080 36 120	10
M36	130 mm	54 mm	36 mm	HS27	ISO 4762	0080 36 130	5
M36	140 mm	54 mm	36 mm	HS27	ISO 4762	0080 36 140	5
M36	150 mm	54 mm	36 mm	HS27	ISO 4762	0080 36 150	5
M36	160 mm	54 mm	36 mm	HS27	ISO 4762	0080 36 160	10
M36	170 mm	54 mm	36 mm	HS27	ISO 4762	0080 36 170	10
M36	190 mm	54 mm	36 mm	HS27	ISO 4762	0080 36 190	10
M36	200 mm	54 mm	36 mm	HS27	ISO 4762	0080 36 200	10
M36	210 mm	54 mm	36 mm	HS27	ISO 4762	0080 36 210	10
M36	220 mm	54 mm	36 mm	HS27	ISO 4762	0080 36 220	5

Thread type x nominal diameter (d ₁)	Length (l ₁)	Head diameter (d _k)	Head height (k ₁)	Internal drive (s ₁)	Standards	Art. no.	P. Qty.
M36	230 mm	54 mm	36 mm	HS27	ISO 4762	0080 36 230	5
M36	240 mm	54 mm	36 mm	HS27	ISO 4762	0080 36 240	10
M36	250 mm	54 mm	36 mm	HS27	ISO 4762	0080 36 250	10
M36	260 mm	54 mm	36 mm	HS27	ISO 4762	0080 36 260	10
M36	270 mm	54 mm	36 mm	HS27	ISO 4762	0080 36 270	1
M36	280 mm	54 mm	36 mm	HS27	ISO 4762	0080 36 280	10
M36	290 mm	54 mm	36 mm	HS27	ISO 4762	0080 36 290	1
M36	300 mm	54 mm	36 mm	HS27	ISO 4762	0080 36 300	10
M36	310 mm	54 mm	36 mm	HS27	ISO 4762	0080 36 310	5
M36	320 mm	54 mm	36 mm	HS27	ISO 4762	0080 36 320	5
M36	330 mm	54 mm	36 mm	HS27	ISO 4762	0080 36 330	1
M36	340 mm	54 mm	36 mm	HS27	ISO 4762	0080 36 340	1
M36	350 mm	54 mm	36 mm	HS27	ISO 4762	0080 36 350	10
M36	360 mm	54 mm	36 mm	HS27	ISO 4762	0080 36 360	1
M36	370 mm	54 mm	36 mm	HS27	ISO 4762	0080 36 370	5
M36	380 mm	54 mm	36 mm	HS27	ISO 4762	0080 36 380	5
M36	460 mm	54 mm	36 mm	HS27	ISO 4762	0080 36 460	5
M36	550 mm	54 mm	36 mm	HS27	ISO 4762	0080 36 550	5
M36	610 mm	54 mm	36 mm	HS27	ISO 4762	0080 36 610	1
M42	80 mm	63 mm	42 mm	HS32	ISO 4762	0080 42 80	1
M42	100 mm	63 mm	42 mm	HS32	ISO 4762	0080 42 100	10
M42	110 mm	63 mm	42 mm	HS32	ISO 4762	0080 42 110	10
M42	120 mm	63 mm	42 mm	HS32	ISO 4762	0080 42 120	1
M42	130 mm	63 mm	42 mm	HS32	ISO 4762	0080 42 130	5
M42	140 mm	63 mm	42 mm	HS32	ISO 4762	0080 42 140	5
M42	150 mm	63 mm	42 mm	HS32	ISO 4762	0080 42 150	1
M42	160 mm	63 mm	42 mm	HS32	ISO 4762	0080 42 160	5
M42	170 mm	63 mm	42 mm	HS32	ISO 4762	0080 42 170	1
M42	175 mm	63 mm	42 mm	HS32	ISO 4762	0080 42 175	1
M42	200 mm	63 mm	42 mm	HS32	ISO 4762	0080 42 200	1
M42	220 mm	63 mm	42 mm	HS32	ISO 4762	0080 42 220	1
M42	230 mm	63 mm	42 mm	HS32	ISO 4762	0080 42 230	5
M42	240 mm	63 mm	42 mm	HS32	ISO 4762	0080 42 240	1
M42	250 mm	63 mm	42 mm	HS32	ISO 4762	0080 42 250	1
M42	280 mm	63 mm	42 mm	HS32	ISO 4762	0080 42 280	1
M42	300 mm	63 mm	42 mm	HS32	ISO 4762	0080 42 300	10
M42	360 mm	63 mm	42 mm	HS32	ISO 4762	0080 42 360	1
M42	400 mm	63 mm	42 mm	HS32	ISO 4762	0080 42 400	1
M48	90 mm	72 mm	48 mm	HS36	ISO 4762	0080 48 90	1
M48	100 mm	72 mm	48 mm	HS36	ISO 4762	0080 48 100	1
M48	110 mm	72 mm	48 mm	HS36	ISO 4762	0080 48 110	1
M48	120 mm	72 mm	48 mm	HS36	ISO 4762	0080 48 120	8
M48	130 mm	72 mm	48 mm	HS36	ISO 4762	0080 48 130	1
M48	150 mm	72 mm	48 mm	HS36	ISO 4762	0080 48 150	1
M48	160 mm	72 mm	48 mm	HS36	ISO 4762	0080 48 160	1
M48	180 mm	72 mm	48 mm	HS36	ISO 4762	0080 48 180	1
M48	200 mm	72 mm	48 mm	HS36	ISO 4762	0080 48 200	5
M48	210 mm	72 mm	48 mm	HS36	ISO 4762	0080 48 210	1
M48	240 mm	72 mm	48 mm	HS36	ISO 4762	0080 48 240	1
M48	250 mm	72 mm	48 mm	HS36	ISO 4762	0080 48 250	1
M48	260 mm	72 mm	48 mm	HS36	ISO 4762	0080 48 260	5
M48	270 mm	72 mm	48 mm	HS36	ISO 4762	0080 48 270	5
M48	280 mm	72 mm	48 mm	HS36	ISO 4762	0080 48 280	1

Thread type x nominal diameter (d ₁)	Length (l ₁)	Head diameter (d _k)	Head height (k ₁)	Internal drive (s ₁)	Standards	Art. no.	P. Qty.
M48	300 mm	72 mm	48 mm	HS36	ISO 4762	0080 48 300	1
M48	340 mm	72 mm	48 mm	HS36	ISO 4762	0080 48 340	1
M48	360 mm	72 mm	48 mm	HS36	ISO 4762	0080 48 360	3
M48	480 mm	72 mm	48 mm	HS36	ISO 4762	0080 48 480	1
M48	500 mm	72 mm	48 mm	HS36	ISO 4762	0080 48 500	1
M56	120 mm	84 mm	56 mm	HS41	ISO 4762	0080 56 120	1
M56	220 mm	84 mm	56 mm	HS41	ISO 4762	0080 56 220	1
M56	250 mm	84 mm	56 mm	HS41	ISO 4762	0080 56 250	1
M56	280 mm	84 mm	56 mm	HS41	ISO 4762	0080 56 280	1
M56	320 mm	84 mm	56 mm	HS41	ISO 4762	0080 56 320	1

Notice

ISO 4762 replaces DIN 912 | There is some similarity | Nominal range changed | Fine thread moved to ISO 12474.