

## Hexagon Socket Head Cap Screw

ISO 4762/DIN 912, steel 12.9, bare

Material	Steel
Surface	Plain
Property class	12.9
RoHS-compliant	Yes

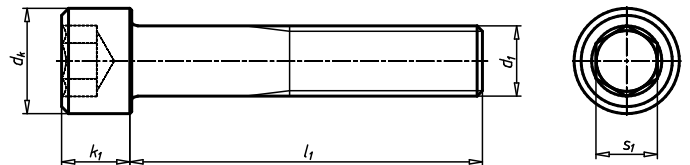

Thread type x nominal diameter (d <sub>1</sub> )	Length (l <sub>1</sub> )	Head diameter (d <sub>k</sub> )	Head height (k <sub>1</sub> )	Internal drive (s <sub>1</sub> )	Standards	Art. no.	P. Qty.
M1.4	3 mm	2.6 mm	1.4 mm	HS1.3	DIN 912	<b>0083 15 3</b>	1000
M1.4	4 mm	2.6 mm	1.4 mm	HS1.3	DIN 912	<b>0083 15 4</b>	1000
M1.6	2 mm	3 mm	1.6 mm	HS1.5	DIN 912	<b>0083 17 2</b>	1000
M1.6	3 mm	3 mm	1.6 mm	HS1.5	ISO 4762	<b>0083 17 3</b>	500
M1.6	4 mm	3 mm	1.6 mm	HS1.5	ISO 4762	<b>0083 17 4</b>	1000
M2	4 mm	3.8 mm	2 mm	HS1.5	ISO 4762	<b>0083 2 4</b>	1000
M2	5 mm	3.8 mm	2 mm	HS1.5	ISO 4762	<b>0083 2 5</b>	1000
M2	6 mm	3.8 mm	2 mm	HS1.5	ISO 4762	<b>0083 2 6</b>	1000
M2	8 mm	3.8 mm	2 mm	HS1.5	ISO 4762	<b>0083 2 8</b>	500
M2	10 mm	3.8 mm	2 mm	HS1.5	ISO 4762	<b>0083 2 10</b>	1000
M2	14 mm	3.8 mm	2 mm	HS1.5	ISO 4762	<b>0083 2 14</b>	1000
M2	16 mm	3.8 mm	2 mm	HS1.5	ISO 4762	<b>0083 2 16</b>	1000
M2.5	3 mm	4.5 mm	2.5 mm	HS2	ISO 4762	<b>0083 25 3</b>	1000
M2.5	4 mm	4.5 mm	2.5 mm	HS2	ISO 4762	<b>0083 25 4</b>	1000
M2.5	5 mm	4.5 mm	2.5 mm	HS2	ISO 4762	<b>0083 25 5</b>	1000
M2.5	6 mm	4.5 mm	2.5 mm	HS2	ISO 4762	<b>0083 25 6</b>	500
M2.5	8 mm	4.5 mm	2.5 mm	HS2	ISO 4762	<b>0083 25 8</b>	500
M2.5	10 mm	4.5 mm	2.5 mm	HS2	ISO 4762	<b>0083 25 10</b>	1000
M2.5	12 mm	4.5 mm	2.5 mm	HS2	ISO 4762	<b>0083 25 12</b>	500
M2.5	16 mm	4.5 mm	2.5 mm	HS2	ISO 4762	<b>0083 25 16</b>	500
M2.5	20 mm	4.5 mm	2.5 mm	HS2	ISO 4762	<b>0083 25 20</b>	500
M2.5	25 mm	4.5 mm	2.5 mm	HS2	ISO 4762	<b>0083 25 25</b>	500
M2.5	30 mm	4.5 mm	2.5 mm	HS2	ISO 4762	<b>0083 25 30</b>	500
M3	4 mm	5.5 mm	3 mm	HS2.5	ISO 4762	<b>0083 3 4</b>	500
M3	5 mm	5.5 mm	3 mm	HS2.5	ISO 4762	<b>0083 3 5</b>	1000
M3	6 mm	5.5 mm	3 mm	HS2.5	ISO 4762	<b>0083 3 6</b>	200/1000
M3	8 mm	5.5 mm	3 mm	HS2.5	ISO 4762	<b>0083 3 8</b>	200/1000
M3	8 mm	5.5 mm	3 mm	HS2.5	ISO 4762	<b>0083 3 70</b>	50
M3	10 mm	5.5 mm	3 mm	HS2.5	ISO 4762	<b>0083 3 10</b>	200/1000
M3	12 mm	5.5 mm	3 mm	HS2.5	ISO 4762	<b>0083 3 12</b>	200/1000
M3	14 mm	5.5 mm	3 mm	HS2.5	ISO 4762	<b>0083 3 14</b>	500
M3	16 mm	5.5 mm	3 mm	HS2.5	ISO 4762	<b>0083 3 16</b>	200/500
M3	18 mm	5.5 mm	3 mm	HS2.5	ISO 4762	<b>0083 3 18</b>	500
M3	20 mm	5.5 mm	3 mm	HS2.5	ISO 4762	<b>0083 3 20</b>	200/500

Thread type x nominal diameter (d <sub>1</sub> )	Length (l <sub>1</sub> )	Head diameter (d <sub>k</sub> )	Head height (k <sub>1</sub> )	Internal drive (s <sub>1</sub> )	Standards	Art. no.	P. Qty.
M3	22 mm	5.5 mm	3 mm	HS2.5	ISO 4762	<b>0083 3 22</b>	500
M3	25 mm	5.5 mm	3 mm	HS2.5	ISO 4762	<b>0083 3 25</b>	200/500
M3	30 mm	5.5 mm	3 mm	HS2.5	ISO 4762	<b>0083 3 30</b>	500
M3	35 mm	5.5 mm	3 mm	HS2.5	ISO 4762	<b>0083 3 35</b>	500
M3	40 mm	5.5 mm	3 mm	HS2.5	ISO 4762	<b>0083 3 40</b>	200
M3	45 mm	5.5 mm	3 mm	HS2.5	ISO 4762	<b>0083 3 45</b>	500
M3	50 mm	5.5 mm	3 mm	HS2.5	ISO 4762	<b>0083 3 50</b>	500
M3	55 mm	5.5 mm	3 mm	HS2.5	ISO 4762	<b>0083 3 55</b>	500
M4	5 mm	7 mm	4 mm	HS3	ISO 4762	<b>0083 4 5</b>	500
M4	6 mm	7 mm	4 mm	HS3	ISO 4762	<b>0083 4 6</b>	200/500
M4	8 mm	7 mm	4 mm	HS3	ISO 4762	<b>0083 4 8</b>	100/1000
M4	10 mm	7 mm	4 mm	HS3	ISO 4762	<b>0083 4 10</b>	100/1000
M4	12 mm	7 mm	4 mm	HS3	ISO 4762	<b>0083 4 12</b>	100/1000
M4	14 mm	7 mm	4 mm	HS3	ISO 4762	<b>0083 4 14</b>	100/500
M4	16 mm	7 mm	4 mm	HS3	ISO 4762	<b>0083 4 16</b>	100/500
M4	20 mm	7 mm	4 mm	HS3	ISO 4762	<b>0083 4 20</b>	100/500
M4	22 mm	7 mm	4 mm	HS3	ISO 4762	<b>0083 4 22</b>	500
M4	25 mm	7 mm	4 mm	HS3	ISO 4762	<b>0083 4 25</b>	100/500
M4	30 mm	7 mm	4 mm	HS3	ISO 4762	<b>0083 4 30</b>	100/500
M4	35 mm	7 mm	4 mm	HS3	ISO 4762	<b>0083 4 35</b>	100/500
M4	40 mm	7 mm	4 mm	HS3	ISO 4762	<b>0083 4 40</b>	100/500
M4	45 mm	7 mm	4 mm	HS3	ISO 4762	<b>0083 4 45</b>	100
M4	50 mm	7 mm	4 mm	HS3	ISO 4762	<b>0083 4 50</b>	100
M4	55 mm	7 mm	4 mm	HS3	ISO 4762	<b>0083 4 55</b>	500
M4	60 mm	7 mm	4 mm	HS3	ISO 4762	<b>0083 4 60</b>	200
M4	65 mm	7 mm	4 mm	HS3	ISO 4762	<b>0083 4 65</b>	200
M4	70 mm	7 mm	4 mm	HS3	ISO 4762	<b>0083 4 70</b>	500
M4	75 mm	7 mm	4 mm	HS3	ISO 4762	<b>0083 4 75</b>	200
M4	80 mm	7 mm	4 mm	HS3	ISO 4762	<b>0083 4 80</b>	200
M4	85 mm	7 mm	4 mm	HS3	ISO 4762	<b>0083 4 85</b>	200
M4	90 mm	7 mm	4 mm	HS3	ISO 4762	<b>0083 4 90</b>	200
M4	95 mm	7 mm	4 mm	HS3	ISO 4762	<b>0083 4 95</b>	50
M4	100 mm	7 mm	4 mm	HS3	ISO 4762	<b>0083 4 100</b>	200
M4	110 mm	7 mm	4 mm	HS3	ISO 4762	<b>0083 4 110</b>	100
M4	120 mm	7 mm	4 mm	HS3	ISO 4762	<b>0083 4 120</b>	200
M5	6 mm	8.5 mm	5 mm	HS4	ISO 4762	<b>0083 5 6</b>	500
M5	8 mm	8.5 mm	5 mm	HS4	ISO 4762	<b>0083 5 8</b>	100/500
M5	10 mm	8.5 mm	5 mm	HS4	ISO 4762	<b>0083 5 10</b>	100/500
M5	12 mm	8.5 mm	5 mm	HS4	ISO 4762	<b>0083 5 12</b>	100/500
M5	14 mm	8.5 mm	5 mm	HS4	ISO 4762	<b>0083 5 14</b>	500
M5	16 mm	8.5 mm	5 mm	HS4	ISO 4762	<b>0083 5 16</b>	100/500
M5	18 mm	8.5 mm	5 mm	HS4	ISO 4762	<b>0083 5 18</b>	500
M5	20 mm	8.5 mm	5 mm	HS4	ISO 4762	<b>0083 5 20</b>	100/500
M5	22 mm	8.5 mm	5 mm	HS4	ISO 4762	<b>0083 5 22</b>	500
M5	25 mm	8.5 mm	5 mm	HS4	ISO 4762	<b>0083 5 25</b>	100/500
M5	28 mm	8.5 mm	5 mm	HS4	ISO 4762	<b>0083 5 28</b>	1
M5	30 mm	8.5 mm	5 mm	HS4	ISO 4762	<b>0083 5 30</b>	100/500
M5	35 mm	8.5 mm	5 mm	HS4	ISO 4762	<b>0083 5 35</b>	100/500
M5	40 mm	8.5 mm	5 mm	HS4	ISO 4762	<b>0083 5 40</b>	100/200
M5	45 mm	8.5 mm	5 mm	HS4	ISO 4762	<b>0083 5 45</b>	100
M5	50 mm	8.5 mm	5 mm	HS4	ISO 4762	<b>0083 5 50</b>	100/200
M5	55 mm	8.5 mm	5 mm	HS4	ISO 4762	<b>0083 5 55</b>	100/200
M5	60 mm	8.5 mm	5 mm	HS4	ISO 4762	<b>0083 5 60</b>	100/200

Thread type x nominal diameter (d <sub>1</sub> )	Length (l <sub>1</sub> )	Head diameter (d <sub>k</sub> )	Head height (k <sub>1</sub> )	Internal drive (s <sub>1</sub> )	Standards	Art. no.	P. Qty.
M5	65 mm	8.5 mm	5 mm	HS4	ISO 4762	<b>0083 5 65</b>	100/200
M5	70 mm	8.5 mm	5 mm	HS4	ISO 4762	<b>0083 5 70</b>	100/200
M5	75 mm	8.5 mm	5 mm	HS4	ISO 4762	<b>0083 5 75</b>	200
M5	80 mm	8.5 mm	5 mm	HS4	ISO 4762	<b>0083 5 80</b>	100/200
M5	85 mm	8.5 mm	5 mm	HS4	ISO 4762	<b>0083 5 85</b>	200
M5	90 mm	8.5 mm	5 mm	HS4	ISO 4762	<b>0083 5 90</b>	100/200
M5	95 mm	8.5 mm	5 mm	HS4	ISO 4762	<b>0083 5 95</b>	200
M5	100 mm	8.5 mm	5 mm	HS4	ISO 4762	<b>0083 5 100</b>	200
M5	105 mm	8.5 mm	5 mm	HS4	ISO 4762	<b>0083 5 105</b>	100
M5	110 mm	8.5 mm	5 mm	HS4	ISO 4762	<b>0083 5 110</b>	200
M5	115 mm	8.5 mm	5 mm	HS4	ISO 4762	<b>0083 5 115</b>	100
M5	120 mm	8.5 mm	5 mm	HS4	ISO 4762	<b>0083 5 120</b>	200
M5	125 mm	8.5 mm	5 mm	HS4	ISO 4762	<b>0083 5 125</b>	200
M5	130 mm	8.5 mm	5 mm	HS4	ISO 4762	<b>0083 5 130</b>	200
M5	135 mm	8.5 mm	5 mm	HS4	ISO 4762	<b>0083 5 135</b>	200
M5	140 mm	8.5 mm	5 mm	HS4	ISO 4762	<b>0083 5 140</b>	200
M5	145 mm	8.5 mm	5 mm	HS4	ISO 4762	<b>0083 5 145</b>	100
M5	150 mm	8.5 mm	5 mm	HS4	ISO 4762	<b>0083 5 150</b>	200
M5	155 mm	8.5 mm	5 mm	HS4	ISO 4762	<b>0083 5 155</b>	100
M5	160 mm	8.5 mm	5 mm	HS4	ISO 4762	<b>0083 5 160</b>	200
M5	165 mm	8.5 mm	5 mm	HS4	ISO 4762	<b>0083 5 165</b>	100
M5	170 mm	8.5 mm	5 mm	HS4	ISO 4762	<b>0083 5 170</b>	200
M5	180 mm	8.5 mm	5 mm	HS4	ISO 4762	<b>0083 5 180</b>	200
M5	185 mm	8.5 mm	5 mm	HS4	ISO 4762	<b>0083 5 185</b>	200
M5	190 mm	8.5 mm	5 mm	HS4	ISO 4762	<b>0083 5 190</b>	200
M5	195 mm	8.5 mm	5 mm	HS4	ISO 4762	<b>0083 5 195</b>	100
M5	200 mm	8.5 mm	5 mm	HS4	ISO 4762	<b>0083 5 200</b>	200
M5	210 mm	8.5 mm	5 mm	HS4	ISO 4762	<b>0083 5 210</b>	200
M5	220 mm	8.5 mm	5 mm	HS4	ISO 4762	<b>0083 5 220</b>	50
M5	230 mm	8.5 mm	5 mm	HS4	ISO 4762	<b>0083 5 230</b>	50
M6	6 mm	10 mm	6 mm	HS5	ISO 4762	<b>0083 6 6</b>	500
M6	8 mm	10 mm	6 mm	HS5	ISO 4762	<b>0083 6 8</b>	100/500
M6	10 mm	10 mm	6 mm	HS5	ISO 4762	<b>0083 6 10</b>	100/500
M6	12 mm	10 mm	6 mm	HS5	ISO 4762	<b>0083 6 12</b>	100/500
M6	14 mm	10 mm	6 mm	HS5	ISO 4762	<b>0083 6 14</b>	500
M6	16 mm	10 mm	6 mm	HS5	ISO 4762	<b>0083 6 16</b>	100/500
M6	18 mm	10 mm	6 mm	HS5	ISO 4762	<b>0083 6 18</b>	100/500
M6	20 mm	10 mm	6 mm	HS5	ISO 4762	<b>0083 6 20</b>	100/500
M6	22 mm	10 mm	6 mm	HS5	ISO 4762	<b>0083 6 22</b>	500
M6	25 mm	10 mm	6 mm	HS5	ISO 4762	<b>0083 6 25</b>	100/500
M6	30 mm	10 mm	6 mm	HS5	ISO 4762	<b>0083 6 30</b>	100/500
M6	35 mm	10 mm	6 mm	HS5	ISO 4762	<b>0083 6 35</b>	100
M6	40 mm	10 mm	6 mm	HS5	ISO 4762	<b>0083 6 40</b>	100/200
M6	45 mm	10 mm	6 mm	HS5	ISO 4762	<b>0083 6 45</b>	100/200
M6	50 mm	10 mm	6 mm	HS5	ISO 4762	<b>0083 6 50</b>	100/200
M6	55 mm	10 mm	6 mm	HS5	ISO 4762	<b>0083 6 55</b>	100/200
M6	60 mm	10 mm	6 mm	HS5	ISO 4762	<b>0083 6 60</b>	100/200
M6	65 mm	10 mm	6 mm	HS5	ISO 4762	<b>0083 6 65</b>	100/200
M6	70 mm	10 mm	6 mm	HS5	ISO 4762	<b>0083 6 70</b>	100/200
M6	75 mm	10 mm	6 mm	HS5	ISO 4762	<b>0083 6 75</b>	200
M6	80 mm	10 mm	6 mm	HS5	ISO 4762	<b>0083 6 80</b>	100
M6	85 mm	10 mm	6 mm	HS5	ISO 4762	<b>0083 6 85</b>	100
M6	90 mm	10 mm	6 mm	HS5	ISO 4762	<b>0083 6 90</b>	100

Thread type x nominal diameter (d <sub>1</sub> )	Length (l <sub>1</sub> )	Head diameter (d <sub>k</sub> )	Head height (k <sub>1</sub> )	Internal drive (s <sub>1</sub> )	Standards	Art. no.	P. Qty.
M6	95 mm	10 mm	6 mm	HS5	ISO 4762	<b>0083 6 95</b>	100
M6	100 mm	10 mm	6 mm	HS5	ISO 4762	<b>0083 6 100</b>	100
M6	105 mm	10 mm	6 mm	HS5	ISO 4762	<b>0083 6 105</b>	100
M6	110 mm	10 mm	6 mm	HS5	ISO 4762	<b>0083 6 110</b>	100
M6	115 mm	10 mm	6 mm	HS5	ISO 4762	<b>0083 6 115</b>	50
M6	120 mm	10 mm	6 mm	HS5	ISO 4762	<b>0083 6 120</b>	100
M6	125 mm	10 mm	6 mm	HS5	ISO 4762	<b>0083 6 125</b>	50
M6	130 mm	10 mm	6 mm	HS5	ISO 4762	<b>0083 6 130</b>	100
M6	135 mm	10 mm	6 mm	HS5	ISO 4762	<b>0083 6 135</b>	50
M6	140 mm	10 mm	6 mm	HS5	ISO 4762	<b>0083 6 140</b>	100
M6	145 mm	10 mm	6 mm	HS5	ISO 4762	<b>0083 6 145</b>	100
M6	150 mm	10 mm	6 mm	HS5	ISO 4762	<b>0083 6 150</b>	100
M6	155 mm	10 mm	6 mm	HS5	ISO 4762	<b>0083 6 155</b>	100
M6	160 mm	10 mm	6 mm	HS5	ISO 4762	<b>0083 6 160</b>	100
M6	165 mm	10 mm	6 mm	HS5	ISO 4762	<b>0083 6 165</b>	100
M6	170 mm	10 mm	6 mm	HS5	ISO 4762	<b>0083 6 170</b>	100
M6	185 mm	10 mm	6 mm	HS5	ISO 4762	<b>0083 6 185</b>	25
M6	190 mm	10 mm	6 mm	HS5	ISO 4762	<b>0083 6 190</b>	100
M6	200 mm	10 mm	6 mm	HS5	ISO 4762	<b>0083 6 200</b>	100
M6	210 mm	10 mm	6 mm	HS5	ISO 4762	<b>0083 6 210</b>	50
M6	300 mm	10 mm	6 mm	HS5	ISO 4762	<b>0083 6 300</b>	100
M8	10 mm	13 mm	8 mm	HS6	ISO 4762	<b>0083 8 10</b>	100/200
M8	12 mm	13 mm	8 mm	HS6	ISO 4762	<b>0083 8 12</b>	100/200
M8	14 mm	13 mm	8 mm	HS6	ISO 4762	<b>0083 8 14</b>	200
M8	16 mm	13 mm	8 mm	HS6	ISO 4762	<b>0083 8 16</b>	100/200
M8	18 mm	13 mm	8 mm	HS6	ISO 4762	<b>0083 8 18</b>	200
M8	20 mm	13 mm	8 mm	HS6	ISO 4762	<b>0083 8 20</b>	100/200
M8	22 mm	13 mm	8 mm	HS6	ISO 4762	<b>0083 8 22</b>	200
M8	25 mm	13 mm	8 mm	HS6	ISO 4762	<b>0083 8 25</b>	100/200
M8	30 mm	13 mm	8 mm	HS6	ISO 4762	<b>0083 8 30</b>	100/200
M8	35 mm	13 mm	8 mm	HS6	ISO 4762	<b>0083 8 35</b>	100/200
M8	40 mm	13 mm	8 mm	HS6	ISO 4762	<b>0083 8 40</b>	100/200
M8	45 mm	13 mm	8 mm	HS6	ISO 4762	<b>0083 8 45</b>	100/200
M8	50 mm	13 mm	8 mm	HS6	ISO 4762	<b>0083 8 50</b>	100/200
M8	55 mm	13 mm	8 mm	HS6	ISO 4762	<b>0083 8 55</b>	100
M8	60 mm	13 mm	8 mm	HS6	ISO 4762	<b>0083 8 60</b>	100/200
M8	65 mm	13 mm	8 mm	HS6	ISO 4762	<b>0083 8 65</b>	100
M8	70 mm	13 mm	8 mm	HS6	ISO 4762	<b>0083 8 70</b>	100
M8	75 mm	13 mm	8 mm	HS6	ISO 4762	<b>0083 8 75</b>	100
M8	80 mm	13 mm	8 mm	HS6	ISO 4762	<b>0083 8 80</b>	100
M8	85 mm	13 mm	8 mm	HS6	ISO 4762	<b>0083 8 85</b>	100
M8	90 mm	13 mm	8 mm	HS6	ISO 4762	<b>0083 8 90</b>	100
M8	95 mm	13 mm	8 mm	HS6	ISO 4762	<b>0083 8 95</b>	100
M8	100 mm	13 mm	8 mm	HS6	ISO 4762	<b>0083 8 100</b>	100
M8	105 mm	13 mm	8 mm	HS6	ISO 4762	<b>0083 8 105</b>	100
M8	110 mm	13 mm	8 mm	HS6	ISO 4762	<b>0083 8 110</b>	50/100
M8	115 mm	13 mm	8 mm	HS6	ISO 4762	<b>0083 8 115</b>	100
M8	120 mm	13 mm	8 mm	HS6	ISO 4762	<b>0083 8 120</b>	50/100
M8	125 mm	13 mm	8 mm	HS6	ISO 4762	<b>0083 8 125</b>	100
M8	130 mm	13 mm	8 mm	HS6	ISO 4762	<b>0083 8 130</b>	50/100
M8	135 mm	13 mm	8 mm	HS6	ISO 4762	<b>0083 8 135</b>	50
M8	140 mm	13 mm	8 mm	HS6	ISO 4762	<b>0083 8 140</b>	50
M8	150 mm	13 mm	8 mm	HS6	ISO 4762	<b>0083 8 150</b>	50

Thread type x nominal diameter (d <sub>1</sub> )	Length (l <sub>1</sub> )	Head diameter (d <sub>k</sub> )	Head height (k <sub>1</sub> )	Internal drive (s <sub>1</sub> )	Standards	Art. no.	P. Qty.
M8	155 mm	13 mm	8 mm	HS6	ISO 4762	<b>0083 8 155</b>	25
M8	160 mm	13 mm	8 mm	HS6	ISO 4762	<b>0083 8 160</b>	50
M8	165 mm	13 mm	8 mm	HS6	ISO 4762	<b>0083 8 165</b>	25
M8	170 mm	13 mm	8 mm	HS6	ISO 4762	<b>0083 8 170</b>	50
M8	175 mm	13 mm	8 mm	HS6	ISO 4762	<b>0083 8 175</b>	50
M8	180 mm	13 mm	8 mm	HS6	ISO 4762	<b>0083 8 180</b>	50
M8	185 mm	13 mm	8 mm	HS6	ISO 4762	<b>0083 8 185</b>	25
M8	190 mm	13 mm	8 mm	HS6	ISO 4762	<b>0083 8 190</b>	50
M8	200 mm	13 mm	8 mm	HS6	ISO 4762	<b>0083 8 200</b>	50
M8	210 mm	13 mm	8 mm	HS6	ISO 4762	<b>0083 8 210</b>	1
M8	220 mm	13 mm	8 mm	HS6	ISO 4762	<b>0083 8 220</b>	50
M8	230 mm	13 mm	8 mm	HS6	ISO 4762	<b>0083 8 230</b>	25
M8	240 mm	13 mm	8 mm	HS6	ISO 4762	<b>0083 8 240</b>	25
M8	260 mm	13 mm	8 mm	HS6	ISO 4762	<b>0083 8 260</b>	50
M10	12 mm	16 mm	10 mm	HS8	ISO 4762	<b>0083 10 12</b>	200
M10	16 mm	16 mm	10 mm	HS8	ISO 4762	<b>0083 10 16</b>	200
M10	18 mm	16 mm	10 mm	HS8	ISO 4762	<b>0083 10 18</b>	100
M10	20 mm	16 mm	10 mm	HS8	ISO 4762	<b>0083 10 20</b>	200
M10	22 mm	16 mm	10 mm	HS8	ISO 4762	<b>0083 10 22</b>	200
M10	25 mm	16 mm	10 mm	HS8	ISO 4762	<b>0083 10 25</b>	25/200
M10	30 mm	16 mm	10 mm	HS8	ISO 4762	<b>0083 10 30</b>	200
M10	35 mm	16 mm	10 mm	HS8	ISO 4762	<b>0083 10 35</b>	100
M10	40 mm	16 mm	10 mm	HS8	ISO 4762	<b>0083 10 40</b>	100
M10	45 mm	16 mm	10 mm	HS8	ISO 4762	<b>0083 10 45</b>	100
M10	50 mm	16 mm	10 mm	HS8	ISO 4762	<b>0083 10 50</b>	100
M10	55 mm	16 mm	10 mm	HS8	ISO 4762	<b>0083 10 55</b>	100
M10	60 mm	16 mm	10 mm	HS8	ISO 4762	<b>0083 10 60</b>	100
M10	65 mm	16 mm	10 mm	HS8	ISO 4762	<b>0083 10 65</b>	100
M10	70 mm	16 mm	10 mm	HS8	ISO 4762	<b>0083 10 70</b>	100
M10	75 mm	16 mm	10 mm	HS8	ISO 4762	<b>0083 10 75</b>	100
M10	80 mm	16 mm	10 mm	HS8	ISO 4762	<b>0083 10 80</b>	100
M10	85 mm	16 mm	10 mm	HS8	ISO 4762	<b>0083 10 85</b>	100
M10	90 mm	16 mm	10 mm	HS8	ISO 4762	<b>0083 10 90</b>	50/100
M10	95 mm	16 mm	10 mm	HS8	ISO 4762	<b>0083 10 95</b>	50
M10	100 mm	16 mm	10 mm	HS8	ISO 4762	<b>0083 10 100</b>	50/100
M10	110 mm	16 mm	10 mm	HS8	ISO 4762	<b>0083 10 110</b>	50
M10	115 mm	16 mm	10 mm	HS8	ISO 4762	<b>0083 10 115</b>	50
M10	120 mm	16 mm	10 mm	HS8	ISO 4762	<b>0083 10 120</b>	50
M10	125 mm	16 mm	10 mm	HS8	ISO 4762	<b>0083 10 125</b>	50
M10	130 mm	16 mm	10 mm	HS8	ISO 4762	<b>0083 10 130</b>	50
M10	140 mm	16 mm	10 mm	HS8	ISO 4762	<b>0083 10 140</b>	50
M10	145 mm	16 mm	10 mm	HS8	ISO 4762	<b>0083 10 145</b>	50
M10	150 mm	16 mm	10 mm	HS8	ISO 4762	<b>0083 10 150</b>	25/50
M10	155 mm	16 mm	10 mm	HS8	ISO 4762	<b>0083 10 155</b>	50
M10	160 mm	16 mm	10 mm	HS8	ISO 4762	<b>0083 10 160</b>	25/50
M10	165 mm	16 mm	10 mm	HS8	ISO 4762	<b>0083 10 165</b>	100
M10	170 mm	16 mm	10 mm	HS8	ISO 4762	<b>0083 10 170</b>	50
M10	175 mm	16 mm	10 mm	HS8	ISO 4762	<b>0083 10 175</b>	10
M10	180 mm	16 mm	10 mm	HS8	ISO 4762	<b>0083 10 180</b>	50
M10	190 mm	16 mm	10 mm	HS8	ISO 4762	<b>0083 10 190</b>	50
M10	200 mm	16 mm	10 mm	HS8	ISO 4762	<b>0083 10 200</b>	50
M10	210 mm	16 mm	10 mm	HS8	ISO 4762	<b>0083 10 210</b>	25
M10	220 mm	16 mm	10 mm	HS8	ISO 4762	<b>0083 10 220</b>	25

Thread type x nominal diameter (d <sub>1</sub> )	Length (l <sub>1</sub> )	Head diameter (d <sub>k</sub> )	Head height (k <sub>1</sub> )	Internal drive (s <sub>1</sub> )	Standards	Art. no.	P. Qty.
M10	230 mm	16 mm	10 mm	HS8	ISO 4762	<b>0083 10 230</b>	10
M10	240 mm	16 mm	10 mm	HS8	ISO 4762	<b>0083 10 240</b>	25
M10	250 mm	16 mm	10 mm	HS8	ISO 4762	<b>0083 10 250</b>	25
M10	260 mm	16 mm	10 mm	HS8	ISO 4762	<b>0083 10 260</b>	10
M10	270 mm	16 mm	10 mm	HS8	ISO 4762	<b>0083 10 270</b>	10
M10	280 mm	16 mm	10 mm	HS8	ISO 4762	<b>0083 10 280</b>	50
M10	290 mm	16 mm	10 mm	HS8	ISO 4762	<b>0083 10 290</b>	25
M10	300 mm	16 mm	10 mm	HS8	ISO 4762	<b>0083 10 300</b>	25
M10	310 mm	16 mm	10 mm	HS8	ISO 4762	<b>0083 10 310</b>	50
M10	320 mm	16 mm	10 mm	HS8	ISO 4762	<b>0083 10 320</b>	10
M10	330 mm	16 mm	10 mm	HS8	ISO 4762	<b>0083 10 330</b>	10
M10	340 mm	16 mm	10 mm	HS8	ISO 4762	<b>0083 10 340</b>	10
M10	360 mm	16 mm	10 mm	HS8	ISO 4762	<b>0083 10 360</b>	10
M10	380 mm	16 mm	10 mm	HS8	ISO 4762	<b>0083 10 380</b>	5
M10	390 mm	16 mm	10 mm	HS8	ISO 4762	<b>0083 10 390</b>	10
M12	16 mm	18 mm	12 mm	HS10	ISO 4762	<b>0083 12 16</b>	100
M12	20 mm	18 mm	12 mm	HS10	ISO 4762	<b>0083 12 20</b>	100/200
M12	22 mm	18 mm	12 mm	HS10	ISO 4762	<b>0083 12 22</b>	200
M12	25 mm	18 mm	12 mm	HS10	ISO 4762	<b>0083 12 25</b>	100/200
M12	30 mm	18 mm	12 mm	HS10	ISO 4762	<b>0083 12 30</b>	100
M12	35 mm	18 mm	12 mm	HS10	ISO 4762	<b>0083 12 35</b>	100
M12	40 mm	18 mm	12 mm	HS10	ISO 4762	<b>0083 12 40</b>	100
M12	45 mm	18 mm	12 mm	HS10	ISO 4762	<b>0083 12 45</b>	100
M12	50 mm	18 mm	12 mm	HS10	ISO 4762	<b>0083 12 50</b>	100
M12	55 mm	18 mm	12 mm	HS10	ISO 4762	<b>0083 12 55</b>	100
M12	60 mm	18 mm	12 mm	HS10	ISO 4762	<b>0083 12 60</b>	100
M12	65 mm	18 mm	12 mm	HS10	ISO 4762	<b>0083 12 65</b>	50
M12	70 mm	18 mm	12 mm	HS10	ISO 4762	<b>0083 12 70</b>	50
M12	75 mm	18 mm	12 mm	HS10	ISO 4762	<b>0083 12 75</b>	25/50
M12	80 mm	18 mm	12 mm	HS10	ISO 4762	<b>0083 12 80</b>	50
M12	85 mm	18 mm	12 mm	HS10	ISO 4762	<b>0083 12 85</b>	50
M12	90 mm	18 mm	12 mm	HS10	ISO 4762	<b>0083 12 90</b>	50
M12	95 mm	18 mm	12 mm	HS10	ISO 4762	<b>0083 12 95</b>	50
M12	100 mm	18 mm	12 mm	HS10	ISO 4762	<b>0083 12 100</b>	50
M12	105 mm	18 mm	12 mm	HS10	ISO 4762	<b>0083 12 105</b>	100
M12	110 mm	18 mm	12 mm	HS10	ISO 4762	<b>0083 12 110</b>	50
M12	115 mm	18 mm	12 mm	HS10	ISO 4762	<b>0083 12 115</b>	50
M12	120 mm	18 mm	12 mm	HS10	ISO 4762	<b>0083 12 120</b>	50
M12	125 mm	18 mm	12 mm	HS10	ISO 4762	<b>0083 12 125</b>	50
M12	130 mm	18 mm	12 mm	HS10	ISO 4762	<b>0083 12 130</b>	25/50
M12	140 mm	18 mm	12 mm	HS10	ISO 4762	<b>0083 12 140</b>	25/50
M12	150 mm	18 mm	12 mm	HS10	ISO 4762	<b>0083 12 150</b>	25/50
M12	160 mm	18 mm	12 mm	HS10	ISO 4762	<b>0083 12 160</b>	25
M12	170 mm	18 mm	12 mm	HS10	ISO 4762	<b>0083 12 170</b>	25
M12	175 mm	18 mm	12 mm	HS10	ISO 4762	<b>0083 12 175</b>	10
M12	180 mm	18 mm	12 mm	HS10	ISO 4762	<b>0083 12 180</b>	1/10/25
M12	190 mm	18 mm	12 mm	HS10	ISO 4762	<b>0083 12 190</b>	25
M12	200 mm	18 mm	12 mm	HS10	ISO 4762	<b>0083 12 200</b>	50
M12	210 mm	18 mm	12 mm	HS10	ISO 4762	<b>0083 12 210</b>	25
M12	220 mm	18 mm	12 mm	HS10	ISO 4762	<b>0083 12 220</b>	25
M12	230 mm	18 mm	12 mm	HS10	ISO 4762	<b>0083 12 230</b>	25
M12	235 mm	18 mm	12 mm	HS10	ISO 4762	<b>0083 12 235</b>	10
M12	240 mm	18 mm	12 mm	HS10	ISO 4762	<b>0083 12 240</b>	25

Thread type x nominal diameter (d <sub>1</sub> )	Length (l <sub>1</sub> )	Head diameter (d <sub>k</sub> )	Head height (k <sub>1</sub> )	Internal drive (s <sub>1</sub> )	Standards	Art. no.	P. Qty.
M12	250 mm	18 mm	12 mm	HS10	ISO 4762	<b>0083 12 250</b>	25
M12	260 mm	18 mm	12 mm	HS10	ISO 4762	<b>0083 12 260</b>	25
M12	270 mm	18 mm	12 mm	HS10	ISO 4762	<b>0083 12 270</b>	25
M12	280 mm	18 mm	12 mm	HS10	ISO 4762	<b>0083 12 280</b>	25
M12	300 mm	18 mm	12 mm	HS10	ISO 4762	<b>0083 12 300</b>	25
M12	305 mm	18 mm	12 mm	HS10	ISO 4762	<b>0083 12 305</b>	10
M12	310 mm	18 mm	12 mm	HS10	ISO 4762	<b>0083 12 310</b>	25
M12	320 mm	18 mm	12 mm	HS10	ISO 4762	<b>0083 12 320</b>	10
M12	370 mm	18 mm	12 mm	HS10	ISO 4762	<b>0083 12 370</b>	5
M12	380 mm	18 mm	12 mm	HS10	ISO 4762	<b>0083 12 380</b>	10
M12	500 mm	18 mm	12 mm	HS10	ISO 4762	<b>0083 12 500</b>	1
M12	550 mm	18 mm	12 mm	HS10	ISO 4762	<b>0083 12 550</b>	10
M14	20 mm	21 mm	14 mm	HS12	ISO 4762	<b>0083 14 20</b>	100
M14	22 mm	21 mm	14 mm	HS12	ISO 4762	<b>0083 14 22</b>	50
M14	25 mm	21 mm	14 mm	HS12	ISO 4762	<b>0083 14 25</b>	100
M14	30 mm	21 mm	14 mm	HS12	ISO 4762	<b>0083 14 30</b>	100
M14	35 mm	21 mm	14 mm	HS12	ISO 4762	<b>0083 14 35</b>	100
M14	40 mm	21 mm	14 mm	HS12	ISO 4762	<b>0083 14 40</b>	100
M14	45 mm	21 mm	14 mm	HS12	ISO 4762	<b>0083 14 45</b>	50
M14	50 mm	21 mm	14 mm	HS12	ISO 4762	<b>0083 14 50</b>	50
M14	55 mm	21 mm	14 mm	HS12	ISO 4762	<b>0083 14 55</b>	50
M14	60 mm	21 mm	14 mm	HS12	ISO 4762	<b>0083 14 60</b>	50
M14	65 mm	21 mm	14 mm	HS12	ISO 4762	<b>0083 14 65</b>	50
M14	70 mm	21 mm	14 mm	HS12	ISO 4762	<b>0083 14 70</b>	50
M14	75 mm	21 mm	14 mm	HS12	ISO 4762	<b>0083 14 75</b>	25
M14	80 mm	21 mm	14 mm	HS12	ISO 4762	<b>0083 14 80</b>	50
M14	90 mm	21 mm	14 mm	HS12	ISO 4762	<b>0083 14 90</b>	50
M14	100 mm	21 mm	14 mm	HS12	ISO 4762	<b>0083 14 100</b>	50
M14	110 mm	21 mm	14 mm	HS12	ISO 4762	<b>0083 14 110</b>	50
M14	120 mm	21 mm	14 mm	HS12	ISO 4762	<b>0083 14 120</b>	50
M14	130 mm	21 mm	14 mm	HS12	ISO 4762	<b>0083 14 130</b>	25
M14	140 mm	21 mm	14 mm	HS12	ISO 4762	<b>0083 14 140</b>	25
M14	145 mm	21 mm	14 mm	HS12	ISO 4762	<b>0083 14 145</b>	50
M14	150 mm	21 mm	14 mm	HS12	ISO 4762	<b>0083 14 150</b>	25
M14	160 mm	21 mm	14 mm	HS12	ISO 4762	<b>0083 14 160</b>	25
M14	165 mm	21 mm	14 mm	HS12	ISO 4762	<b>0083 14 165</b>	50
M14	170 mm	21 mm	14 mm	HS12	ISO 4762	<b>0083 14 170</b>	25
M14	180 mm	21 mm	14 mm	HS12	ISO 4762	<b>0083 14 180</b>	25
M14	190 mm	21 mm	14 mm	HS12	ISO 4762	<b>0083 14 190</b>	25
M14	200 mm	21 mm	14 mm	HS12	ISO 4762	<b>0083 14 200</b>	25
M14	210 mm	21 mm	14 mm	HS12	ISO 4762	<b>0083 14 210</b>	10
M14	220 mm	21 mm	14 mm	HS12	ISO 4762	<b>0083 14 220</b>	10
M14	260 mm	21 mm	14 mm	HS12	ISO 4762	<b>0083 14 260</b>	25
M14	270 mm	21 mm	14 mm	HS12	ISO 4762	<b>0083 14 270</b>	5
M14	280 mm	21 mm	14 mm	HS12	ISO 4762	<b>0083 14 280</b>	25
M16	20 mm	24 mm	16 mm	HS14	ISO 4762	<b>0083 16 20</b>	50
M16	22 mm	24 mm	16 mm	HS14	ISO 4762	<b>0083 16 22</b>	50
M16	25 mm	24 mm	16 mm	HS14	ISO 4762	<b>0083 16 25</b>	50
M16	30 mm	24 mm	16 mm	HS14	ISO 4762	<b>0083 16 30</b>	50/100
M16	35 mm	24 mm	16 mm	HS14	ISO 4762	<b>0083 16 35</b>	50
M16	40 mm	24 mm	16 mm	HS14	ISO 4762	<b>0083 16 40</b>	50
M16	45 mm	24 mm	16 mm	HS14	ISO 4762	<b>0083 16 45</b>	50
M16	50 mm	24 mm	16 mm	HS14	ISO 4762	<b>0083 16 50</b>	50

Thread type x nominal diameter (d <sub>1</sub> )	Length (l <sub>1</sub> )	Head diameter (d <sub>k</sub> )	Head height (k <sub>1</sub> )	Internal drive (s <sub>1</sub> )	Standards	Art. no.	P. Qty.
M16	55 mm	24 mm	16 mm	HS14	ISO 4762	<b>0083 16 55</b>	50
M16	60 mm	24 mm	16 mm	HS14	ISO 4762	<b>0083 16 60</b>	50
M16	65 mm	24 mm	16 mm	HS14	ISO 4762	<b>0083 16 65</b>	25/50
M16	70 mm	24 mm	16 mm	HS14	ISO 4762	<b>0083 16 70</b>	25
M16	75 mm	24 mm	16 mm	HS14	ISO 4762	<b>0083 16 75</b>	50
M16	80 mm	24 mm	16 mm	HS14	ISO 4762	<b>0083 16 80</b>	25
M16	85 mm	24 mm	16 mm	HS14	ISO 4762	<b>0083 16 85</b>	25
M16	90 mm	24 mm	16 mm	HS14	ISO 4762	<b>0083 16 90</b>	25
M16	95 mm	24 mm	16 mm	HS14	ISO 4762	<b>0083 16 95</b>	25
M16	100 mm	24 mm	16 mm	HS14	ISO 4762	<b>0083 16 100</b>	25/50
M16	110 mm	24 mm	16 mm	HS14	ISO 4762	<b>0083 16 110</b>	25
M16	120 mm	24 mm	16 mm	HS14	ISO 4762	<b>0083 16 120</b>	25
M16	130 mm	24 mm	16 mm	HS14	ISO 4762	<b>0083 16 130</b>	25
M16	140 mm	24 mm	16 mm	HS14	ISO 4762	<b>0083 16 140</b>	25
M16	150 mm	24 mm	16 mm	HS14	ISO 4762	<b>0083 16 150</b>	15/25
M16	160 mm	24 mm	16 mm	HS14	ISO 4762	<b>0083 16 160</b>	15/25
M16	170 mm	24 mm	16 mm	HS14	ISO 4762	<b>0083 16 170</b>	10/25
M16	180 mm	24 mm	16 mm	HS14	ISO 4762	<b>0083 16 180</b>	1/10/25
M16	190 mm	24 mm	16 mm	HS14	ISO 4762	<b>0083 16 190</b>	25
M16	200 mm	24 mm	16 mm	HS14	ISO 4762	<b>0083 16 200</b>	25
M16	210 mm	24 mm	16 mm	HS14	ISO 4762	<b>0083 16 210</b>	10
M16	220 mm	24 mm	16 mm	HS14	ISO 4762	<b>0083 16 220</b>	10
M16	230 mm	24 mm	16 mm	HS14	ISO 4762	<b>0083 16 230</b>	10
M16	250 mm	24 mm	16 mm	HS14	ISO 4762	<b>0083 16 250</b>	25
M16	260 mm	24 mm	16 mm	HS14	ISO 4762	<b>0083 16 260</b>	25
M16	270 mm	24 mm	16 mm	HS14	ISO 4762	<b>0083 16 270</b>	25
M16	280 mm	24 mm	16 mm	HS14	ISO 4762	<b>0083 16 280</b>	25
M16	290 mm	24 mm	16 mm	HS14	ISO 4762	<b>0083 16 290</b>	10
M16	300 mm	24 mm	16 mm	HS14	ISO 4762	<b>0083 16 300</b>	10
M16	320 mm	24 mm	16 mm	HS14	ISO 4762	<b>0083 16 320</b>	10
M16	340 mm	24 mm	16 mm	HS14	ISO 4762	<b>0083 16 340</b>	10
M16	370 mm	24 mm	16 mm	HS14	ISO 4762	<b>0083 16 370</b>	1/10
M16	380 mm	24 mm	16 mm	HS14	ISO 4762	<b>0083 16 380</b>	10
M16	400 mm	24 mm	16 mm	HS14	ISO 4762	<b>0083 16 400</b>	10
M16	420 mm	24 mm	16 mm	HS14	ISO 4762	<b>0083 16 420</b>	10
M16	440 mm	24 mm	16 mm	HS14	ISO 4762	<b>0083 16 440</b>	5
M16	450 mm	24 mm	16 mm	HS14	ISO 4762	<b>0083 16 450</b>	1
M16	460 mm	24 mm	16 mm	HS14	ISO 4762	<b>0083 16 460</b>	5
M18	30 mm	27 mm	18 mm	HS14	DIN 912	<b>0083 18 30</b>	25
M18	35 mm	27 mm	18 mm	HS14	DIN 912	<b>0083 18 35</b>	25
M18	40 mm	27 mm	18 mm	HS14	DIN 912	<b>0083 18 40</b>	25
M18	45 mm	27 mm	18 mm	HS14	DIN 912	<b>0083 18 45</b>	25
M18	50 mm	27 mm	18 mm	HS14	DIN 912	<b>0083 18 50</b>	25
M18	55 mm	27 mm	18 mm	HS14	DIN 912	<b>0083 18 55</b>	25
M18	60 mm	27 mm	18 mm	HS14	DIN 912	<b>0083 18 60</b>	25
M18	65 mm	27 mm	18 mm	HS14	DIN 912	<b>0083 18 65</b>	10
M18	70 mm	27 mm	18 mm	HS14	DIN 912	<b>0083 18 70</b>	25
M18	75 mm	27 mm	18 mm	HS14	DIN 912	<b>0083 18 75</b>	25
M18	80 mm	27 mm	18 mm	HS14	DIN 912	<b>0083 18 80</b>	25
M18	90 mm	27 mm	18 mm	HS14	DIN 912	<b>0083 18 90</b>	25
M18	100 mm	27 mm	18 mm	HS14	DIN 912	<b>0083 18 100</b>	25
M18	110 mm	27 mm	18 mm	HS14	DIN 912	<b>0083 18 110</b>	25
M18	120 mm	27 mm	18 mm	HS14	DIN 912	<b>0083 18 120</b>	25



Thread type x nominal diameter (d <sub>1</sub> )	Length (l <sub>1</sub> )	Head diameter (d <sub>k</sub> )	Head height (k <sub>1</sub> )	Internal drive (s <sub>1</sub> )	Standards	Art. no.	P. Qty.
M18	130 mm	27 mm	18 mm	HS14	DIN 912	<b>0083 18 130</b>	50
M18	140 mm	27 mm	18 mm	HS14	DIN 912	<b>0083 18 140</b>	25
M18	150 mm	27 mm	18 mm	HS14	DIN 912	<b>0083 18 150</b>	50
M18	160 mm	27 mm	18 mm	HS14	DIN 912	<b>0083 18 160</b>	25
M18	170 mm	27 mm	18 mm	HS14	DIN 912	<b>0083 18 170</b>	25
M18	200 mm	27 mm	18 mm	HS14	DIN 912	<b>0083 18 200</b>	25
M18	210 mm	27 mm	18 mm	HS14	DIN 912	<b>0083 18 210</b>	1
M18	240 mm	27 mm	18 mm	HS14	DIN 912	<b>0083 18 240</b>	10
M18	260 mm	27 mm	18 mm	HS14	DIN 912	<b>0083 18 260</b>	10
M20	20 mm	30 mm	20 mm	HS17	ISO 4762	<b>0083 20 20</b>	1
M20	30 mm	30 mm	20 mm	HS17	ISO 4762	<b>0083 20 30</b>	50
M20	35 mm	30 mm	20 mm	HS17	ISO 4762	<b>0083 20 35</b>	50
M20	40 mm	30 mm	20 mm	HS17	ISO 4762	<b>0083 20 40</b>	25
M20	45 mm	30 mm	20 mm	HS17	ISO 4762	<b>0083 20 45</b>	25
M20	50 mm	30 mm	20 mm	HS17	ISO 4762	<b>0083 20 50</b>	25
M20	55 mm	30 mm	20 mm	HS17	ISO 4762	<b>0083 20 55</b>	25
M20	60 mm	30 mm	20 mm	HS17	ISO 4762	<b>0083 20 60</b>	25
M20	65 mm	30 mm	20 mm	HS17	ISO 4762	<b>0083 20 65</b>	25
M20	70 mm	30 mm	20 mm	HS17	ISO 4762	<b>0083 20 70</b>	25
M20	75 mm	30 mm	20 mm	HS17	ISO 4762	<b>0083 20 75</b>	25
M20	80 mm	30 mm	20 mm	HS17	ISO 4762	<b>0083 20 80</b>	25
M20	85 mm	30 mm	20 mm	HS17	ISO 4762	<b>0083 20 85</b>	25
M20	90 mm	30 mm	20 mm	HS17	ISO 4762	<b>0083 20 90</b>	25
M20	95 mm	30 mm	20 mm	HS17	ISO 4762	<b>0083 20 95</b>	10
M20	100 mm	30 mm	20 mm	HS17	ISO 4762	<b>0083 20 100</b>	25
M20	110 mm	30 mm	20 mm	HS17	ISO 4762	<b>0083 20 110</b>	25
M20	120 mm	30 mm	20 mm	HS17	ISO 4762	<b>0083 20 120</b>	25
M20	130 mm	30 mm	20 mm	HS17	ISO 4762	<b>0083 20 130</b>	25
M20	140 mm	30 mm	20 mm	HS17	ISO 4762	<b>0083 20 140</b>	25
M20	150 mm	30 mm	20 mm	HS17	ISO 4762	<b>0083 20 150</b>	25
M20	160 mm	30 mm	20 mm	HS17	ISO 4762	<b>0083 20 160</b>	10/25
M20	170 mm	30 mm	20 mm	HS17	ISO 4762	<b>0083 20 170</b>	10
M20	180 mm	30 mm	20 mm	HS17	ISO 4762	<b>0083 20 180</b>	10
M20	190 mm	30 mm	20 mm	HS17	ISO 4762	<b>0083 20 190</b>	10
M20	200 mm	30 mm	20 mm	HS17	ISO 4762	<b>0083 20 200</b>	25
M20	210 mm	30 mm	20 mm	HS17	ISO 4762	<b>0083 20 210</b>	10
M20	220 mm	30 mm	20 mm	HS17	ISO 4762	<b>0083 20 220</b>	10
M20	230 mm	30 mm	20 mm	HS17	ISO 4762	<b>0083 20 230</b>	10
M20	240 mm	30 mm	20 mm	HS17	ISO 4762	<b>0083 20 240</b>	10
M20	250 mm	30 mm	20 mm	HS17	ISO 4762	<b>0083 20 250</b>	10
M20	260 mm	30 mm	20 mm	HS17	ISO 4762	<b>0083 20 260</b>	25
M20	270 mm	30 mm	20 mm	HS17	ISO 4762	<b>0083 20 270</b>	10
M20	280 mm	30 mm	20 mm	HS17	ISO 4762	<b>0083 20 280</b>	10
M20	290 mm	30 mm	20 mm	HS17	ISO 4762	<b>0083 20 290</b>	10
M20	300 mm	30 mm	20 mm	HS17	ISO 4762	<b>0083 20 300</b>	10
M20	310 mm	30 mm	20 mm	HS17	ISO 4762	<b>0083 20 310</b>	5
M20	320 mm	30 mm	20 mm	HS17	ISO 4762	<b>0083 20 320</b>	10
M20	330 mm	30 mm	20 mm	HS17	ISO 4762	<b>0083 20 330</b>	10
M20	340 mm	30 mm	20 mm	HS17	ISO 4762	<b>0083 20 340</b>	10
M20	360 mm	30 mm	20 mm	HS17	ISO 4762	<b>0083 20 360</b>	10
M20	370 mm	30 mm	20 mm	HS17	ISO 4762	<b>0083 20 370</b>	1
M20	410 mm	30 mm	20 mm	HS17	ISO 4762	<b>0083 20 410</b>	10
M20	420 mm	30 mm	20 mm	HS17	ISO 4762	<b>0083 20 420</b>	10

Thread type x nominal diameter (d <sub>1</sub> )	Length (l <sub>1</sub> )	Head diameter (d <sub>k</sub> )	Head height (k <sub>1</sub> )	Internal drive (s <sub>1</sub> )	Standards	Art. no.	P. Qty.
M20	430 mm	30 mm	20 mm	HS17	ISO 4762	<b>0083 20 430</b>	10
M20	440 mm	30 mm	20 mm	HS17	ISO 4762	<b>0083 20 440</b>	15
M20	450 mm	30 mm	20 mm	HS17	ISO 4762	<b>0083 20 450</b>	1
M20	460 mm	30 mm	20 mm	HS17	ISO 4762	<b>0083 20 460</b>	10
M20	480 mm	30 mm	20 mm	HS17	ISO 4762	<b>0083 20 480</b>	10
M20	500 mm	30 mm	20 mm	HS17	ISO 4762	<b>0083 20 500</b>	10
M20	510 mm	30 mm	20 mm	HS17	ISO 4762	<b>0083 20 510</b>	10
M20	520 mm	30 mm	20 mm	HS17	ISO 4762	<b>0083 20 520</b>	10
M20	530 mm	30 mm	20 mm	HS17	ISO 4762	<b>0083 20 530</b>	10
M22	50 mm	33 mm	22 mm	HS17	DIN 912	<b>0083 22 50</b>	25
M22	60 mm	33 mm	22 mm	HS17	DIN 912	<b>0083 22 60</b>	25
M22	65 mm	33 mm	22 mm	HS17	DIN 912	<b>0083 22 65</b>	25
M22	75 mm	33 mm	22 mm	HS17	DIN 912	<b>0083 22 75</b>	10
M22	80 mm	33 mm	22 mm	HS17	DIN 912	<b>0083 22 80</b>	25
M22	90 mm	33 mm	22 mm	HS17	DIN 912	<b>0083 22 90</b>	25
M22	100 mm	33 mm	22 mm	HS17	DIN 912	<b>0083 22 100</b>	10
M22	110 mm	33 mm	22 mm	HS17	DIN 912	<b>0083 22 110</b>	5
M22	120 mm	33 mm	22 mm	HS17	DIN 912	<b>0083 22 120</b>	25
M22	130 mm	33 mm	22 mm	HS17	DIN 912	<b>0083 22 130</b>	10
M22	140 mm	33 mm	22 mm	HS17	DIN 912	<b>0083 22 140</b>	10
M22	150 mm	33 mm	22 mm	HS17	DIN 912	<b>0083 22 150</b>	25
M22	160 mm	33 mm	22 mm	HS17	DIN 912	<b>0083 22 160</b>	10
M22	180 mm	33 mm	22 mm	HS17	DIN 912	<b>0083 22 180</b>	10
M22	200 mm	33 mm	22 mm	HS17	DIN 912	<b>0083 22 200</b>	10
M22	220 mm	33 mm	22 mm	HS17	DIN 912	<b>0083 22 220</b>	10
M22	240 mm	33 mm	22 mm	HS17	DIN 912	<b>0083 22 240</b>	25
M22	250 mm	33 mm	22 mm	HS17	DIN 912	<b>0083 22 250</b>	10
M22	300 mm	33 mm	22 mm	HS17	DIN 912	<b>0083 22 300</b>	10
M24	30 mm	36 mm	24 mm	HS19	ISO 4762	<b>0083 24 30</b>	25
M24	40 mm	36 mm	24 mm	HS19	ISO 4762	<b>0083 24 40</b>	25
M24	45 mm	36 mm	24 mm	HS19	ISO 4762	<b>0083 24 45</b>	25
M24	50 mm	36 mm	24 mm	HS19	ISO 4762	<b>0083 24 50</b>	25
M24	55 mm	36 mm	24 mm	HS19	ISO 4762	<b>0083 24 55</b>	25
M24	60 mm	36 mm	24 mm	HS19	ISO 4762	<b>0083 24 60</b>	1/10
M24	65 mm	36 mm	24 mm	HS19	ISO 4762	<b>0083 24 65</b>	25
M24	70 mm	36 mm	24 mm	HS19	ISO 4762	<b>0083 24 70</b>	10
M24	75 mm	36 mm	24 mm	HS19	ISO 4762	<b>0083 24 75</b>	25
M24	80 mm	36 mm	24 mm	HS19	ISO 4762	<b>0083 24 80</b>	10
M24	90 mm	36 mm	24 mm	HS19	ISO 4762	<b>0083 24 90</b>	1/10
M24	100 mm	36 mm	24 mm	HS19	ISO 4762	<b>0083 24 100</b>	1/10
M24	105 mm	36 mm	24 mm	HS19	ISO 4762	<b>0083 24 105</b>	5
M24	110 mm	36 mm	24 mm	HS19	ISO 4762	<b>0083 24 110</b>	25
M24	120 mm	36 mm	24 mm	HS19	ISO 4762	<b>0083 24 120</b>	1/10
M24	130 mm	36 mm	24 mm	HS19	ISO 4762	<b>0083 24 130</b>	15
M24	140 mm	36 mm	24 mm	HS19	ISO 4762	<b>0083 24 140</b>	10
M24	160 mm	36 mm	24 mm	HS19	ISO 4762	<b>0083 24 160</b>	10
M24	170 mm	36 mm	24 mm	HS19	ISO 4762	<b>0083 24 170</b>	10
M24	175 mm	36 mm	24 mm	HS19	ISO 4762	<b>0083 24 175</b>	10
M24	180 mm	36 mm	24 mm	HS19	ISO 4762	<b>0083 24 180</b>	10
M24	190 mm	36 mm	24 mm	HS19	ISO 4762	<b>0083 24 190</b>	10
M24	200 mm	36 mm	24 mm	HS19	ISO 4762	<b>0083 24 200</b>	10
M24	220 mm	36 mm	24 mm	HS19	ISO 4762	<b>0083 24 220</b>	10
M24	230 mm	36 mm	24 mm	HS19	ISO 4762	<b>0083 24 230</b>	10

Thread type x nominal diameter (d <sub>1</sub> )	Length (l <sub>1</sub> )	Head diameter (d <sub>k</sub> )	Head height (k <sub>1</sub> )	Internal drive (s <sub>1</sub> )	Standards	Art. no.	P. Qty.
M24	240 mm	36 mm	24 mm	HS19	ISO 4762	<b>0083 24 240</b>	10
M24	260 mm	36 mm	24 mm	HS19	ISO 4762	<b>0083 24 260</b>	10
M24	280 mm	36 mm	24 mm	HS19	ISO 4762	<b>0083 24 280</b>	10
M24	290 mm	36 mm	24 mm	HS19	ISO 4762	<b>0083 24 290</b>	10
M24	300 mm	36 mm	24 mm	HS19	ISO 4762	<b>0083 24 300</b>	10
M24	310 mm	36 mm	24 mm	HS19	ISO 4762	<b>0083 24 310</b>	10
M24	320 mm	36 mm	24 mm	HS19	ISO 4762	<b>0083 24 320</b>	5
M24	330 mm	36 mm	24 mm	HS19	ISO 4762	<b>0083 24 330</b>	10
M24	340 mm	36 mm	24 mm	HS19	ISO 4762	<b>0083 24 340</b>	10
M24	350 mm	36 mm	24 mm	HS19	ISO 4762	<b>0083 24 350</b>	10
M24	360 mm	36 mm	24 mm	HS19	ISO 4762	<b>0083 24 360</b>	10
M24	370 mm	36 mm	24 mm	HS19	ISO 4762	<b>0083 24 370</b>	1
M24	380 mm	36 mm	24 mm	HS19	ISO 4762	<b>0083 24 380</b>	10
M24	400 mm	36 mm	24 mm	HS19	ISO 4762	<b>0083 24 400</b>	10
M24	440 mm	36 mm	24 mm	HS19	ISO 4762	<b>0083 24 440</b>	5
M24	550 mm	36 mm	24 mm	HS19	ISO 4762	<b>0083 24 550</b>	10
M24	600 mm	36 mm	24 mm	HS19	ISO 4762	<b>0083 24 600</b>	2
M27	50 mm	40 mm	27 mm	HS19	DIN 912	<b>0083 27 50</b>	10
M27	55 mm	40 mm	27 mm	HS19	DIN 912	<b>0083 27 55</b>	10
M27	60 mm	40 mm	27 mm	HS19	DIN 912	<b>0083 27 60</b>	10
M27	65 mm	40 mm	27 mm	HS19	DIN 912	<b>0083 27 65</b>	10
M27	70 mm	40 mm	27 mm	HS19	DIN 912	<b>0083 27 70</b>	10
M27	80 mm	40 mm	27 mm	HS19	DIN 912	<b>0083 27 80</b>	10
M27	90 mm	40 mm	27 mm	HS19	DIN 912	<b>0083 27 90</b>	10
M27	100 mm	40 mm	27 mm	HS19	DIN 912	<b>0083 27 100</b>	10
M27	110 mm	40 mm	27 mm	HS19	DIN 912	<b>0083 27 110</b>	10
M27	120 mm	40 mm	27 mm	HS19	DIN 912	<b>0083 27 120</b>	10
M27	130 mm	40 mm	27 mm	HS19	DIN 912	<b>0083 27 130</b>	10
M27	140 mm	40 mm	27 mm	HS19	DIN 912	<b>0083 27 140</b>	10
M27	150 mm	40 mm	27 mm	HS19	DIN 912	<b>0083 27 150</b>	10
M27	160 mm	40 mm	27 mm	HS19	DIN 912	<b>0083 27 160</b>	10
M27	170 mm	40 mm	27 mm	HS19	DIN 912	<b>0083 27 170</b>	10
M27	180 mm	40 mm	27 mm	HS19	DIN 912	<b>0083 27 180</b>	10
M27	190 mm	40 mm	27 mm	HS19	DIN 912	<b>0083 27 190</b>	10
M27	200 mm	40 mm	27 mm	HS19	DIN 912	<b>0083 27 200</b>	10
M27	220 mm	40 mm	27 mm	HS19	DIN 912	<b>0083 27 220</b>	10
M27	230 mm	40 mm	27 mm	HS19	DIN 912	<b>0083 27 230</b>	1
M27	240 mm	40 mm	27 mm	HS19	DIN 912	<b>0083 27 240</b>	1
M27	250 mm	40 mm	27 mm	HS19	DIN 912	<b>0083 27 250</b>	10
M27	260 mm	40 mm	27 mm	HS19	DIN 912	<b>0083 27 260</b>	15
M30	50 mm	45 mm	30 mm	HS22	ISO 4762	<b>0083 30 50</b>	10
M30	55 mm	45 mm	30 mm	HS22	ISO 4762	<b>0083 30 55</b>	10
M30	60 mm	45 mm	30 mm	HS22	ISO 4762	<b>0083 30 60</b>	10
M30	65 mm	45 mm	30 mm	HS22	ISO 4762	<b>0083 30 65</b>	10
M30	70 mm	45 mm	30 mm	HS22	ISO 4762	<b>0083 30 70</b>	10
M30	80 mm	45 mm	30 mm	HS22	ISO 4762	<b>0083 30 80</b>	10
M30	90 mm	45 mm	30 mm	HS22	ISO 4762	<b>0083 30 90</b>	10
M30	100 mm	45 mm	30 mm	HS22	ISO 4762	<b>0083 30 100</b>	10
M30	110 mm	45 mm	30 mm	HS22	ISO 4762	<b>0083 30 110</b>	10
M30	120 mm	45 mm	30 mm	HS22	ISO 4762	<b>0083 30 120</b>	10
M30	130 mm	45 mm	30 mm	HS22	ISO 4762	<b>0083 30 130</b>	10
M30	140 mm	45 mm	30 mm	HS22	ISO 4762	<b>0083 30 140</b>	5
M30	150 mm	45 mm	30 mm	HS22	ISO 4762	<b>0083 30 150</b>	10

Thread type x nominal diameter (d <sub>1</sub> )	Length (l <sub>1</sub> )	Head diameter (d <sub>k</sub> )	Head height (k <sub>1</sub> )	Internal drive (s <sub>1</sub> )	Standards	Art. no.	P. Qty.
M30	160 mm	45 mm	30 mm	HS22	ISO 4762	<b>0083 30 160</b>	10
M30	170 mm	45 mm	30 mm	HS22	ISO 4762	<b>0083 30 170</b>	10
M30	180 mm	45 mm	30 mm	HS22	ISO 4762	<b>0083 30 180</b>	10
M30	190 mm	45 mm	30 mm	HS22	ISO 4762	<b>0083 30 190</b>	10
M30	200 mm	45 mm	30 mm	HS22	ISO 4762	<b>0083 30 200</b>	10
M30	220 mm	45 mm	30 mm	HS22	ISO 4762	<b>0083 30 220</b>	10
M30	250 mm	45 mm	30 mm	HS22	ISO 4762	<b>0083 30 250</b>	1
M30	280 mm	45 mm	30 mm	HS22	ISO 4762	<b>0083 30 270</b>	5
M30	280 mm	45 mm	30 mm	HS22	ISO 4762	<b>0083 30 280</b>	5
M30	290 mm	45 mm	20 mm	HS22	DIN 912	<b>0083 30 290</b>	1
M30	300 mm	45 mm	30 mm	HS22	ISO 4762	<b>0083 30 300</b>	5/10
M30	320 mm	45 mm	30 mm	HS22	ISO 4762	<b>0083 30 320</b>	10
M30	330 mm	45 mm	30 mm	HS22	ISO 4762	<b>0083 30 330</b>	5
M30	360 mm	45 mm	30 mm	HS22	ISO 4762	<b>0083 30 360</b>	10
M30	380 mm	45 mm	30 mm	HS22	ISO 4762	<b>0083 30 380</b>	10
M30	420 mm	45 mm	30 mm	HS22	ISO 4762	<b>0083 30 420</b>	1
M30	460 mm	45 mm	30 mm	HS22	ISO 4762	<b>0083 30 460</b>	1
M30	470 mm	45 mm	30 mm	HS22	ISO 4762	<b>0083 30 470</b>	1
M30	500 mm	45 mm	30 mm	HS22	ISO 4762	<b>0083 30 500</b>	1
M30	540 mm	45 mm	30 mm	HS22	ISO 4762	<b>0083 30 540</b>	1
M30	560 mm	45 mm	30 mm	HS22	ISO 4762	<b>0083 30 560</b>	5
M33	100 mm	50 mm	33 mm	HS24	DIN 912	<b>0083 33 100</b>	10
M33	110 mm	50 mm	33 mm	HS24	DIN 912	<b>0083 33 110</b>	1
M33	130 mm	50 mm	33 mm	HS24	DIN 912	<b>0083 33 130</b>	10
M33	140 mm	50 mm	33 mm	HS24	DIN 912	<b>0083 33 140</b>	1
M33	150 mm	50 mm	33 mm	HS24	DIN 912	<b>0083 33 150</b>	1
M33	200 mm	50 mm	33 mm	HS24	DIN 912	<b>0083 33 200</b>	10
M33	260 mm	50 mm	33 mm	HS24	DIN 912	<b>0083 33 260</b>	10
M36	50 mm	54 mm	36 mm	HS27	ISO 4762	<b>0083 36 50</b>	10
M36	55 mm	54 mm	36 mm	HS27	ISO 4762	<b>0083 36 55</b>	10
M36	60 mm	54 mm	36 mm	HS27	ISO 4762	<b>0083 36 60</b>	10
M36	65 mm	54 mm	36 mm	HS27	ISO 4762	<b>0083 36 65</b>	10
M36	70 mm	54 mm	36 mm	HS27	ISO 4762	<b>0083 36 70</b>	10
M36	90 mm	54 mm	36 mm	HS27	ISO 4762	<b>0083 36 90</b>	10
M36	110 mm	54 mm	36 mm	HS27	ISO 4762	<b>0083 36 110</b>	10
M36	120 mm	54 mm	36 mm	HS27	ISO 4762	<b>0083 36 120</b>	10
M36	130 mm	54 mm	36 mm	HS27	ISO 4762	<b>0083 36 130</b>	10
M36	150 mm	54 mm	36 mm	HS27	ISO 4762	<b>0083 36 150</b>	5
M36	160 mm	54 mm	36 mm	HS27	ISO 4762	<b>0083 36 160</b>	10
M36	220 mm	54 mm	36 mm	HS27	ISO 4762	<b>0083 36 220</b>	10
M36	240 mm	54 mm	36 mm	HS27	ISO 4762	<b>0083 36 240</b>	5
M36	250 mm	54 mm	36 mm	HS27	ISO 4762	<b>0083 36 250</b>	1
M36	260 mm	54 mm	36 mm	HS27	ISO 4762	<b>0083 36 260</b>	10
M36	270 mm	54 mm	36 mm	HS27	ISO 4762	<b>0083 36 270</b>	10
M36	280 mm	54 mm	36 mm	HS27	ISO 4762	<b>0083 36 280</b>	5
M36	320 mm	54 mm	36 mm	HS27	ISO 4762	<b>0083 36 320</b>	5
M36	340 mm	54 mm	36 mm	HS27	ISO 4762	<b>0083 36 340</b>	1
M36	360 mm	54 mm	36 mm	HS27	ISO 4762	<b>0083 36 360</b>	1
M36	400 mm	54 mm	36 mm	HS27	ISO 4762	<b>0083 36 400</b>	5
M36	420 mm	54 mm	36 mm	HS27	ISO 4762	<b>0083 36 420</b>	1
M36	580 mm	54 mm	36 mm	HS27	ISO 4762	<b>0083 36 580</b>	1
M36	600 mm	54 mm	36 mm	HS27	ISO 4762	<b>0083 36 600</b>	1
M42	100 mm	63 mm	42 mm	HS32	ISO 4762	<b>0083 42 100</b>	10

Thread type x nominal diameter (d <sub>1</sub> )	Length (l <sub>1</sub> )	Head diameter (d <sub>k</sub> )	Head height (k <sub>1</sub> )	Internal drive (s <sub>1</sub> )	Standards	Art. no.	P. Qty.
M42	140 mm	63 mm	42 mm	HS32	ISO 4762	<b>0083 42 140</b>	1
M42	220 mm	63 mm	42 mm	HS32	ISO 4762	<b>0083 42 220</b>	1
M42	240 mm	63 mm	42 mm	HS32	ISO 4762	<b>0083 42 240</b>	1
M42	260 mm	63 mm	42 mm	HS32	ISO 4762	<b>0083 42 260</b>	1
M42	440 mm	63 mm	42 mm	HS32	ISO 4762	<b>0083 42 440</b>	1
M42	500 mm	63 mm	42 mm	HS32	ISO 4762	<b>0083 42 500</b>	2
M48	80 mm	72 mm	48 mm	HS36	ISO 4762	<b>0083 48 80</b>	1
M48	120 mm	72 mm	48 mm	HS36	ISO 4762	<b>0083 48 120</b>	5
M48	130 mm	72 mm	48 mm	HS36	ISO 4762	<b>0083 48 130</b>	1
M48	150 mm	72 mm	48 mm	HS36	ISO 4762	<b>0083 48 150</b>	5
M48	160 mm	72 mm	48 mm	HS36	ISO 4762	<b>0083 48 160</b>	1
M48	180 mm	72 mm	48 mm	HS36	ISO 4762	<b>0083 48 180</b>	1
M48	200 mm	72 mm	48 mm	HS36	ISO 4762	<b>0083 48 200</b>	1
M48	220 mm	72 mm	48 mm	HS36	ISO 4762	<b>0083 48 220</b>	5
M48	240 mm	72 mm	48 mm	HS36	ISO 4762	<b>0083 48 240</b>	1
M48	250 mm	72 mm	48 mm	HS36	ISO 4762	<b>0083 48 250</b>	1
M48	260 mm	72 mm	48 mm	HS36	ISO 4762	<b>0083 48 260</b>	5
M48	270 mm	72 mm	48 mm	HS36	ISO 4762	<b>0083 48 270</b>	1
M48	320 mm	72 mm	48 mm	HS36	ISO 4762	<b>0083 48 320</b>	1
M48	350 mm	72 mm	48 mm	HS36	ISO 4762	<b>0083 48 350</b>	5
M48	380 mm	72 mm	48 mm	HS36	ISO 4762	<b>0083 48 380</b>	5
M48	400 mm	72 mm	48 mm	HS36	ISO 4762	<b>0083 48 400</b>	1

### Notice

ISO 4762 replaces DIN 912 | There is some similarity | Nominal range changed | Fine thread moved to ISO 12474.