

Hexagon Socket Head Cap Screw

ISO 4762/DIN 912 stainless steel, A2-70, plain

Material	Stainless steel A2
Surface	Plain
Property class	70
RoHS-compliant	Yes

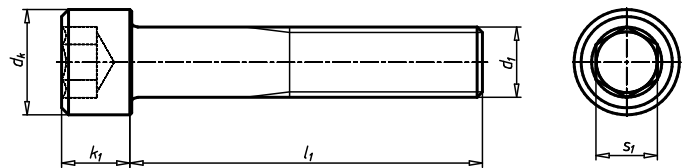

Thread type x nominal diameter (d ₁)	Length (l ₁)	Head diameter (d _k)	Head height (h ₁)	Internal drive (s ₁)	Standards	Art. no.	P. Qty.
M1.4	3 mm	2.6 mm	1.4 mm	HS1.3	DIN 912	0094 15 3	500
M1.4	4 mm	2.6 mm	1.4 mm	HS1.3	DIN 912	0094 15 4	500
M1.4	5 mm	2.6 mm	1.4 mm	HS1.3	DIN 912	0094 15 5	500
M1.4	6 mm	2.6 mm	1.4 mm	HS1.3	DIN 912	0094 15 6	500
M1.4	8 mm	2.6 mm	1.4 mm	HS1.3	DIN 912	0094 15 8	100
M1.4	10 mm	2.6 mm	1.4 mm	HS1.3	DIN 912	0094 15 10	1000
M1.6	3 mm	3 mm	1.6 mm	HS1.5	ISO 4762	0094 17 3	500
M1.6	4 mm	3 mm	1.6 mm	HS1.5	ISO 4762	0094 17 4	1000
M1.6	5 mm	3 mm	1.6 mm	HS1.5	ISO 4762	0094 17 5	1000
M1.6	6 mm	3 mm	1.6 mm	HS1.5	ISO 4762	0094 17 6	1000
M1.6	8 mm	3 mm	1.6 mm	HS1.5	ISO 4762	0094 17 8	1000
M1.6	16 mm	3 mm	1.6 mm	HS1.5	ISO 4762	0094 17 16	1000
M2	3 mm	3.8 mm	2 mm	HS1.5	ISO 4762	0094 2 3	1000
M2	4 mm	3.8 mm	2 mm	HS1.5	ISO 4762	0094 2 4	2000
M2	5 mm	3.8 mm	2 mm	HS1.5	ISO 4762	0094 2 5	1000
M2	6 mm	3.8 mm	2 mm	HS1.5	ISO 4762	0094 2 6	1000
M2	8 mm	3.8 mm	2 mm	HS1.5	ISO 4762	0094 2 8	1000
M2	10 mm	3.8 mm	2 mm	HS1.5	ISO 4762	0094 2 10	1000
M2	12 mm	3.8 mm	2 mm	HS1.5	ISO 4762	0094 2 12	1000
M2	14 mm	3.8 mm	2 mm	HS1.5	ISO 4762	0094 2 14	1000
M2	16 mm	3.8 mm	2 mm	HS1.5	ISO 4762	0094 2 16	1000
M2	18 mm	3.8 mm	2 mm	HS1.5	ISO 4762	0094 2 18	500
M2	20 mm	3.8 mm	2 mm	HS1.5	ISO 4762	0094 2 20	1000
M2	25 mm	3.8 mm	2 mm	HS1.5	ISO 4762	0094 2 25	1000
M2	35 mm	3.8 mm	2 mm	HS1.5	ISO 4762	0094 2 35	500
M2.5	3 mm	4.5 mm	2.5 mm	HS2	ISO 4762	0094 25 3	500
M2.5	4 mm	4.5 mm	2.5 mm	HS2	ISO 4762	0094 25 4	1000
M2.5	5 mm	4.5 mm	2.5 mm	HS2	ISO 4762	0094 25 5	1000
M2.5	6 mm	4.5 mm	2.5 mm	HS2	ISO 4762	0094 25 6	1000
M2.5	8 mm	4.5 mm	2.5 mm	HS2	ISO 4762	0094 25 8	1000
M2.5	10 mm	4.5 mm	2.5 mm	HS2	ISO 4762	0094 25 10	1000
M2.5	12 mm	4.5 mm	2.5 mm	HS2	ISO 4762	0094 25 12	1000
M2.5	14 mm	4.5 mm	2.5 mm	HS2	ISO 4762	0094 25 14	1000
M2.5	16 mm	4.5 mm	2.5 mm	HS2	ISO 4762	0094 25 16	1000

Thread type x nominal diameter (d ₁)	Length (l ₁)	Head diameter (d _k)	Head height (k ₁)	Internal drive (s ₁)	Standards	Art. no.	P. Qty.
M2.5	20 mm	4.5 mm	2.5 mm	HS2	ISO 4762	0094 25 20	1000
M2.5	25 mm	4.5 mm	2.5 mm	HS2	ISO 4762	0094 25 25	1000
M2.5	30 mm	4.5 mm	2.5 mm	HS2	ISO 4762	0094 25 30	500
M2.5	45 mm	4.5 mm	2.5 mm	HS2	ISO 4762	0094 25 45	100
M2.5	60 mm	4.5 mm	2.5 mm	HS2	ISO 4762	0094 25 60	500
M3	4 mm	5.5 mm	3 mm	HS2.5	ISO 4762	0094 3 4	1000
M3	5 mm	5.5 mm	3 mm	HS2.5	ISO 4762	0094 3 5	1000
M3	6 mm	5.5 mm	3 mm	HS2.5	ISO 4762	0094 3 6	1000 /2000
M3	8 mm	5.5 mm	3 mm	HS2.5	ISO 4762	0094 3 8	1000 /2000
M3	10 mm	5.5 mm	3 mm	HS2.5	ISO 4762	0094 3 10	1000
M3	12 mm	5.5 mm	3 mm	HS2.5	ISO 4762	0094 3 12	1000
M3	14 mm	5.5 mm	3 mm	HS2.5	ISO 4762	0094 3 14	1000
M3	16 mm	5.5 mm	3 mm	HS2.5	ISO 4762	0094 3 16	1000
M3	18 mm	5.5 mm	3 mm	HS2.5	ISO 4762	0094 3 18	1000
M3	20 mm	5.5 mm	3 mm	HS2.5	ISO 4762	0094 3 20	1000
M3	22 mm	5.5 mm	3 mm	HS2.5	ISO 4762	0094 3 22	1000
M3	25 mm	5.5 mm	3 mm	HS2.5	ISO 4762	0094 3 25	500
M3	30 mm	5.5 mm	3 mm	HS2.5	ISO 4762	0094 3 30	500
M3	35 mm	5.5 mm	3 mm	HS2.5	ISO 4762	0094 3 35	500
M3	40 mm	5.5 mm	3 mm	HS2.5	ISO 4762	0094 3 40	200/500
M3	45 mm	5.5 mm	3 mm	HS2.5	ISO 4762	0094 3 45	500
M3	50 mm	5.5 mm	3 mm	HS2.5	ISO 4762	0094 3 50	200/500
M3	60 mm	5.5 mm	3 mm	HS2.5	ISO 4762	0094 3 60	200
M3	70 mm	5.5 mm	3 mm	HS2.5	ISO 4762	0094 3 70	100
M3	75 mm	5.5 mm	3 mm	HS2.5	ISO 4762	0094 3 75	100
M4	5 mm	7 mm	4 mm	HS3	ISO 4762	0094 4 5	1000
M4	6 mm	7 mm	4 mm	HS3	ISO 4762	0094 4 6	1000
M4	8 mm	7 mm	4 mm	HS3	ISO 4762	0094 4 8	200/1000
M4	10 mm	7 mm	4 mm	HS3	ISO 4762	0094 4 10	200/1000
M4	12 mm	7 mm	4 mm	HS3	ISO 4762	0094 4 12	200/1000
M4	14 mm	7 mm	4 mm	HS3	ISO 4762	0094 4 14	200/1000
M4	16 mm	7 mm	4 mm	HS3	ISO 4762	0094 4 16	200/1000
M4	18 mm	7 mm	4 mm	HS3	ISO 4762	0094 4 18	200/1000
M4	20 mm	7 mm	4 mm	HS3	ISO 4762	0094 4 20	200/500
M4	22 mm	7 mm	4 mm	HS3	ISO 4762	0094 4 22	500/1000
M4	25 mm	7 mm	4 mm	HS3	ISO 4762	0094 4 25	200/500
M4	30 mm	7 mm	4 mm	HS3	ISO 4762	0094 4 30	200/500
M4	35 mm	7 mm	4 mm	HS3	ISO 4762	0094 4 35	200/500
M4	40 mm	7 mm	4 mm	HS3	ISO 4762	0094 4 40	500
M4	45 mm	7 mm	4 mm	HS3	ISO 4762	0094 4 45	200
M4	50 mm	7 mm	4 mm	HS3	ISO 4762	0094 4 50	200/500
M4	55 mm	7 mm	4 mm	HS3	ISO 4762	0094 4 55	200
M4	60 mm	7 mm	4 mm	HS3	ISO 4762	0094 4 60	200
M4	65 mm	7 mm	4 mm	HS3	ISO 4762	0094 4 65	200
M4	70 mm	7 mm	4 mm	HS3	ISO 4762	0094 4 70	250
M4	75 mm	7 mm	4 mm	HS3	ISO 4762	0094 4 75	100
M4	80 mm	7 mm	4 mm	HS3	ISO 4762	0094 4 80	100
M4	90 mm	7 mm	4 mm	HS3	ISO 4762	0094 4 90	100
M4	100 mm	7 mm	4 mm	HS3	ISO 4762	0094 4 100	100
M5	6 mm	8.5 mm	5 mm	HS4	ISO 4762	0094 5 6	500
M5	8 mm	8.5 mm	5 mm	HS4	ISO 4762	0094 5 8	500

Thread type x nominal diameter (d ₁)	Length (l ₁)	Head diameter (d _k)	Head height (k ₁)	Internal drive (s ₁)	Standards	Art. no.	P. Qty.
M5	10 mm	8.5 mm	5 mm	HS4	ISO 4762	0094 5 10	100/500
M5	12 mm	8.5 mm	5 mm	HS4	ISO 4762	0094 5 12	100/1000
M5	14 mm	8.5 mm	5 mm	HS4	ISO 4762	0094 5 14	100/500
M5	16 mm	8.5 mm	5 mm	HS4	ISO 4762	0094 5 16	100/200 /500
M5	18 mm	8.5 mm	5 mm	HS4	ISO 4762	0094 5 18	500
M5	20 mm	8.5 mm	5 mm	HS4	ISO 4762	0094 5 20	100/500
M5	22 mm	8.5 mm	5 mm	HS4	ISO 4762	0094 5 22	100/500
M5	25 mm	8.5 mm	5 mm	HS4	ISO 4762	0094 5 25	100/1000
M5	30 mm	8.5 mm	5 mm	HS4	ISO 4762	0094 5 30	100/500
M5	35 mm	8.5 mm	5 mm	HS4	ISO 4762	0094 5 35	100/200
M5	40 mm	8.5 mm	5 mm	HS4	ISO 4762	0094 5 40	100/200
M5	45 mm	8.5 mm	5 mm	HS4	ISO 4762	0094 5 45	200
M5	50 mm	8.5 mm	5 mm	HS4	ISO 4762	0094 5 50	200
M5	55 mm	8.5 mm	5 mm	HS4	ISO 4762	0094 5 55	100/200
M5	60 mm	8.5 mm	5 mm	HS4	ISO 4762	0094 5 60	100/200
M5	65 mm	8.5 mm	5 mm	HS4	ISO 4762	0094 5 65	100/200
M5	70 mm	8.5 mm	5 mm	HS4	ISO 4762	0094 5 70	100/200
M5	75 mm	8.5 mm	5 mm	HS4	ISO 4762	0094 5 75	200
M5	80 mm	8.5 mm	5 mm	HS4	ISO 4762	0094 5 80	200
M5	85 mm	8.5 mm	5 mm	HS4	ISO 4762	0094 5 85	200
M5	90 mm	8.5 mm	5 mm	HS4	ISO 4762	0094 5 90	200
M5	95 mm	8.5 mm	5 mm	HS4	ISO 4762	0094 5 95	50
M5	100 mm	8.5 mm	5 mm	HS4	ISO 4762	0094 5 100	100/200
M5	110 mm	8.5 mm	5 mm	HS4	ISO 4762	0094 5 110	100
M5	120 mm	8.5 mm	5 mm	HS4	ISO 4762	0094 5 120	100
M6	6 mm	10 mm	6 mm	HS5	ISO 4762	0094 6 6	500
M6	8 mm	10 mm	6 mm	HS5	ISO 4762	0094 6 8	100/500
M6	10 mm	10 mm	6 mm	HS5	ISO 4762	0094 6 10	100/500
M6	12 mm	10 mm	6 mm	HS5	ISO 4762	0094 6 12	100/500
M6	14 mm	10 mm	6 mm	HS5	ISO 4762	0094 6 14	100
M6	16 mm	10 mm	6 mm	HS5	ISO 4762	0094 6 16	100/500
M6	18 mm	10 mm	6 mm	HS5	ISO 4762	0094 6 18	200
M6	20 mm	10 mm	6 mm	HS5	ISO 4762	0094 6 20	100/500
M6	22 mm	10 mm	6 mm	HS5	ISO 4762	0094 6 22	100/200
M6	25 mm	10 mm	6 mm	HS5	ISO 4762	0094 6 25	100/500
M6	30 mm	10 mm	6 mm	HS5	ISO 4762	0094 6 30	100/500
M6	35 mm	10 mm	6 mm	HS5	ISO 4762	0094 6 35	100/200
M6	40 mm	10 mm	6 mm	HS5	ISO 4762	0094 6 40	100/500
M6	45 mm	10 mm	6 mm	HS5	ISO 4762	0094 6 45	100
M6	50 mm	10 mm	6 mm	HS5	ISO 4762	0094 6 50	100/500
M6	55 mm	10 mm	6 mm	HS5	ISO 4762	0094 6 55	100
M6	60 mm	10 mm	6 mm	HS5	ISO 4762	0094 6 60	100
M6	65 mm	10 mm	6 mm	HS5	ISO 4762	0094 6 65	200
M6	70 mm	10 mm	6 mm	HS5	ISO 4762	0094 6 70	50/100
M6	75 mm	10 mm	6 mm	HS5	ISO 4762	0094 6 75	100
M6	80 mm	10 mm	6 mm	HS5	ISO 4762	0094 6 80	100
M6	85 mm	10 mm	6 mm	HS5	ISO 4762	0094 6 85	100
M6	90 mm	10 mm	6 mm	HS5	ISO 4762	0094 6 90	100
M6	100 mm	10 mm	6 mm	HS5	ISO 4762	0094 6 100	50/100
M6	110 mm	10 mm	6 mm	HS5	ISO 4762	0094 6 110	100
M6	120 mm	10 mm	6 mm	HS5	ISO 4762	0094 6 120	50/100
M6	130 mm	10 mm	6 mm	HS5	ISO 4762	0094 6 130	100

Thread type x nominal diameter (d ₁)	Length (l ₁)	Head diameter (d _k)	Head height (k ₁)	Internal drive (s ₁)	Standards	Art. no.	P. Qty.
M6	140 mm	10 mm	6 mm	HS5	ISO 4762	0094 6 140	100
M6	150 mm	10 mm	6 mm	HS5	ISO 4762	0094 6 150	100
M6	160 mm	10 mm	6 mm	HS5	ISO 4762	0094 6 160	10
M6	185 mm	10 mm	6 mm	HS5	ISO 4762	0094 6 185	50
M6	200 mm	10 mm	6 mm	HS5	ISO 4762	0094 6 200	500
M8	8 mm	13 mm	8 mm	HS6	ISO 4762	0094 8 8	100
M8	10 mm	13 mm	8 mm	HS6	ISO 4762	0094 8 10	100/200
M8	12 mm	13 mm	8 mm	HS6	ISO 4762	0094 8 12	100/200
M8	14 mm	13 mm	8 mm	HS6	ISO 4762	0094 8 14	100/200
M8	16 mm	13 mm	8 mm	HS6	ISO 4762	0094 8 16	100/200
M8	18 mm	13 mm	8 mm	HS6	ISO 4762	0094 8 18	100/200
M8	20 mm	13 mm	8 mm	HS6	ISO 4762	0094 8 20	100/200
M8	22 mm	13 mm	8 mm	HS6	ISO 4762	0094 8 22	200
M8	25 mm	13 mm	8 mm	HS6	ISO 4762	0094 8 25	100/200
M8	30 mm	13 mm	8 mm	HS6	ISO 4762	0094 8 30	100/200
M8	35 mm	13 mm	8 mm	HS6	ISO 4762	0094 8 35	100/200
M8	40 mm	13 mm	8 mm	HS6	ISO 4762	0094 8 40	100/200
M8	45 mm	13 mm	8 mm	HS6	ISO 4762	0094 8 45	100
M8	50 mm	13 mm	8 mm	HS6	ISO 4762	0094 8 50	100/200
M8	55 mm	13 mm	8 mm	HS6	ISO 4762	0094 8 55	100/200
M8	60 mm	13 mm	8 mm	HS6	ISO 4762	0094 8 60	100
M8	65 mm	13 mm	8 mm	HS6	ISO 4762	0094 8 65	100
M8	70 mm	13 mm	8 mm	HS6	ISO 4762	0094 8 70	50/100
M8	75 mm	13 mm	8 mm	HS6	ISO 4762	0094 8 75	50/100
M8	80 mm	13 mm	8 mm	HS6	ISO 4762	0094 8 80	50
M8	85 mm	13 mm	8 mm	HS6	ISO 4762	0094 8 85	50
M8	90 mm	13 mm	8 mm	HS6	ISO 4762	0094 8 90	50
M8	95 mm	13 mm	8 mm	HS6	ISO 4762	0094 8 95	100
M8	100 mm	13 mm	8 mm	HS6	ISO 4762	0094 8 100	50/100
M8	110 mm	13 mm	8 mm	HS6	ISO 4762	0094 8 110	50/100
M8	120 mm	13 mm	8 mm	HS6	ISO 4762	0094 8 120	50
M8	130 mm	13 mm	8 mm	HS6	ISO 4762	0094 8 130	50
M8	135 mm	13 mm	8 mm	HS6	ISO 4762	0094 8 135	50
M8	140 mm	13 mm	8 mm	HS6	ISO 4762	0094 8 140	50
M8	150 mm	13 mm	8 mm	HS6	ISO 4762	0094 8 150	50
M8	160 mm	13 mm	8 mm	HS6	ISO 4762	0094 8 160	50
M8	180 mm	13 mm	8 mm	HS6	ISO 4762	0094 8 180	25
M8	190 mm	13 mm	8 mm	HS6	ISO 4762	0094 8 190	25
M8	220 mm	13 mm	8 mm	HS6	ISO 4762	0094 8 220	25
M8	230 mm	13 mm	8 mm	HS6	ISO 4762	0094 8 230	1
M8	240 mm	13 mm	8 mm	HS6	ISO 4762	0094 8 240	10
M8	250 mm	13 mm	8 mm	HS6	ISO 4762	0094 8 250	10
M8	270 mm	13 mm	8 mm	HS6	ISO 4762	0094 8 270	1
M8	280 mm	13 mm	8 mm	HS6	ISO 4762	0094 8 280	1
M8	290 mm	13 mm	8 mm	HS6	ISO 4762	0094 8 290	1
M8	300 mm	13 mm	8 mm	HS6	ISO 4762	0094 8 300	1
M10	10 mm	16 mm	10 mm	HS8	ISO 4762	0094 10 10	100
M10	16 mm	16 mm	10 mm	HS8	ISO 4762	0094 10 16	100
M10	18 mm	16 mm	10 mm	HS8	ISO 4762	0094 10 18	200
M10	20 mm	16 mm	10 mm	HS8	ISO 4762	0094 10 20	100
M10	22 mm	16 mm	10 mm	HS8	ISO 4762	0094 10 22	100
M10	25 mm	16 mm	10 mm	HS8	ISO 4762	0094 10 25	100
M10	30 mm	16 mm	10 mm	HS8	ISO 4762	0094 10 30	100

Thread type x nominal diameter (d ₁)	Length (l ₁)	Head diameter (d _k)	Head height (k ₁)	Internal drive (s ₁)	Standards	Art. no.	P. Qty.
M10	35 mm	16 mm	10 mm	HS8	ISO 4762	0094 10 35	100
M10	40 mm	16 mm	10 mm	HS8	ISO 4762	0094 10 40	100
M10	45 mm	16 mm	10 mm	HS8	ISO 4762	0094 10 45	100
M10	50 mm	16 mm	10 mm	HS8	ISO 4762	0094 10 50	50
M10	55 mm	16 mm	10 mm	HS8	ISO 4762	0094 10 55	50
M10	60 mm	16 mm	10 mm	HS8	ISO 4762	0094 10 60	50
M10	65 mm	16 mm	10 mm	HS8	ISO 4762	0094 10 65	50
M10	70 mm	16 mm	10 mm	HS8	ISO 4762	0094 10 70	50
M10	75 mm	16 mm	10 mm	HS8	ISO 4762	0094 10 75	50
M10	80 mm	16 mm	10 mm	HS8	ISO 4762	0094 10 80	50
M10	85 mm	16 mm	10 mm	HS8	ISO 4762	0094 10 85	50
M10	90 mm	16 mm	10 mm	HS8	ISO 4762	0094 10 90	50
M10	100 mm	16 mm	10 mm	HS8	ISO 4762	0094 10 100	50/100
M10	110 mm	16 mm	10 mm	HS8	ISO 4762	0094 10 110	50
M10	120 mm	16 mm	10 mm	HS8	ISO 4762	0094 10 120	50/100
M10	125 mm	16 mm	10 mm	HS8	ISO 4762	0094 10 125	25
M10	130 mm	16 mm	10 mm	HS8	ISO 4762	0094 10 130	50
M10	140 mm	16 mm	10 mm	HS8	ISO 4762	0094 10 140	50
M10	150 mm	16 mm	10 mm	HS8	ISO 4762	0094 10 150	50
M10	160 mm	16 mm	10 mm	HS8	ISO 4762	0094 10 160	50
M10	170 mm	16 mm	10 mm	HS8	ISO 4762	0094 10 170	50
M12	16 mm	18 mm	12 mm	HS10	ISO 4762	0094 12 16	100
M12	20 mm	18 mm	12 mm	HS10	ISO 4762	0094 12 20	50/100
M12	25 mm	18 mm	12 mm	HS10	ISO 4762	0094 12 25	50/200
M12	30 mm	18 mm	12 mm	HS10	ISO 4762	0094 12 30	50
M12	35 mm	18 mm	12 mm	HS10	ISO 4762	0094 12 35	50/100
M12	40 mm	18 mm	12 mm	HS10	ISO 4762	0094 12 40	50/100
M12	45 mm	18 mm	12 mm	HS10	ISO 4762	0094 12 45	50/100
M12	50 mm	18 mm	12 mm	HS10	ISO 4762	0094 12 50	50/100
M12	55 mm	18 mm	12 mm	HS10	ISO 4762	0094 12 55	50/100
M12	60 mm	18 mm	12 mm	HS10	ISO 4762	0094 12 60	50
M12	65 mm	18 mm	12 mm	HS10	ISO 4762	0094 12 65	50
M12	70 mm	18 mm	12 mm	HS10	ISO 4762	0094 12 70	25/50
M12	75 mm	18 mm	12 mm	HS10	ISO 4762	0094 12 75	50
M12	80 mm	18 mm	12 mm	HS10	ISO 4762	0094 12 80	25
M12	90 mm	18 mm	12 mm	HS10	ISO 4762	0094 12 90	25
M12	100 mm	18 mm	12 mm	HS10	ISO 4762	0094 12 100	25
M12	110 mm	18 mm	12 mm	HS10	ISO 4762	0094 12 110	25
M12	120 mm	18 mm	12 mm	HS10	ISO 4762	0094 12 120	25
M12	130 mm	18 mm	12 mm	HS10	ISO 4762	0094 12 130	50
M12	140 mm	18 mm	12 mm	HS10	ISO 4762	0094 12 140	50
M12	150 mm	18 mm	12 mm	HS10	ISO 4762	0094 12 150	25
M12	160 mm	18 mm	12 mm	HS10	ISO 4762	0094 12 160	25
M12	170 mm	18 mm	12 mm	HS10	ISO 4762	0094 12 170	50
M12	200 mm	18 mm	12 mm	HS10	ISO 4762	0094 12 200	25
M12	250 mm	18 mm	12 mm	HS10	ISO 4762	0094 12 250	1
M14	20 mm	21 mm	14 mm	HS12	ISO 4762	0094 14 20	25
M14	25 mm	21 mm	14 mm	HS12	ISO 4762	0094 14 25	100
M14	30 mm	21 mm	14 mm	HS12	ISO 4762	0094 14 30	25
M14	35 mm	21 mm	14 mm	HS12	ISO 4762	0094 14 35	100
M14	40 mm	21 mm	14 mm	HS12	ISO 4762	0094 14 40	25
M14	50 mm	21 mm	14 mm	HS12	ISO 4762	0094 14 50	50
M14	55 mm	21 mm	14 mm	HS12	ISO 4762	0094 14 55	50

Thread type x nominal diameter (d ₁)	Length (l ₁)	Head diameter (d _k)	Head height (k ₁)	Internal drive (s ₁)	Standards	Art. no.	P. Qty.
M14	60 mm	21 mm	14 mm	HS12	ISO 4762	0094 14 60	25/50
M14	70 mm	21 mm	14 mm	HS12	ISO 4762	0094 14 70	25
M14	80 mm	21 mm	14 mm	HS12	ISO 4762	0094 14 80	25
M14	90 mm	21 mm	14 mm	HS12	ISO 4762	0094 14 90	25
M14	120 mm	21 mm	14 mm	HS12	ISO 4762	0094 14 120	25
M14	130 mm	21 mm	14 mm	HS12	ISO 4762	0094 14 130	25
M14	140 mm	21 mm	14 mm	HS12	ISO 4762	0094 14 140	25
M16	25 mm	24 mm	16 mm	HS14	ISO 4762	0094 16 25	25
M16	30 mm	24 mm	16 mm	HS14	ISO 4762	0094 16 30	25
M16	35 mm	24 mm	16 mm	HS14	ISO 4762	0094 16 35	25
M16	40 mm	24 mm	16 mm	HS14	ISO 4762	0094 16 40	25/50
M16	45 mm	24 mm	16 mm	HS14	ISO 4762	0094 16 45	25
M16	50 mm	24 mm	16 mm	HS14	ISO 4762	0094 16 50	25
M16	55 mm	24 mm	16 mm	HS14	ISO 4762	0094 16 55	25/50
M16	60 mm	24 mm	16 mm	HS14	ISO 4762	0094 16 60	25
M16	65 mm	24 mm	16 mm	HS14	ISO 4762	0094 16 65	50
M16	70 mm	24 mm	16 mm	HS14	ISO 4762	0094 16 70	25
M16	75 mm	24 mm	16 mm	HS14	ISO 4762	0094 16 75	25
M16	80 mm	24 mm	16 mm	HS14	ISO 4762	0094 16 80	25
M16	100 mm	24 mm	16 mm	HS14	ISO 4762	0094 16 100	25
M16	110 mm	24 mm	16 mm	HS14	ISO 4762	0094 16 110	25
M16	120 mm	24 mm	16 mm	HS14	ISO 4762	0094 16 120	25
M16	130 mm	24 mm	16 mm	HS14	ISO 4762	0094 16 130	25
M16	140 mm	24 mm	16 mm	HS14	ISO 4762	0094 16 140	25
M16	150 mm	24 mm	16 mm	HS14	ISO 4762	0094 16 150	25
M16	165 mm	24 mm	16 mm	HS14	ISO 4762	0094 16 165	25
M16	170 mm	24 mm	16 mm	HS14	ISO 4762	0094 16 170	25
M16	180 mm	24 mm	16 mm	HS14	ISO 4762	0094 16 180	25
M16	190 mm	24 mm	16 mm	HS14	ISO 4762	0094 16 190	10
M18	35 mm	27 mm	18 mm	HS14	DIN 912	0094 18 35	25
M18	45 mm	27 mm	18 mm	HS14	DIN 912	0094 18 45	25
M18	50 mm	27 mm	18 mm	HS14	DIN 912	0094 18 50	25
M18	55 mm	27 mm	18 mm	HS14	DIN 912	0094 18 55	25
M18	60 mm	27 mm	18 mm	HS14	DIN 912	0094 18 60	25
M18	65 mm	27 mm	18 mm	HS14	DIN 912	0094 18 65	25
M18	70 mm	27 mm	18 mm	HS14	DIN 912	0094 18 70	25
M18	80 mm	27 mm	18 mm	HS14	DIN 912	0094 18 80	25
M18	90 mm	27 mm	18 mm	HS14	DIN 912	0094 18 90	25
M18	100 mm	27 mm	18 mm	HS14	DIN 912	0094 18 100	25
M18	110 mm	27 mm	18 mm	HS14	DIN 912	0094 18 110	25
M18	120 mm	27 mm	18 mm	HS14	DIN 912	0094 18 120	25
M18	130 mm	27 mm	18 mm	HS14	DIN 912	0094 18 130	25
M18	150 mm	27 mm	18 mm	HS14	DIN 912	0094 18 150	25
M18	160 mm	27 mm	18 mm	HS14	DIN 912	0094 18 160	25
M20	20 mm	30 mm	20 mm	HS17	ISO 4762	0094 20 20	50
M20	30 mm	30 mm	20 mm	HS17	ISO 4762	0094 20 30	25
M20	35 mm	30 mm	20 mm	HS17	ISO 4762	0094 20 35	25
M20	40 mm	30 mm	20 mm	HS17	ISO 4762	0094 20 40	50
M20	45 mm	30 mm	20 mm	HS17	ISO 4762	0094 20 45	25
M20	50 mm	30 mm	20 mm	HS17	ISO 4762	0094 20 50	25
M20	55 mm	30 mm	20 mm	HS17	ISO 4762	0094 20 55	25
M20	60 mm	30 mm	20 mm	HS17	ISO 4762	0094 20 60	25
M20	65 mm	30 mm	20 mm	HS17	ISO 4762	0094 20 65	25

Thread type x nominal diameter (d ₁)	Length (l ₁)	Head diameter (d _k)	Head height (k ₁)	Internal drive (s ₁)	Standards	Art. no.	P. Qty.
M20	70 mm	30 mm	20 mm	HS17	ISO 4762	0094 20 70	25
M20	75 mm	30 mm	20 mm	HS17	ISO 4762	0094 20 75	25
M20	80 mm	30 mm	20 mm	HS17	ISO 4762	0094 20 80	25
M20	90 mm	30 mm	20 mm	HS17	ISO 4762	0094 20 90	25
M20	100 mm	30 mm	20 mm	HS17	ISO 4762	0094 20 100	10/25
M20	110 mm	30 mm	20 mm	HS17	ISO 4762	0094 20 110	10/25
M20	120 mm	30 mm	20 mm	HS17	ISO 4762	0094 20 120	10/25
M20	140 mm	30 mm	20 mm	HS17	ISO 4762	0094 20 140	10
M20	150 mm	30 mm	20 mm	HS17	ISO 4762	0094 20 150	10
M20	160 mm	30 mm	20 mm	HS17	ISO 4762	0094 20 160	10
M20	190 mm	30 mm	20 mm	HS17	ISO 4762	0094 20 190	10
M20	200 mm	30 mm	20 mm	HS17	ISO 4762	0094 20 200	10
M24	35 mm	36 mm	24 mm	HS19	ISO 4762	0094 24 35	10
M24	40 mm	36 mm	24 mm	HS19	ISO 4762	0094 24 40	10
M24	50 mm	36 mm	24 mm	HS19	ISO 4762	0094 24 50	10
M24	55 mm	36 mm	24 mm	HS19	ISO 4762	0094 24 55	10
M24	60 mm	36 mm	24 mm	HS19	ISO 4762	0094 24 60	10
M24	70 mm	36 mm	24 mm	HS19	ISO 4762	0094 24 70	10
M24	80 mm	36 mm	24 mm	HS19	ISO 4762	0094 24 80	10
M24	90 mm	36 mm	24 mm	HS19	ISO 4762	0094 24 90	10
M24	100 mm	36 mm	24 mm	HS19	ISO 4762	0094 24 100	10
M24	110 mm	36 mm	24 mm	HS19	ISO 4762	0094 24 110	10
M24	120 mm	36 mm	24 mm	HS19	ISO 4762	0094 24 120	10
M24	130 mm	36 mm	24 mm	HS19	ISO 4762	0094 24 130	10
M24	140 mm	36 mm	24 mm	HS19	ISO 4762	0094 24 140	10
M24	150 mm	36 mm	24 mm	HS19	ISO 4762	0094 24 150	10

Details/Application

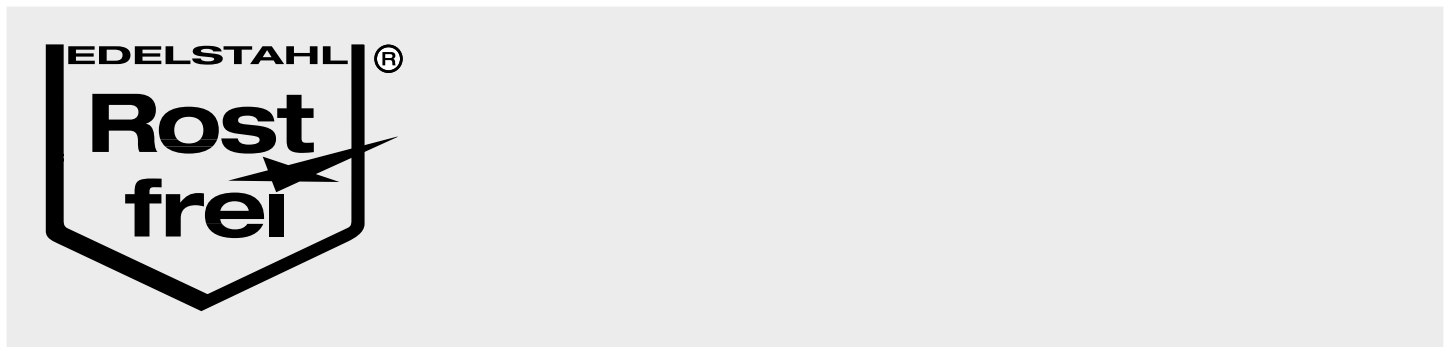

Notice

ISO 4762 replaces DIN 912 | There is some similarity | Nominal range changed | Fine thread moved to ISO 12474.