

Hexagon Socket Head Cap Screw

ISO 4762/DIN 912 stainless steel, A4-70, plain

Material	Stainless steel A4
Surface	Plain
Property class	70
RoHS-compliant	Yes

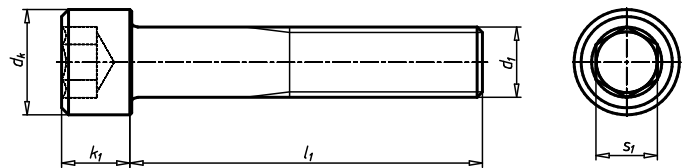

Thread type x nominal diameter (d ₁)	Length (l ₁)	Head diameter (d _k)	Head height (k ₁)	Internal drive (s ₁)	Standards	Art. no.	P. Qty.
M1.6	5 mm	3 mm	1.6 mm	HS1.5	ISO 4762	0097 17 5	200
M1.6	6 mm	3 mm	1.6 mm	HS1.5	ISO 4762	0097 17 6	500
M1.6	8 mm	3 mm	1.6 mm	HS1.5	ISO 4762	0097 17 8	200
M2	3 mm	3.8 mm	2 mm	HS1.5	ISO 4762	0097 2 3	1000
M2	4 mm	3.8 mm	2 mm	HS1.5	ISO 4762	0097 2 4	500
M2	5 mm	3.8 mm	2 mm	HS1.5	ISO 4762	0097 2 5	1000
M2	6 mm	3.8 mm	2 mm	HS1.5	ISO 4762	0097 2 6	1000
M2	8 mm	3.8 mm	2 mm	HS1.5	ISO 4762	0097 2 8	1000
M2	10 mm	3.8 mm	2 mm	HS1.5	ISO 4762	0097 2 10	1000
M2	12 mm	3.8 mm	2 mm	HS1.5	ISO 4762	0097 2 12	1000
M2	16 mm	3.8 mm	2 mm	HS1.5	ISO 4762	0097 2 16	1000
M2	20 mm	3.8 mm	2 mm	HS1.5	ISO 4762	0097 2 20	1000
M2.5	4 mm	4.5 mm	2.5 mm	HS2	ISO 4762	0097 25 4	1000
M2.5	8 mm	4.5 mm	2.5 mm	HS2	ISO 4762	0097 25 8	1000
M2.5	10 mm	4.5 mm	2.5 mm	HS2	ISO 4762	0097 25 10	1000
M2.5	12 mm	4.5 mm	2.5 mm	HS2	ISO 4762	0097 25 12	1000
M2.5	14 mm	4.5 mm	2.5 mm	HS2	ISO 4762	0097 25 14	1000
M2.5	16 mm	4.5 mm	2.5 mm	HS2	ISO 4762	0097 25 16	1000
M2.5	20 mm	4.5 mm	2.5 mm	HS2	ISO 4762	0097 25 20	1000
M3	4 mm	5.5 mm	3 mm	HS2.5	ISO 4762	0097 3 4	1000
M3	5 mm	5.5 mm	3 mm	HS2.5	ISO 4762	0097 3 5	1000
M3	6 mm	5.5 mm	3 mm	HS2.5	ISO 4762	0097 3 6	1000
M3	8 mm	5.5 mm	3 mm	HS2.5	ISO 4762	0097 3 8	1000
M3	10 mm	5.5 mm	3 mm	HS2.5	ISO 4762	0097 3 10	200/1000
M3	12 mm	5.5 mm	3 mm	HS2.5	ISO 4762	0097 3 12	1000
M3	14 mm	5.5 mm	3 mm	HS2.5	ISO 4762	0097 3 14	1000
M3	16 mm	5.5 mm	3 mm	HS2.5	ISO 4762	0097 3 16	1000
M3	18 mm	5.5 mm	3 mm	HS2.5	ISO 4762	0097 3 18	1000
M3	20 mm	5.5 mm	3 mm	HS2.5	ISO 4762	0097 3 20	1000
M3	25 mm	5.5 mm	3 mm	HS2.5	ISO 4762	0097 3 25	1000
M3	30 mm	5.5 mm	3 mm	HS2.5	ISO 4762	0097 3 30	1000
M3	40 mm	5.5 mm	3 mm	HS2.5	ISO 4762	0097 3 40	1000
M3	45 mm	5.5 mm	3 mm	HS2.5	ISO 4762	0097 3 45	500
M3	50 mm	5.5 mm	3 mm	HS2.5	ISO 4762	0097 3 50	500

Thread type x nominal diameter (d ₁)	Length (l ₁)	Head diameter (d _k)	Head height (k ₁)	Internal drive (s ₁)	Standards	Art. no.	P. Qty.
M4	5 mm	7 mm	4 mm	HS3	ISO 4762	0097 4 5	1000
M4	6 mm	7 mm	4 mm	HS3	ISO 4762	0097 4 6	1000
M4	8 mm	7 mm	4 mm	HS3	ISO 4762	0097 4 8	200/1000
M4	10 mm	7 mm	4 mm	HS3	ISO 4762	0097 4 10	200/1000
M4	12 mm	7 mm	4 mm	HS3	ISO 4762	0097 4 12	200/1000
M4	14 mm	7 mm	4 mm	HS3	ISO 4762	0097 4 14	1000
M4	16 mm	7 mm	4 mm	HS3	ISO 4762	0097 4 16	200/1000
M4	18 mm	7 mm	4 mm	HS3	ISO 4762	0097 4 18	1000
M4	20 mm	7 mm	4 mm	HS3	ISO 4762	0097 4 20	200/1000
M4	22 mm	7 mm	4 mm	HS3	ISO 4762	0097 4 22	1000
M4	25 mm	7 mm	4 mm	HS3	ISO 4762	0097 4 25	500
M4	30 mm	7 mm	4 mm	HS3	ISO 4762	0097 4 30	500
M4	35 mm	7 mm	4 mm	HS3	ISO 4762	0097 4 35	200
M4	40 mm	7 mm	4 mm	HS3	ISO 4762	0097 4 40	200
M4	45 mm	7 mm	4 mm	HS3	ISO 4762	0097 4 45	200
M4	50 mm	7 mm	4 mm	HS3	ISO 4762	0097 4 50	500
M4	55 mm	7 mm	4 mm	HS3	ISO 4762	0097 4 55	500
M4	60 mm	7 mm	4 mm	HS3	ISO 4762	0097 4 60	500
M4	65 mm	7 mm	4 mm	HS3	ISO 4762	0097 4 65	100
M4	70 mm	7 mm	4 mm	HS3	ISO 4762	0097 4 70	500
M4	80 mm	7 mm	4 mm	HS3	ISO 4762	0097 4 80	100
M5	6 mm	8.5 mm	5 mm	HS4	ISO 4762	0097 5 6	500
M5	8 mm	8.5 mm	5 mm	HS4	ISO 4762	0097 5 8	200/1000
M5	10 mm	8.5 mm	5 mm	HS4	ISO 4762	0097 5 10	200/500
M5	12 mm	8.5 mm	5 mm	HS4	ISO 4762	0097 5 12	200/500
M5	14 mm	8.5 mm	5 mm	HS4	ISO 4762	0097 5 14	500
M5	16 mm	8.5 mm	5 mm	HS4	ISO 4762	0097 5 16	100/500
M5	18 mm	8.5 mm	5 mm	HS4	ISO 4762	0097 5 18	500
M5	20 mm	8.5 mm	5 mm	HS4	ISO 4762	0097 5 20	100/500
M5	25 mm	8.5 mm	5 mm	HS4	ISO 4762	0097 5 25	100/200
M5	30 mm	8.5 mm	5 mm	HS4	ISO 4762	0097 5 30	100/200
M5	35 mm	8.5 mm	5 mm	HS4	ISO 4762	0097 5 35	100/200
M5	40 mm	8.5 mm	5 mm	HS4	ISO 4762	0097 5 40	100/500
M5	45 mm	8.5 mm	5 mm	HS4	ISO 4762	0097 5 45	200/1000
M5	50 mm	8.5 mm	5 mm	HS4	ISO 4762	0097 5 50	100/200
M5	55 mm	8.5 mm	5 mm	HS4	ISO 4762	0097 5 55	200
M5	60 mm	8.5 mm	5 mm	HS4	ISO 4762	0097 5 60	200
M5	65 mm	8.5 mm	5 mm	HS4	ISO 4762	0097 5 65	200
M5	70 mm	8.5 mm	5 mm	HS4	ISO 4762	0097 5 70	200
M5	80 mm	8.5 mm	5 mm	HS4	ISO 4762	0097 5 80	200
M5	85 mm	8.5 mm	5 mm	HS4	ISO 4762	0097 5 85	10
M5	90 mm	8.5 mm	5 mm	HS4	ISO 4762	0097 5 90	100
M5	95 mm	8.5 mm	5 mm	HS4	ISO 4762	0097 5 95	10
M5	100 mm	8.5 mm	5 mm	HS4	ISO 4762	0097 5 100	200
M5	130 mm	8.5 mm	5 mm	HS4	ISO 4762	0097 5 130	50
M6	6 mm	10 mm	6 mm	HS5	ISO 4762	0097 6 6	500
M6	8 mm	10 mm	6 mm	HS5	ISO 4762	0097 6 8	200/500
M6	10 mm	10 mm	6 mm	HS5	ISO 4762	0097 6 10	100/500
M6	12 mm	10 mm	6 mm	HS5	ISO 4762	0097 6 12	100/200
M6	14 mm	10 mm	6 mm	HS5	ISO 4762	0097 6 14	200
M6	16 mm	10 mm	6 mm	HS5	ISO 4762	0097 6 16	100/500
M6	18 mm	10 mm	6 mm	HS5	ISO 4762	0097 6 18	500
M6	20 mm	10 mm	6 mm	HS5	ISO 4762	0097 6 20	100/500

Thread type x nominal diameter (d ₁)	Length (l ₁)	Head diameter (d _k)	Head height (k ₁)	Internal drive (s ₁)	Standards	Art. no.	P. Qty.
M6	25 mm	10 mm	6 mm	HS5	ISO 4762	0097 6 25	100/200
M6	30 mm	10 mm	6 mm	HS5	ISO 4762	0097 6 30	100/200
M6	35 mm	10 mm	6 mm	HS5	ISO 4762	0097 6 35	100/200
M6	40 mm	10 mm	6 mm	HS5	ISO 4762	0097 6 40	100/200
M6	45 mm	10 mm	6 mm	HS5	ISO 4762	0097 6 45	100
M6	50 mm	10 mm	6 mm	HS5	ISO 4762	0097 6 50	100
M6	55 mm	10 mm	6 mm	HS5	ISO 4762	0097 6 55	200
M6	60 mm	10 mm	6 mm	HS5	ISO 4762	0097 6 60	100
M6	65 mm	10 mm	6 mm	HS5	ISO 4762	0097 6 65	100
M6	70 mm	10 mm	6 mm	HS5	ISO 4762	0097 6 70	200
M6	75 mm	10 mm	6 mm	HS5	ISO 4762	0097 6 75	100
M6	80 mm	10 mm	6 mm	HS5	ISO 4762	0097 6 80	100
M6	85 mm	10 mm	6 mm	HS5	ISO 4762	0097 6 85	100
M6	90 mm	10 mm	6 mm	HS5	ISO 4762	0097 6 90	100
M6	95 mm	10 mm	6 mm	HS5	ISO 4762	0097 6 95	100
M6	100 mm	10 mm	6 mm	HS5	ISO 4762	0097 6 100	100
M6	110 mm	10 mm	6 mm	HS5	ISO 4762	0097 6 110	100
M6	120 mm	10 mm	6 mm	HS5	ISO 4762	0097 6 120	100
M6	125 mm	10 mm	6 mm	HS5	ISO 4762	0097 6 125	100
M6	130 mm	10 mm	6 mm	HS5	ISO 4762	0097 6 130	100
M6	140 mm	10 mm	6 mm	HS5	ISO 4762	0097 6 140	100
M6	145 mm	10 mm	6 mm	HS5	ISO 4762	0097 6 145	100
M6	150 mm	10 mm	6 mm	HS5	ISO 4762	0097 6 150	100
M6	160 mm	10 mm	6 mm	HS5	ISO 4762	0097 6 160	25
M8	10 mm	13 mm	8 mm	HS6	ISO 4762	0097 8 10	200
M8	12 mm	13 mm	8 mm	HS6	ISO 4762	0097 8 12	100/200
M8	14 mm	13 mm	8 mm	HS6	ISO 4762	0097 8 14	200
M8	16 mm	13 mm	8 mm	HS6	ISO 4762	0097 8 16	100/200
M8	18 mm	13 mm	8 mm	HS6	ISO 4762	0097 8 18	200/500
M8	20 mm	13 mm	8 mm	HS6	ISO 4762	0097 8 20	100/200
M8	25 mm	13 mm	8 mm	HS6	ISO 4762	0097 8 25	100/200
M8	30 mm	13 mm	8 mm	HS6	ISO 4762	0097 8 30	100/200
M8	35 mm	13 mm	8 mm	HS6	ISO 4762	0097 8 35	100/200
M8	40 mm	13 mm	8 mm	HS6	ISO 4762	0097 8 40	100
M8	45 mm	13 mm	8 mm	HS6	ISO 4762	0097 8 45	200
M8	50 mm	13 mm	8 mm	HS6	ISO 4762	0097 8 50	100
M8	55 mm	13 mm	8 mm	HS6	ISO 4762	0097 8 55	100
M8	60 mm	13 mm	8 mm	HS6	ISO 4762	0097 8 60	100
M8	65 mm	13 mm	8 mm	HS6	ISO 4762	0097 8 65	100
M8	70 mm	13 mm	8 mm	HS6	ISO 4762	0097 8 70	100
M8	75 mm	13 mm	8 mm	HS6	ISO 4762	0097 8 75	100
M8	80 mm	13 mm	8 mm	HS6	ISO 4762	0097 8 80	100
M8	85 mm	13 mm	8 mm	HS6	ISO 4762	0097 8 85	50
M8	90 mm	13 mm	8 mm	HS6	ISO 4762	0097 8 90	100
M8	95 mm	13 mm	8 mm	HS6	ISO 4762	0097 8 95	100
M8	100 mm	13 mm	8 mm	HS6	ISO 4762	0097 8 100	100
M8	105 mm	13 mm	8 mm	HS6	ISO 4762	0097 8 105	100
M8	110 mm	13 mm	8 mm	HS6	ISO 4762	0097 8 110	100
M8	120 mm	13 mm	8 mm	HS6	ISO 4762	0097 8 120	100
M8	125 mm	13 mm	8 mm	HS6	ISO 4762	0097 8 125	10
M8	130 mm	13 mm	8 mm	HS6	ISO 4762	0097 8 130	50
M8	140 mm	13 mm	8 mm	HS6	ISO 4762	0097 8 140	100
M8	150 mm	13 mm	8 mm	HS6	ISO 4762	0097 8 150	100

Thread type x nominal diameter (d ₁)	Length (l ₁)	Head diameter (d _k)	Head height (k ₁)	Internal drive (s ₁)	Standards	Art. no.	P. Qty.
M8	155 mm	13 mm	8 mm	HS6	ISO 4762	0097 8 155	100
M8	160 mm	13 mm	8 mm	HS6	ISO 4762	0097 8 160	50
M8	170 mm	13 mm	8 mm	HS6	ISO 4762	0097 8 170	50
M8	180 mm	13 mm	8 mm	HS6	ISO 4762	0097 8 180	50
M8	200 mm	13 mm	8 mm	HS6	ISO 4762	0097 8 200	50
M8	220 mm	13 mm	8 mm	HS6	ISO 4762	0097 8 220	10
M8	240 mm	13 mm	8 mm	HS6	ISO 4762	0097 8 240	10
M10	10 mm	16 mm	10 mm	HS8	ISO 4762	0097 10 10	25
M10	12 mm	16 mm	10 mm	HS8	ISO 4762	0097 10 12	100
M10	16 mm	16 mm	10 mm	HS8	ISO 4762	0097 10 16	100
M10	20 mm	16 mm	10 mm	HS8	ISO 4762	0097 10 20	100
M10	25 mm	16 mm	10 mm	HS8	ISO 4762	0097 10 25	100
M10	30 mm	16 mm	10 mm	HS8	ISO 4762	0097 10 30	100/200
M10	35 mm	16 mm	10 mm	HS8	ISO 4762	0097 10 35	100
M10	40 mm	16 mm	10 mm	HS8	ISO 4762	0097 10 40	100
M10	45 mm	16 mm	10 mm	HS8	ISO 4762	0097 10 45	100
M10	50 mm	16 mm	10 mm	HS8	ISO 4762	0097 10 50	50
M10	55 mm	16 mm	10 mm	HS8	ISO 4762	0097 10 55	100
M10	60 mm	16 mm	10 mm	HS8	ISO 4762	0097 10 60	100
M10	65 mm	16 mm	10 mm	HS8	ISO 4762	0097 10 65	100
M10	70 mm	16 mm	10 mm	HS8	ISO 4762	0097 10 70	100
M10	75 mm	16 mm	10 mm	HS8	ISO 4762	0097 10 75	50
M10	80 mm	16 mm	10 mm	HS8	ISO 4762	0097 10 80	100
M10	85 mm	16 mm	10 mm	HS8	ISO 4762	0097 10 85	100
M10	90 mm	16 mm	10 mm	HS8	ISO 4762	0097 10 90	50
M10	100 mm	16 mm	10 mm	HS8	ISO 4762	0097 10 100	50
M10	110 mm	16 mm	10 mm	HS8	ISO 4762	0097 10 110	50
M10	130 mm	16 mm	10 mm	HS8	ISO 4762	0097 10 130	50
M10	135 mm	16 mm	10 mm	HS8	ISO 4762	0097 10 135	5
M10	140 mm	16 mm	10 mm	HS8	ISO 4762	0097 10 140	50
M10	150 mm	16 mm	10 mm	HS8	ISO 4762	0097 10 150	50
M10	160 mm	16 mm	10 mm	HS8	ISO 4762	0097 10 160	50
M10	165 mm	16 mm	10 mm	HS8	ISO 4762	0097 10 165	1
M10	190 mm	16 mm	10 mm	HS8	ISO 4762	0097 10 190	10
M12	16 mm	18 mm	12 mm	HS10	ISO 4762	0097 12 16	100
M12	20 mm	18 mm	12 mm	HS10	ISO 4762	0097 12 20	50
M12	25 mm	18 mm	12 mm	HS10	ISO 4762	0097 12 25	100
M12	30 mm	18 mm	12 mm	HS10	ISO 4762	0097 12 30	50
M12	35 mm	18 mm	12 mm	HS10	ISO 4762	0097 12 35	50/100
M12	40 mm	18 mm	12 mm	HS10	ISO 4762	0097 12 40	50/100
M12	45 mm	18 mm	12 mm	HS10	ISO 4762	0097 12 45	50/100
M12	50 mm	18 mm	12 mm	HS10	ISO 4762	0097 12 50	50/100
M12	55 mm	18 mm	12 mm	HS10	ISO 4762	0097 12 55	100
M12	60 mm	18 mm	12 mm	HS10	ISO 4762	0097 12 60	100
M12	65 mm	18 mm	12 mm	HS10	ISO 4762	0097 12 65	50
M12	70 mm	18 mm	12 mm	HS10	ISO 4762	0097 12 70	50
M12	75 mm	18 mm	12 mm	HS10	ISO 4762	0097 12 75	50
M12	80 mm	18 mm	12 mm	HS10	ISO 4762	0097 12 80	25
M12	85 mm	18 mm	12 mm	HS10	ISO 4762	0097 12 85	50
M12	90 mm	18 mm	12 mm	HS10	ISO 4762	0097 12 90	50
M12	95 mm	18 mm	12 mm	HS10	ISO 4762	0097 12 95	100
M12	100 mm	18 mm	12 mm	HS10	ISO 4762	0097 12 100	50
M12	110 mm	18 mm	12 mm	HS10	ISO 4762	0097 12 110	50

Thread type x nominal diameter (d ₁)	Length (l ₁)	Head diameter (d _k)	Head height (k ₁)	Internal drive (s ₁)	Standards	Art. no.	P. Qty.
M12	120 mm	18 mm	12 mm	HS10	ISO 4762	0097 12 120	50
M12	130 mm	18 mm	12 mm	HS10	ISO 4762	0097 12 130	50
M12	140 mm	18 mm	12 mm	HS10	ISO 4762	0097 12 140	50
M12	150 mm	18 mm	12 mm	HS10	ISO 4762	0097 12 150	50
M12	160 mm	18 mm	12 mm	HS10	ISO 4762	0097 12 160	25
M12	170 mm	18 mm	12 mm	HS10	ISO 4762	0097 12 170	25
M12	180 mm	18 mm	12 mm	HS10	ISO 4762	0097 12 180	25
M12	220 mm	18 mm	12 mm	HS10	ISO 4762	0097 12 220	1
M14	25 mm	21 mm	14 mm	HS12	ISO 4762	0097 14 25	1
M14	35 mm	21 mm	14 mm	HS12	ISO 4762	0097 14 35	100
M14	40 mm	21 mm	14 mm	HS12	ISO 4762	0097 14 40	25
M14	45 mm	21 mm	14 mm	HS12	ISO 4762	0097 14 45	50
M14	75 mm	21 mm	14 mm	HS12	ISO 4762	0097 14 75	100
M16	16 mm	24 mm	16 mm	HS14	ISO 4762	0097 16 16	20
M16	20 mm	24 mm	16 mm	HS14	ISO 4762	0097 16 20	50
M16	25 mm	24 mm	16 mm	HS14	ISO 4762	0097 16 25	25
M16	30 mm	24 mm	16 mm	HS14	ISO 4762	0097 16 30	25
M16	35 mm	24 mm	16 mm	HS14	ISO 4762	0097 16 35	25
M16	40 mm	24 mm	16 mm	HS14	ISO 4762	0097 16 40	25
M16	45 mm	24 mm	16 mm	HS14	ISO 4762	0097 16 45	50
M16	50 mm	24 mm	16 mm	HS14	ISO 4762	0097 16 50	25
M16	55 mm	24 mm	16 mm	HS14	ISO 4762	0097 16 55	50
M16	60 mm	24 mm	16 mm	HS14	ISO 4762	0097 16 60	25
M16	65 mm	24 mm	16 mm	HS14	ISO 4762	0097 16 65	25
M16	70 mm	24 mm	16 mm	HS14	ISO 4762	0097 16 70	25
M16	80 mm	24 mm	16 mm	HS14	ISO 4762	0097 16 80	25
M16	85 mm	24 mm	16 mm	HS14	ISO 4762	0097 16 85	25
M16	90 mm	24 mm	16 mm	HS14	ISO 4762	0097 16 90	25
M16	100 mm	24 mm	16 mm	HS14	ISO 4762	0097 16 100	25
M16	110 mm	24 mm	16 mm	HS14	ISO 4762	0097 16 110	25
M16	120 mm	24 mm	16 mm	HS14	ISO 4762	0097 16 120	25
M16	130 mm	24 mm	16 mm	HS14	ISO 4762	0097 16 130	25
M16	140 mm	24 mm	16 mm	HS14	ISO 4762	0097 16 140	25
M16	160 mm	24 mm	16 mm	HS14	ISO 4762	0097 16 160	10
M16	180 mm	24 mm	16 mm	HS14	ISO 4762	0097 16 180	25
M16	190 mm	24 mm	16 mm	HS14	ISO 4762	0097 16 190	10
M18	50 mm	27 mm	18 mm	HS14	DIN 912	0097 18 50	25
M18	120 mm	27 mm	18 mm	HS14	DIN 912	0097 18 120	5
M20	25 mm	30 mm	20 mm	HS17	ISO 4762	0097 20 25	1
M20	40 mm	30 mm	20 mm	HS17	ISO 4762	0097 20 40	25
M20	45 mm	30 mm	20 mm	HS17	ISO 4762	0097 20 45	25
M20	50 mm	30 mm	20 mm	HS17	ISO 4762	0097 20 50	25
M20	55 mm	30 mm	20 mm	HS17	ISO 4762	0097 20 55	25/50
M20	60 mm	30 mm	20 mm	HS17	ISO 4762	0097 20 60	25
M20	65 mm	30 mm	20 mm	HS17	ISO 4762	0097 20 65	25
M20	70 mm	30 mm	20 mm	HS17	ISO 4762	0097 20 70	25
M20	80 mm	30 mm	20 mm	HS17	ISO 4762	0097 20 80	25
M20	90 mm	30 mm	20 mm	HS17	ISO 4762	0097 20 90	25
M20	95 mm	30 mm	20 mm	HS17	ISO 4762	0097 20 95	25
M20	100 mm	30 mm	20 mm	HS17	ISO 4762	0097 20 100	10/25
M20	110 mm	30 mm	20 mm	HS17	ISO 4762	0097 20 110	10
M20	120 mm	30 mm	20 mm	HS17	ISO 4762	0097 20 120	10/25
M20	130 mm	30 mm	20 mm	HS17	ISO 4762	0097 20 130	10

Thread type x nominal diameter (d ₁)	Length (l ₁)	Head diameter (d _k)	Head height (k ₁)	Internal drive (s ₁)	Standards	Art. no.	P. Qty.
M20	140 mm	30 mm	20 mm	HS17	ISO 4762	0097 20 140	10/25
M20	150 mm	30 mm	20 mm	HS17	ISO 4762	0097 20 150	10/25
M20	160 mm	30 mm	20 mm	HS17	ISO 4762	0097 20 160	25
M20	180 mm	30 mm	20 mm	HS17	ISO 4762	0097 20 180	5
M20	200 mm	30 mm	20 mm	HS17	ISO 4762	0097 20 200	10
M24	40 mm	36 mm	24 mm	HS19	ISO 4762	0097 24 40	10
M24	45 mm	36 mm	24 mm	HS19	ISO 4762	0097 24 45	10
M24	50 mm	36 mm	24 mm	HS19	ISO 4762	0097 24 50	10
M24	55 mm	36 mm	24 mm	HS19	ISO 4762	0097 24 55	10
M24	80 mm	36 mm	24 mm	HS19	ISO 4762	0097 24 80	10
M24	90 mm	36 mm	24 mm	HS19	ISO 4762	0097 24 90	10
M24	100 mm	36 mm	24 mm	HS19	ISO 4762	0097 24 100	10
M24	110 mm	36 mm	24 mm	HS19	ISO 4762	0097 24 110	10
M24	120 mm	36 mm	24 mm	HS19	ISO 4762	0097 24 120	10
M24	130 mm	36 mm	24 mm	HS19	ISO 4762	0097 24 130	10
M24	140 mm	36 mm	24 mm	HS19	ISO 4762	0097 24 140	10
M24	150 mm	36 mm	24 mm	HS19	ISO 4762	0097 24 150	10
M24	180 mm	36 mm	24 mm	HS19	ISO 4762	0097 24 180	5
M24	200 mm	36 mm	24 mm	HS19	ISO 4762	0097 24 200	5
M36	120 mm	54 mm	36 mm	HS27	ISO 4762	0097 36 120	5

Details/Application

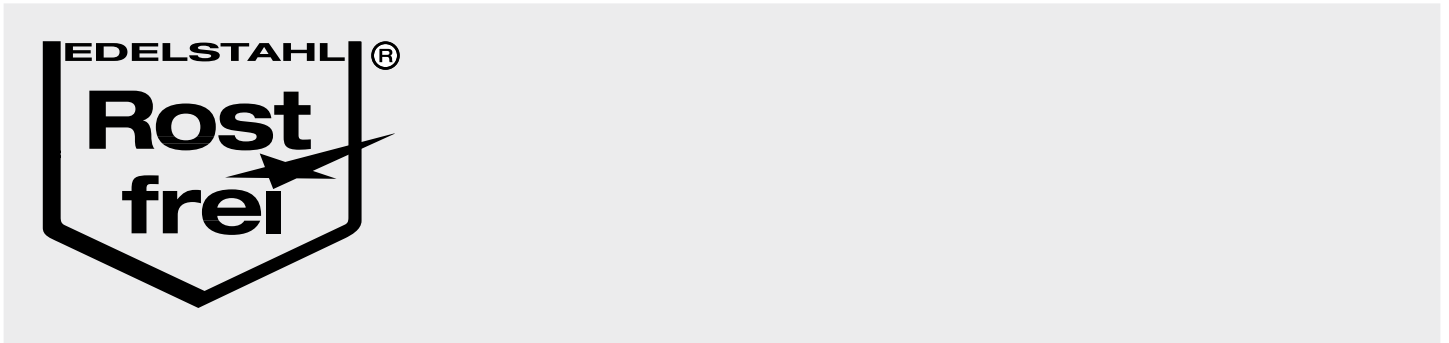

Notice

ISO 4762 replaces DIN 912 | There is some similarity | Nominal range changed | Fine thread moved to ISO 12474.