

Hexagonal bolt with thread up to the head

DIN 933, stainless steel, A2, plain

Standards	DIN 933
Material	Stainless steel A2
Property class	70
Surface	Plain
RoHS-compliant	Yes

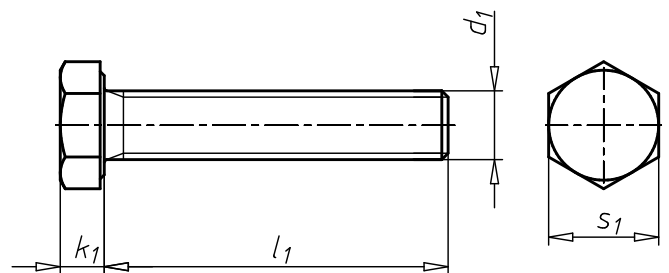

Thread type x nominal diameter (d ₁)	Length (l ₁)	Head height (k ₁)	External drive (s ₁)	Art. no.	P. Qty.
M10	8 mm	6.4 mm	WS17	0096 10 8	100
M10	10 mm	6.4 mm	WS17	0096 10 10	100
M10	12 mm	6.4 mm	WS17	0096 10 12	100/200
M10	14 mm	6.4 mm	WS17	0096 10 14	200
M10	16 mm	6.4 mm	WS17	0096 10 16	100/200
M10	18 mm	6.4 mm	WS17	0096 10 18	100
M10	20 mm	6.4 mm	WS17	0096 10 20	100/200 /400
M10	22 mm	6.4 mm	WS17	0096 10 22	100
M10	25 mm	6.4 mm	WS17	0096 10 25	100/400
M10	30 mm	6.4 mm	WS17	0096 10 30	100/250 /400
M10	35 mm	6.4 mm	WS17	0096 10 35	100/400
M10	40 mm	6.4 mm	WS17	0096 10 40	100
M10	45 mm	6.4 mm	WS17	0096 10 45	100
M10	50 mm	6.4 mm	WS17	0096 10 50	100
M10	55 mm	6.4 mm	WS17	0096 10 55	50
M10	60 mm	6.4 mm	WS17	0096 10 60	50
M10	65 mm	6.4 mm	WS17	0096 10 65	50
M10	70 mm	6.4 mm	WS17	0096 10 70	50
M10	75 mm	6.4 mm	WS17	0096 10 75	50
M10	80 mm	6.4 mm	WS17	0096 10 80	50/100
M10	85 mm	6.4 mm	WS17	0096 10 85	100
M10	90 mm	6.4 mm	WS17	0096 10 90	50
M10	95 mm	6.4 mm	WS17	0096 10 95	50
M10	100 mm	6.4 mm	WS17	0096 10 100	50
M10	110 mm	6.4 mm	WS17	0096 10 110	50
M10	120 mm	6.4 mm	WS17	0096 10 120	50
M10	130 mm	6.4 mm	WS17	0096 10 130	50

Thread type x nominal diameter (d ₁)	Length (l ₁)	Head height (k ₁)	External drive (s ₁)	Art. no.	P. Qty.
M10	140 mm	6.4 mm	WS17	0096 10 140	50
M10	150 mm	6.4 mm	WS17	0096 10 150	50
M10	160 mm	6.4 mm	WS17	0096 10 160	50
M10	170 mm	6.4 mm	WS17	0096 10 170	50
M10	180 mm	6.4 mm	WS17	0096 10 180	50
M10	200 mm	6.4 mm	WS17	0096 10 200	50
M10	210 mm	6.4 mm	WS17	0096 10 210	25
M12	10 mm	7.5 mm	WS19	0096 12 10	100
M12	12 mm	7.5 mm	WS19	0096 12 12	100
M12	16 mm	7.5 mm	WS19	0096 12 16	50
M12	20 mm	7.5 mm	WS19	0096 12 20	50/100 /200
M12	25 mm	7.5 mm	WS19	0096 12 25	50/100
M12	30 mm	7.5 mm	WS19	0096 12 30	50/100 /200
M12	35 mm	7.5 mm	WS19	0096 12 35	50/100
M12	40 mm	7.5 mm	WS19	0096 12 40	50/100
M12	45 mm	7.5 mm	WS19	0096 12 45	50
M12	50 mm	7.5 mm	WS19	0096 12 50	50/100
M12	55 mm	7.5 mm	WS19	0096 12 55	50
M12	60 mm	7.5 mm	WS19	0096 12 60	50/100
M12	65 mm	7.5 mm	WS19	0096 12 65	50
M12	70 mm	7.5 mm	WS19	0096 12 70	25/50
M12	75 mm	7.5 mm	WS19	0096 12 75	25/50
M12	80 mm	7.5 mm	WS19	0096 12 80	25/50
M12	85 mm	7.5 mm	WS19	0096 12 85	25/50
M12	90 mm	7.5 mm	WS19	0096 12 90	25/50
M12	95 mm	7.5 mm	WS19	0096 12 95	50
M12	100 mm	7.5 mm	WS19	0096 12 100	25
M12	110 mm	7.5 mm	WS19	0096 12 110	25/50
M12	120 mm	7.5 mm	WS19	0096 12 120	25/50
M12	130 mm	7.5 mm	WS19	0096 12 130	25/50
M12	140 mm	7.5 mm	WS19	0096 12 140	25
M12	150 mm	7.5 mm	WS19	0096 12 150	25/50
M12	155 mm	7.5 mm	WS19	0096 12 155	50
M12	160 mm	7.5 mm	WS19	0096 12 160	10/25
M12	170 mm	7.5 mm	WS19	0096 12 170	50
M12	180 mm	7.5 mm	WS19	0096 12 180	10/25
M12	190 mm	7.5 mm	WS19	0096 12 190	25
M12	200 mm	7.5 mm	WS19	0096 12 200	25
M12	230 mm	7.5 mm	WS19	0096 12 230	10
M12	250 mm	7.5 mm	WS19	0096 12 250	1
M12	300 mm	7.5 mm	WS19	0096 12 300	10
M14	20 mm	8.8 mm	WS22	0096 14 20	50
M14	25 mm	8.8 mm	WS22	0096 14 25	50
M14	30 mm	8.8 mm	WS22	0096 14 30	50
M14	35 mm	8.8 mm	WS22	0096 14 35	50
M14	40 mm	8.8 mm	WS22	0096 14 40	50
M14	45 mm	8.8 mm	WS22	0096 14 45	50
M14	50 mm	8.8 mm	WS22	0096 14 50	50
M14	55 mm	8.8 mm	WS22	0096 14 55	50
M14	60 mm	8.8 mm	WS22	0096 14 60	50
M14	65 mm	8.8 mm	WS22	0096 14 65	50
M14	70 mm	8.8 mm	WS22	0096 14 70	50

Thread type x nominal diameter (d ₁)	Length (l ₁)	Head height (k ₁)	External drive (s ₁)	Art. no.	P. Qty.
M14	75 mm	8.8 mm	WS22	0096 14 75	50
M14	80 mm	8.8 mm	WS22	0096 14 80	50
M14	90 mm	8.8 mm	WS22	0096 14 90	50
M14	100 mm	8.8 mm	WS22	0096 14 100	50
M14	110 mm	8.8 mm	WS22	0096 14 110	25
M14	130 mm	8.8 mm	WS22	0096 14 130	25
M14	150 mm	8.8 mm	WS22	0096 14 150	10
M22	50 mm	14 mm	WS32	0096 22 50	25
M22	65 mm	14 mm	WS32	0096 22 65	25
M22	70 mm	14 mm	WS32	0096 22 70	25
M22	90 mm	14 mm	WS32	0096 22 90	25
M22	100 mm	14 mm	WS32	0096 22 100	25
M22	110 mm	14 mm	WS32	0096 22 110	10
M22	250 mm	14 mm	WS32	0096 22 250	10

Notice

DIN 933 has been withdrawn and replaced by ISO 4017. There is some similarity (nominal dimensions extended | Width across flats changed for M10, M12, M14 and M22).