

Hexagonal bolt with thread up to the head

ISO 4017, steel 8.8, galvanised, blue passivated (A2K)

Standards	ISO 4017
-----------	----------

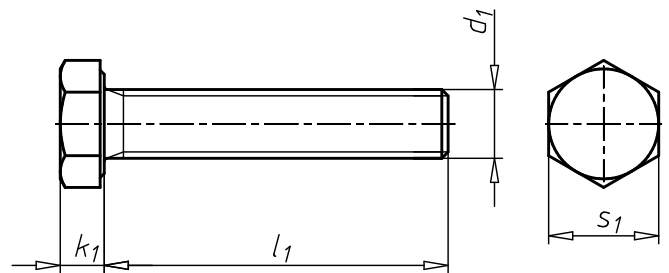
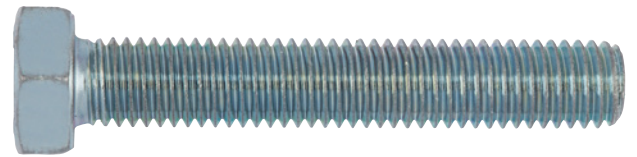

Thread type x nominal diameter (d ₁)	Length (l ₁)	Head height (k ₁)	External drive (s ₁)	Material	Property class	Surface	Corrosion protection period	RoHS-compliant	Art. no.	P. Qty.
									0057 8 15	100
M2	10 mm	1.4 mm	WS4	Steel	8.8	Zinc plated		Yes	0057 2 10	100
M2	16 mm	1.4 mm	WS4	Steel	8.8	Zinc plated		Yes	0057 2 16	200
M3	4 mm	2 mm	WS5.5	Steel	8.8	Zinc plated		Yes	0057 3 4	200
M3	5 mm	2 mm	WS5.5	Steel	8.8	Zinc plated		Yes	0057 3 5	2000
M3	6 mm	2 mm	WS5.5	Steel	8.8	Zinc plated		Yes	0057 3 6	200/1000
M3	8 mm	2 mm	WS5.5	Steel	8.8	Zinc plated		Yes	0057 3 8	200/500
M3	10 mm	2 mm	WS5.5	Steel	8.8	Zinc plated		Yes	0057 3 10	200/1000
M3	12 mm	2 mm	WS5.5	Steel	8.8	Zinc plated		Yes	0057 3 12	200
M3	14 mm	2 mm	WS5.5	Steel	8.8	Zinc plated		Yes	0057 3 14	500
M3	16 mm	2 mm	WS5.5	Steel	8.8	Zinc plated		Yes	0057 3 16	200/1000
M3	18 mm	2 mm	WS5.5	Steel	8.8	Zinc plated		Yes	0057 3 18	1000
M3	20 mm	2 mm	WS5.5	Steel	8.8	Zinc plated		Yes	0057 3 20	200/500
M3	25 mm	2 mm	WS5.5	Steel	8.8	Zinc plated		Yes	0057 3 25	100/1000
M3	30 mm	2 mm	WS5.5	Steel	8.8	Zinc plated		Yes	0057 3 30	100/1000
M3	35 mm	2 mm	WS5.5	Steel	8.8	Zinc plated		Yes	0057 3 35	1000
M3	40 mm	2 mm	WS5.5	Steel	8.8	Zinc plated		Yes	0057 3 40	100
M3	45 mm	2 mm	WS5.5	Steel	8.8	Zinc plated		Yes	0057 3 45	500
M3	50 mm	2 mm	WS5.5	Steel	8.8	Zinc plated		Yes	0057 3 50	100
M4	4 mm	2.8 mm	WS7	Steel	8.8	Zinc plated		Yes	0057 4 4	500
M4	5 mm	2.8 mm	WS7	Steel	8.8	Zinc plated		Yes	0057 4 5	500
M4	6 mm	2.8 mm	WS7	Steel	8.8	Zinc plated		Yes	0057 4 6	200/1000
M4	8 mm	2.8 mm	WS7	Steel	8.8	Zinc plated		Yes	0057 4 8	200/500
M4	10 mm	2.8 mm	WS7	Steel	8.8	Zinc plated		Yes	0057 4 10	200/500 /1000
M4	12 mm	2.8 mm	WS7	Steel	8.8	Zinc plated		Yes	0057 4 12	200/500 /1000
M4	14 mm	2.8 mm	WS7	Steel	8.8	Zinc plated		Yes	0057 4 14	500
M4	16 mm	2.8 mm	WS7	Steel	8.8	Zinc plated		Yes	0057 4 16	200/500 /1000

Thread type x nominal diameter (d ₁)	Length (l ₁)	Head height (k ₁)	External drive (s ₁)	Material	Property class	Surface	Corrosion protection period	RoHS-compliant	Art. no.	P. Qty.
M4	18 mm	2.8 mm	WS7	Steel	8.8	Zinc plated		Yes	0057 4 18	1000
M4	20 mm	2.8 mm	WS7	Steel	8.8	Zinc plated		Yes	0057 4 20	200/500 /1000
M4	22 mm	2.8 mm	WS7	Steel	8.8	Zinc plated		Yes	0057 4 22	1000
M4	25 mm	2.8 mm	WS7	Steel	8.8	Zinc plated		Yes	0057 4 25	200/500
M4	30 mm	2.8 mm	WS7	Steel	8.8	Zinc plated		Yes	0057 4 30	200/500
M4	35 mm	2.8 mm	WS7	Steel	8.8	Zinc plated		Yes	0057 4 35	200/500
M4	40 mm	2.8 mm	WS7	Steel	8.8	Zinc plated		Yes	0057 4 40	200/500
M4	45 mm	2.8 mm	WS7	Steel	8.8	Zinc plated		Yes	0057 4 45	200/500
M4	50 mm	2.8 mm	WS7	Steel	8.8	Zinc plated		Yes	0057 4 50	200/500
M4	55 mm	2.8 mm	WS7	Steel	8.8	Zinc plated		Yes	0057 4 55	100/500
M4	60 mm	2.8 mm	WS7	Steel	8.8	Zinc plated		Yes	0057 4 60	100
M4	65 mm	2.8 mm	WS7	Steel	8.8	Zinc plated		Yes	0057 4 65	200
M4	70 mm	2.8 mm	WS7	Steel	8.8	Zinc plated		Yes	0057 4 70	100
M4	80 mm	2.8 mm	WS7	Steel	8.8	Zinc plated		Yes	0057 4 80	100
M4	100 mm	2.8 mm	WS7	Steel	8.8	Zinc plated		Yes	0057 4 100	500
M5	6 mm	3.5 mm	WS8	Steel	8.8	Zinc plated		Yes	0057 5 6	200/1000
M5	8 mm	3.5 mm	WS8	Steel	8.8	Zinc plated		Yes	0057 5 8	200/500
M5	10 mm	3.5 mm	WS8	Steel	8.8	Zinc plated		Yes	0057 5 10	200/1000
M5	12 mm	3.5 mm	WS8	Steel	8.8	Zinc plated		Yes	0057 5 12	200/500
M5	14 mm	3.5 mm	WS8	Steel	8.8	Zinc plated		Yes	0057 5 14	200/500
M5	15 mm	3.5 mm	WS8	Steel	8.8	Zinc plated		Yes	0057 5 15	500
M5	16 mm	3.5 mm	WS8	Steel	8.8	Zinc plated		Yes	0057 5 16	200/500
M5	18 mm	3.5 mm	WS8	Steel	8.8	Zinc plated		Yes	0057 5 18	200/500
M5	20 mm	3.5 mm	WS8	Steel	8.8	Zinc plated		Yes	0057 5 20	200/500
M5	22 mm	3.5 mm	WS8	Steel	8.8	Zinc plated		Yes	0057 5 22	500
M5	25 mm	3.5 mm	WS8	Steel	8.8	Zinc plated		Yes	0057 5 25	200/500
M5	28 mm	3.5 mm	WS8	Steel	8.8	Zinc plated		Yes	0057 5 28	100
M5	30 mm	3.5 mm	WS8	Steel	8.8	Zinc plated		Yes	0057 5 30	200/500
M5	35 mm	3.5 mm	WS8	Steel	8.8	Zinc plated		Yes	0057 5 35	200
M5	40 mm	3.5 mm	WS8	Steel	8.8	Zinc plated		Yes	0057 5 40	200
M5	45 mm	3.5 mm	WS8	Steel	8.8	Zinc plated		Yes	0057 5 45	200/500
M5	50 mm	3.5 mm	WS8	Steel	8.8	Zinc plated		Yes	0057 5 50	200/500
M5	55 mm	3.5 mm	WS8	Steel	8.8	Zinc plated		Yes	0057 5 55	100/200
M5	60 mm	3.5 mm	WS8	Steel	8.8	Zinc plated		Yes	0057 5 60	200/400
M5	65 mm	3.5 mm	WS8	Steel	8.8	Zinc plated		Yes	0057 5 65	100
M5	70 mm	3.5 mm	WS8	Steel	8.8	Zinc plated		Yes	0057 5 70	100/200
M5	75 mm	3.26 mm	WS8	Steel	8.8	Zinc plated	36 h	Yes	0057 5 75	200
M5	80 mm	3.5 mm	WS8	Steel	8.8	Zinc plated		Yes	0057 5 80	100
M5	90 mm	3.5 mm	WS8	Steel	8.8	Zinc plated		Yes	0057 5 90	100
M5	100 mm	3.5 mm	WS8	Steel	8.8	Zinc plated		Yes	0057 5 100	100
M6	6 mm	4 mm	WS10	Steel	8.8	Zinc plated		Yes	0057 6 6	200/500
M6	8 mm	4 mm	WS10	Steel	8.8	Zinc plated		Yes	0057 6 8	200/1000
M6	10 mm	4 mm	WS10	Steel	8.8	Zinc plated		Yes	0057 6 10	200/1000
M6	12 mm	4 mm	WS10	Steel	8.8	Zinc plated		Yes	0057 6 12	200/1000
M6	14 mm	4 mm	WS10	Steel	8.8	Zinc plated		Yes	0057 6 14	200/1000
M6	16 mm	4 mm	WS10	Steel	8.8	Zinc plated		Yes	0057 6 16	200/1000
M6	18 mm	4 mm	WS10	Steel	8.8	Zinc plated		Yes	0057 6 18	200/1000
M6	20 mm	4 mm	WS10	Steel	8.8	Zinc plated		Yes	0057 6 20	200/500 /1000
M6	22 mm	4 mm	WS10	Steel	8.8	Zinc plated		Yes	0057 6 22	200/500

Thread type x nominal diameter (d ₁)	Length (l ₁)	Head height (k ₁)	External drive (s ₁)	Material	Property class	Surface	Corrosion protection period	RoHS-compliant	Art. no.	P. Qty.
M6	25 mm	4 mm	WS10	Steel	8.8	Zinc plated		Yes	0057 6 25	200/500
M6	27 mm	4 mm	WS10	Steel	8.8	Zinc plated		Yes	0057 6 27	500
M6	28 mm	4 mm	WS10	Steel	8.8	Zinc plated		Yes	0057 6 28	500
M6	30 mm	4 mm	WS10	Steel	8.8	Zinc plated		Yes	0057 6 30	200/500
M6	35 mm	4 mm	WS10	Steel	8.8	Zinc plated		Yes	0057 6 35	200
M6	40 mm	4 mm	WS10	Steel	8.8	Zinc plated		Yes	0057 6 40	100/200/500
M6	45 mm	4 mm	WS10	Steel	8.8	Zinc plated		Yes	0057 6 45	100/200
M6	50 mm	4 mm	WS10	Steel	8.8	Zinc plated		Yes	0057 6 50	100/200
M6	55 mm	4 mm	WS10	Steel	8.8	Zinc plated		Yes	0057 6 55	100/200
M6	60 mm	4 mm	WS10	Steel	8.8	Zinc plated		Yes	0057 6 60	100/200
M6	65 mm	4 mm	WS10	Steel	8.8	Zinc plated		Yes	0057 6 65	100/200
M6	70 mm	4 mm	WS10	Steel	8.8	Zinc plated		Yes	0057 6 70	100/200
M6	75 mm	4 mm	WS10	Steel	8.8	Zinc plated		Yes	0057 6 75	100
M6	80 mm	4 mm	WS10	Steel	8.8	Zinc plated		Yes	0057 6 80	100/200
M6	85 mm	4 mm	WS10	Steel	8.8	Zinc plated		Yes	0057 6 85	200
M6	90 mm	4 mm	WS10	Steel	8.8	Zinc plated		Yes	0057 6 90	100/200
M6	100 mm	4 mm	WS10	Steel	8.8	Zinc plated		Yes	0057 6 100	100
M6	110 mm	4 mm	WS10	Steel	8.8	Zinc plated		Yes	0057 6 110	100
M6	120 mm	4 mm	WS10	Steel	8.8	Zinc plated		Yes	0057 6 120	100
M6	130 mm	4 mm	WS10	Steel	8.8	Zinc plated		Yes	0057 6 130	100
M6	135 mm	4 mm	WS10	Steel	8.8	Zinc plated		Yes	0057 6 135	50
M6	140 mm	4 mm	WS10	Steel	8.8	Zinc plated		Yes	0057 6 140	100
M6	150 mm	4 mm	WS10	Steel	8.8	Zinc plated		Yes	0057 6 150	100
M6	160 mm	4 mm	WS10	Steel	8.8	Zinc plated		Yes	0057 6 160	10
M6	180 mm	4 mm	WS10	Steel	8.8	Zinc plated		Yes	0057 6 180	50
M8	8 mm	5.3 mm	WS13	Steel	8.8	Zinc plated		Yes	0057 8 8	200
M8	10 mm	5.3 mm	WS13	Steel	8.8	Zinc plated		Yes	0057 8 10	100/200
M8	12 mm	5.3 mm	WS13	Steel	8.8	Zinc plated		Yes	0057 8 12	100/200
M8	14 mm	5.3 mm	WS13	Steel	8.8	Zinc plated		Yes	0057 8 14	200/500
M8	16 mm	5.3 mm	WS13	Steel	8.8	Zinc plated		Yes	0057 8 16	200/500
M8	18 mm	5.3 mm	WS13	Steel	8.8	Zinc plated		Yes	0057 8 18	100/200
M8	20 mm	5.3 mm	WS13	Steel	8.8	Zinc plated		Yes	0057 8 20	200/500
M8	22 mm	5.3 mm	WS13	Steel	8.8	Zinc plated		Yes	0057 8 22	100/200
M8	25 mm	5.3 mm	WS13	Steel	8.8	Zinc plated		Yes	0057 8 25	200/500
M8	28 mm	5.3 mm	WS13	Steel	8.8	Zinc plated		Yes	0057 8 28	400
M8	30 mm	5.3 mm	WS13	Steel	8.8	Zinc plated		Yes	0057 8 30	200/400
M8	35 mm	5.3 mm	WS13	Steel	8.8	Zinc plated		Yes	0057 8 35	200
M8	40 mm	5.3 mm	WS13	Steel	8.8	Zinc plated		Yes	0057 8 40	200/250
M8	45 mm	5.3 mm	WS13	Steel	8.8	Zinc plated		Yes	0057 8 45	100/200
M8	50 mm	5.3 mm	WS13	Steel	8.8	Zinc plated		Yes	0057 8 50	100/200
M8	55 mm	5.3 mm	WS13	Steel	8.8	Zinc plated		Yes	0057 8 55	100/200
M8	60 mm	5.3 mm	WS13	Steel	8.8	Zinc plated		Yes	0057 8 60	100/200
M8	65 mm	5.3 mm	WS13	Steel	8.8	Zinc plated		Yes	0057 8 65	50/200
M8	70 mm	5.3 mm	WS13	Steel	8.8	Zinc plated		Yes	0057 8 70	50/200
M8	75 mm	5.3 mm	WS13	Steel	8.8	Zinc plated		Yes	0057 8 75	50/200
M8	80 mm	5.3 mm	WS13	Steel	8.8	Zinc plated		Yes	0057 8 80	50/200
M8	85 mm	5.3 mm	WS13	Steel	8.8	Zinc plated		Yes	0057 8 85	100
M8	90 mm	5.3 mm	WS13	Steel	8.8	Zinc plated		Yes	0057 8 90	50/100
M8	95 mm	5.3 mm	WS13	Steel	8.8	Zinc plated		Yes	0057 8 95	100
M8	100 mm	5.3 mm	WS13	Steel	8.8	Zinc plated		Yes	0057 8 100	50/100

Thread type x nominal diameter (d ₁)	Length (l ₁)	Head height (k ₁)	External drive (s ₁)	Material	Property class	Surface	Corrosion protection period	RoHS-compliant	Art. no.	P. Qty.
M8	110 mm	5.3 mm	WS13	Steel	8.8	Zinc plated		Yes	0057 8 110	50/75
M8	115 mm	5.3 mm	WS13	Steel	8.8	Zinc plated		Yes	0057 8 115	100
M8	120 mm	5.3 mm	WS13	Steel	8.8	Zinc plated		Yes	0057 8 120	50/100
M8	125 mm	5.3 mm	WS13	Steel	8.8	Zinc plated		Yes	0057 8 125	100
M8	130 mm	5.3 mm	WS13	Steel	8.8	Zinc plated		Yes	0057 8 130	50/100
M8	140 mm	5.3 mm	WS13	Steel	8.8	Zinc plated		Yes	0057 8 140	50
M8	150 mm	5.3 mm	WS13	Steel	8.8	Zinc plated		Yes	0057 8 150	50
M8	160 mm	5.3 mm	WS13	Steel	8.8	Zinc plated		Yes	0057 8 160	50
M8	170 mm	5.3 mm	WS13	Steel	8.8	Zinc plated		Yes	0057 8 170	50
M8	180 mm	5.3 mm	WS13	Steel	8.8	Zinc plated		Yes	0057 8 180	50
M8	190 mm	5.3 mm	WS13	Steel	8.8	Zinc plated		Yes	0057 8 190	50
M8	200 mm	5.3 mm	WS13	Steel	8.8	Zinc plated		Yes	0057 8 200	100
M8	220 mm	5.3 mm	WS13	Steel	8.8	Zinc plated		Yes	0057 8 220	50
M8	240 mm	5.3 mm	WS13	Steel	8.8	Zinc plated		Yes	0057 8 240	25
M8	250 mm	5.3 mm	WS13	Steel	8.8	Zinc plated		Yes	0057 8 250	50
M10	10 mm	6.4 mm	WS16	Steel	8.8	Zinc plated		Yes	0057 910 10	200
M10	12 mm	6.4 mm	WS16	Steel	8.8	Zinc plated		Yes	0057 910 12	200
M10	14 mm	6.4 mm	WS16	Steel	8.8	Zinc plated		Yes	0057 910 14	200
M10	16 mm	6.4 mm	WS16	Steel	8.8	Zinc plated		Yes	0057 910 16	200
M10	18 mm	6.4 mm	WS16	Steel	8.8	Zinc plated		Yes	0057 910 18	200
M10	20 mm	6.4 mm	WS16	Steel	8.8	Zinc plated		Yes	0057 910 20	200
M10	22 mm	6.4 mm	WS16	Steel	8.8	Zinc plated		Yes	0057 910 22	100
M10	25 mm	6.4 mm	WS16	Steel	8.8	Zinc plated		Yes	0057 910 25	200
M10	30 mm	6.4 mm	WS16	Steel	8.8	Zinc plated		Yes	0057 910 30	200
M10	35 mm	6.4 mm	WS16	Steel	8.8	Zinc plated		Yes	0057 910 35	100/200
M10	40 mm	6.4 mm	WS16	Steel	8.8	Zinc plated		Yes	0057 910 40	50/100
M10	45 mm	6.4 mm	WS16	Steel	8.8	Zinc plated		Yes	0057 910 45	100
M10	50 mm	6.4 mm	WS16	Steel	8.8	Zinc plated		Yes	0057 910 50	100
M10	55 mm	6.4 mm	WS16	Steel	8.8	Zinc plated		Yes	0057 910 55	100
M10	60 mm	6.4 mm	WS16	Steel	8.8	Zinc plated		Yes	0057 910 60	100
M10	65 mm	6.4 mm	WS16	Steel	8.8	Zinc plated		Yes	0057 910 65	100
M10	70 mm	6.4 mm	WS16	Steel	8.8	Zinc plated		Yes	0057 910 70	100
M10	75 mm	6.4 mm	WS16	Steel	8.8	Zinc plated		Yes	0057 910 75	50
M10	80 mm	6.4 mm	WS16	Steel	8.8	Zinc plated		Yes	0057 910 80	50/100
M10	85 mm	6.4 mm	WS16	Steel	8.8	Zinc plated		Yes	0057 910 85	200
M10	90 mm	6.4 mm	WS16	Steel	8.8	Zinc plated		Yes	0057 910 90	100
M10	95 mm	6.4 mm	WS16	Steel	8.8	Zinc plated		Yes	0057 910 95	50
M10	100 mm	6.4 mm	WS16	Steel	8.8	Zinc plated		Yes	0057 910 100	50
M10	110 mm	6.4 mm	WS16	Steel	8.8	Zinc plated		Yes	0057 910 110	50
M10	120 mm	6.4 mm	WS16	Steel	8.8	Zinc plated		Yes	0057 910 120	50
M10	130 mm	6.4 mm	WS16	Steel	8.8	Zinc plated		Yes	0057 910 130	50
M10	140 mm	6.4 mm	WS16	Steel	8.8	Zinc plated		Yes	0057 910 140	50
M10	150 mm	6.4 mm	WS16	Steel	8.8	Zinc plated		Yes	0057 910 150	50
M10	160 mm	6.4 mm	WS16	Steel	8.8	Zinc plated		Yes	0057 910 160	50
M10	170 mm	6.4 mm	WS16	Steel	8.8	Zinc plated		Yes	0057 910 170	50
M10	250 mm	6.4 mm	WS16	Steel	8.8	Zinc plated		Yes	0057 910 250	25
M12	16 mm	7.5 mm	WS18	Steel	8.8	Zinc plated		Yes	0057 912 16	100/200
M12	20 mm	7.5 mm	WS18	Steel	8.8	Zinc plated		Yes	0057 912 20	100
M12	22 mm	7.5 mm	WS18	Steel	8.8	Zinc plated		Yes	0057 912 22	100
M12	25 mm	7.5 mm	WS18	Steel	8.8	Zinc plated		Yes	0057 912 25	100
M12	30 mm	7.5 mm	WS18	Steel	8.8	Zinc plated		Yes	0057 912 30	50/100

Thread type x nominal diameter (d ₁)	Length (l ₁)	Head height (k ₁)	External drive (s ₁)	Material	Property class	Surface	Corrosion protection period	RoHS-compliant	Art. no.	P. Qty.
M12	35 mm	7.5 mm	WS18	Steel	8.8	Zinc plated		Yes	0057 912 35	50/100
M12	40 mm	7.5 mm	WS18	Steel	8.8	Zinc plated		Yes	0057 912 40	50/100
M12	45 mm	7.5 mm	WS18	Steel	8.8	Zinc plated		Yes	0057 912 45	50/100
M12	50 mm	7.5 mm	WS18	Steel	8.8	Zinc plated		Yes	0057 912 50	50/100
M12	55 mm	7.5 mm	WS18	Steel	8.8	Zinc plated		Yes	0057 912 55	50/100
M12	60 mm	7.5 mm	WS18	Steel	8.8	Zinc plated		Yes	0057 912 60	50
M12	65 mm	7.5 mm	WS18	Steel	8.8	Zinc plated		Yes	0057 912 65	50
M12	70 mm	7.5 mm	WS18	Steel	8.8	Zinc plated		Yes	0057 912 70	50
M12	75 mm	7.5 mm	WS18	Steel	8.8	Zinc plated		Yes	0057 912 75	50
M12	80 mm	7.5 mm	WS18	Steel	8.8	Zinc plated		Yes	0057 912 80	50
M12	85 mm	7.5 mm	WS18	Steel	8.8	Zinc plated		Yes	0057 912 85	50
M12	90 mm	7.5 mm	WS18	Steel	8.8	Zinc plated		Yes	0057 912 90	50
M12	95 mm	7.5 mm	WS18	Steel	8.8	Zinc plated		Yes	0057 912 95	1
M12	100 mm	7.5 mm	WS18	Steel	8.8	Zinc plated		Yes	0057 912 100	25/50
M12	110 mm	7.5 mm	WS18	Steel	8.8	Zinc plated		Yes	0057 912 110	25/50
M12	120 mm	7.5 mm	WS18	Steel	8.8	Zinc plated		Yes	0057 912 120	25/50
M12	130 mm	7.5 mm	WS18	Steel	8.8	Zinc plated		Yes	0057 912 130	25/50
M12	140 mm	7.5 mm	WS18	Steel	8.8	Zinc plated		Yes	0057 912 140	25/50
M12	150 mm	7.5 mm	WS18	Steel	8.8	Zinc plated		Yes	0057 912 150	50
M12	160 mm	7.5 mm	WS18	Steel	8.8	Zinc plated		Yes	0057 912 160	25/50
M12	170 mm	7.5 mm	WS18	Steel	8.8	Zinc plated		Yes	0057 912 170	25
M12	180 mm	7.5 mm	WS18	Steel	8.8	Zinc plated		Yes	0057 912 180	25
M12	200 mm	7.5 mm	WS18	Steel	8.8	Zinc plated		Yes	0057 912 200	25
M12	220 mm	7.5 mm	WS18	Steel	8.8	Zinc plated		Yes	0057 912 220	25
M12	280 mm	7.5 mm	WS18	Steel	8.8	Zinc plated		Yes	0057 912 280	10
M12	320 mm	7.5 mm	WS18	Steel	8.8	Zinc plated		Yes	0057 912 320	25
M14	20 mm	8.8 mm	WS21	Steel	8.8	Zinc plated		Yes	0057 914 20	100
M14	25 mm	8.8 mm	WS21	Steel	8.8	Zinc plated		Yes	0057 914 25	50/100
M14	30 mm	8.8 mm	WS21	Steel	8.8	Zinc plated		Yes	0057 914 30	100
M14	35 mm	8.8 mm	WS21	Steel	8.8	Zinc plated		Yes	0057 914 35	100
M14	40 mm	8.8 mm	WS21	Steel	8.8	Zinc plated		Yes	0057 914 40	100
M14	45 mm	8.8 mm	WS21	Steel	8.8	Zinc plated		Yes	0057 914 45	50
M14	50 mm	8.8 mm	WS21	Steel	8.8	Zinc plated		Yes	0057 914 50	50
M14	55 mm	8.8 mm	WS21	Steel	8.8	Zinc plated		Yes	0057 914 55	50
M14	60 mm	8.8 mm	WS21	Steel	8.8	Zinc plated		Yes	0057 914 60	50
M14	70 mm	8.8 mm	WS21	Steel	8.8	Zinc plated		Yes	0057 914 70	50
M14	80 mm	8.8 mm	WS21	Steel	8.8	Zinc plated		Yes	0057 914 80	50
M14	90 mm	8.8 mm	WS21	Steel	8.8	Zinc plated		Yes	0057 914 90	50
M14	100 mm	8.8 mm	WS21	Steel	8.8	Zinc plated		Yes	0057 914 100	25
M14	120 mm	8.8 mm	WS21	Steel	8.8	Zinc plated		Yes	0057 914 120	25
M16	12 mm	10 mm	WS24	Steel	8.8	Zinc plated		Yes	0057 16 12	50
M16	16 mm	10 mm	WS24	Steel	8.8	Zinc plated		Yes	0057 16 16	100
M16	20 mm	10 mm	WS24	Steel	8.8	Zinc plated		Yes	0057 16 20	50/100
M16	25 mm	10 mm	WS24	Steel	8.8	Zinc plated		Yes	0057 16 25	50
M16	30 mm	10 mm	WS24	Steel	8.8	Zinc plated		Yes	0057 16 30	50
M16	35 mm	10 mm	WS24	Steel	8.8	Zinc plated		Yes	0057 16 35	50
M16	40 mm	10 mm	WS24	Steel	8.8	Zinc plated		Yes	0057 16 40	50
M16	45 mm	10 mm	WS24	Steel	8.8	Zinc plated		Yes	0057 16 45	50
M16	50 mm	10 mm	WS24	Steel	8.8	Zinc plated		Yes	0057 16 50	50
M16	55 mm	10 mm	WS24	Steel	8.8	Zinc plated		Yes	0057 16 55	50
M16	60 mm	10 mm	WS24	Steel	8.8	Zinc plated		Yes	0057 16 60	50

Thread type x nominal diameter (d ₁)	Length (l ₁)	Head height (k ₁)	External drive (s ₁)	Material	Property class	Surface	Corrosion protection period	RoHS-compliant	Art. no.	P. Qty.
M16	65 mm	10 mm	WS24	Steel	8.8	Zinc plated		Yes	0057 16 65	25
M16	70 mm	10 mm	WS24	Steel	8.8	Zinc plated		Yes	0057 16 70	25
M16	75 mm	10 mm	WS24	Steel	8.8	Zinc plated		Yes	0057 16 75	25
M16	80 mm	10 mm	WS24	Steel	8.8	Zinc plated		Yes	0057 16 80	25
M16	85 mm	10 mm	WS24	Steel	8.8	Zinc plated		Yes	0057 16 85	25
M16	90 mm	10 mm	WS24	Steel	8.8	Zinc plated		Yes	0057 16 90	25
M16	95 mm	10 mm	WS24	Steel	8.8	Zinc plated		Yes	0057 16 95	25
M16	100 mm	10 mm	WS24	Steel	8.8	Zinc plated		Yes	0057 16 100	25
M16	110 mm	10 mm	WS24	Steel	8.8	Zinc plated		Yes	0057 16 110	25
M16	120 mm	10 mm	WS24	Steel	8.8	Zinc plated		Yes	0057 16 120	25
M16	125 mm	10 mm	WS24	Steel	8.8	Zinc plated		Yes	0057 16 125	50
M16	130 mm	10 mm	WS24	Steel	8.8	Zinc plated		Yes	0057 16 130	25
M16	140 mm	10 mm	WS24	Steel	8.8	Zinc plated		Yes	0057 16 140	25
M16	145 mm		WS24	Steel	8.8	Zinc plated		Yes	0057 16 145	25
M16	150 mm	10 mm	WS24	Steel	8.8	Zinc plated		Yes	0057 16 150	25
M16	160 mm	10 mm	WS24	Steel	8.8	Zinc plated		Yes	0057 16 160	25
M16	170 mm	10 mm	WS24	Steel	8.8	Zinc plated		Yes	0057 16 170	25
M16	180 mm	10 mm	WS24	Steel	8.8	Zinc plated		Yes	0057 16 180	25
M16	190 mm	10 mm	WS24	Steel	8.8	Zinc plated		Yes	0057 16 190	25
M16	200 mm	10 mm	WS24	Steel	8.8	Zinc plated		Yes	0057 16 200	10/25
M16	210 mm	10 mm	WS24	Steel	8.8	Zinc plated		Yes	0057 16 210	25
M16	220 mm	10 mm	WS24	Steel	8.8	Zinc plated		Yes	0057 16 220	50
M16	230 mm	10 mm	WS24	Steel	8.8	Zinc plated		Yes	0057 16 230	25
M16	240 mm	10 mm	WS24	Steel	8.8	Zinc plated		Yes	0057 16 240	10
M16	250 mm	10 mm	WS24	Steel	8.8	Zinc plated		Yes	0057 16 250	25
M16	260 mm	10 mm	WS24	Steel	8.8	Zinc plated		Yes	0057 16 260	10
M16	280 mm	10 mm	WS24	Steel	8.8	Zinc plated		Yes	0057 16 280	10
M16	300 mm	10 mm	WS24	Steel	8.8	Zinc plated		Yes	0057 16 300	10
M16	320 mm	10 mm	WS24	Steel	8.8	Zinc plated		Yes	0057 16 320	10
M16	340 mm	10 mm	WS24	Steel	8.8	Zinc plated		Yes	0057 16 340	10
M16	350 mm	10 mm	WS24	Steel	8.8	Zinc plated		Yes	0057 16 350	25
M16	360 mm	10 mm	WS24	Steel	8.8	Zinc plated		Yes	0057 16 360	25
M16	380 mm	10 mm	WS24	Steel	8.8	Zinc plated		Yes	0057 16 380	25
M16	500 mm	10 mm	WS24	Steel	8.8	Zinc plated		Yes	0057 16 500	10
M18	30 mm	11.5 mm	WS27	Steel	8.8	Zinc plated		Yes	0057 18 30	50
M18	35 mm	11.5 mm	WS27	Steel	8.8	Zinc plated		Yes	0057 18 35	50
M18	40 mm	11.5 mm	WS27	Steel	8.8	Zinc plated		Yes	0057 18 40	50
M18	45 mm	11.5 mm	WS27	Steel	8.8	Zinc plated		Yes	0057 18 45	50
M18	50 mm	11.5 mm	WS27	Steel	8.8	Zinc plated		Yes	0057 18 50	50
M18	55 mm	11.5 mm	WS27	Steel	8.8	Zinc plated		Yes	0057 18 55	25
M18	60 mm	11.5 mm	WS27	Steel	8.8	Zinc plated		Yes	0057 18 60	25
M18	65 mm	11.5 mm	WS27	Steel	8.8	Zinc plated		Yes	0057 18 65	25
M18	70 mm	11.5 mm	WS27	Steel	8.8	Zinc plated		Yes	0057 18 70	25
M18	80 mm	11.5 mm	WS27	Steel	8.8	Zinc plated		Yes	0057 18 80	25
M18	90 mm	11.5 mm	WS27	Steel	8.8	Zinc plated		Yes	0057 18 90	25
M18	100 mm	11.5 mm	WS27	Steel	8.8	Zinc plated		Yes	0057 18 100	25
M18	110 mm	11.5 mm	WS27	Steel	8.8	Zinc plated		Yes	0057 18 110	25
M18	120 mm	11.5 mm	WS27	Steel	8.8	Zinc plated		Yes	0057 18 120	25
M18	130 mm	11.5 mm	WS27	Steel	8.8	Zinc plated		Yes	0057 18 130	25
M18	140 mm	11.5 mm	WS27	Steel	8.8	Zinc plated		Yes	0057 18 140	25
M18	150 mm	11.5 mm	WS27	Steel	8.8	Zinc plated		Yes	0057 18 150	25

Thread type x nominal diameter (d ₁)	Length (l ₁)	Head height (k ₁)	External drive (s ₁)	Material	Property class	Surface	Corrosion protection period	RoHS-compliant	Art. no.	P. Qty.
M18	180 mm	11.5 mm	WS27	Steel	8.8	Zinc plated		Yes	0057 18 180	25
M18	200 mm	11.5 mm	WS27	Steel	8.8	Zinc plated		Yes	0057 18 200	25
M20	16 mm	12.5 mm	WS30	Steel	8.8	Zinc plated		Yes	0057 20 16	50
M20	20 mm	12.5 mm	WS30	Steel	8.8	Zinc plated		Yes	0057 20 20	50
M20	25 mm	12.5 mm	WS30	Steel	8.8	Zinc plated		Yes	0057 20 25	25
M20	30 mm	12.5 mm	WS30	Steel	8.8	Zinc plated		Yes	0057 20 30	25/50
M20	35 mm	12.5 mm	WS30	Steel	8.8	Zinc plated		Yes	0057 20 35	25
M20	40 mm	12.5 mm	WS30	Steel	8.8	Zinc plated		Yes	0057 20 40	25
M20	45 mm	12.5 mm	WS30	Steel	8.8	Zinc plated		Yes	0057 20 45	25
M20	50 mm	12.5 mm	WS30	Steel	8.8	Zinc plated		Yes	0057 20 50	25
M20	55 mm	12.5 mm	WS30	Steel	8.8	Zinc plated		Yes	0057 20 55	25
M20	60 mm	12.5 mm	WS30	Steel	8.8	Zinc plated		Yes	0057 20 60	25
M20	65 mm	12.5 mm	WS30	Steel	8.8	Zinc plated		Yes	0057 20 65	25
M20	70 mm	12.5 mm	WS30	Steel	8.8	Zinc plated		Yes	0057 20 70	25
M20	75 mm	12.5 mm	WS30	Steel	8.8	Zinc plated		Yes	0057 20 75	25
M20	80 mm	12.5 mm	WS30	Steel	8.8	Zinc plated		Yes	0057 20 80	25
M20	85 mm	12.5 mm	WS30	Steel	8.8	Zinc plated		Yes	0057 20 85	25
M20	90 mm	12.5 mm	WS30	Steel	8.8	Zinc plated		Yes	0057 20 90	25
M20	95 mm	12.5 mm	WS30	Steel	8.8	Zinc plated		Yes	0057 20 95	25
M20	100 mm	12.5 mm	WS30	Steel	8.8	Zinc plated		Yes	0057 20 100	25
M20	110 mm	12.5 mm	WS30	Steel	8.8	Zinc plated		Yes	0057 20 110	25
M20	115 mm	12.5 mm	WS30	Steel	8.8	Zinc plated		Yes	0057 20 115	25
M20	120 mm	12.5 mm	WS30	Steel	8.8	Zinc plated		Yes	0057 20 120	10/25
M20	130 mm	12.5 mm	WS30	Steel	8.8	Zinc plated		Yes	0057 20 130	10/25
M20	140 mm	12.5 mm	WS30	Steel	8.8	Zinc plated		Yes	0057 20 140	10/25
M20	150 mm	12.5 mm	WS30	Steel	8.8	Zinc plated		Yes	0057 20 150	10/25
M20	155 mm	12.5 mm	WS30	Steel	8.8	Zinc plated		Yes	0057 20 155	25
M20	160 mm	12.5 mm	WS30	Steel	8.8	Zinc plated		Yes	0057 20 160	10/25
M20	170 mm	12.5 mm	WS30	Steel	8.8	Zinc plated		Yes	0057 20 170	10
M20	180 mm	12.5 mm	WS30	Steel	8.8	Zinc plated		Yes	0057 20 180	10/25
M20	190 mm	12.5 mm	WS30	Steel	8.8	Zinc plated		Yes	0057 20 190	10
M20	200 mm	12.5 mm	WS30	Steel	8.8	Zinc plated		Yes	0057 20 200	10
M20	210 mm	12.5 mm	WS30	Steel	8.8	Zinc plated		Yes	0057 20 210	10
M20	220 mm	12.5 mm	WS30	Steel	8.8	Zinc plated		Yes	0057 20 220	10
M20	230 mm	12.5 mm	WS30	Steel	8.8	Zinc plated		Yes	0057 20 230	20
M20	240 mm	12.5 mm	WS30	Steel	8.8	Zinc plated		Yes	0057 20 240	10
M20	250 mm	12.5 mm	WS30	Steel	8.8	Zinc plated		Yes	0057 20 250	10
M20	260 mm	12.5 mm	WS30	Steel	8.8	Zinc plated		Yes	0057 20 260	10
M20	280 mm	12.5 mm	WS30	Steel	8.8	Zinc plated		Yes	0057 20 280	10
M20	300 mm	12.5 mm	WS30	Steel	8.8	Zinc plated		Yes	0057 20 300	10
M20	320 mm	12.5 mm	WS30	Steel	8.8	Zinc plated		Yes	0057 20 320	10
M20	340 mm	12.5 mm	WS30	Steel	8.8	Zinc plated		Yes	0057 20 340	1
M20	350 mm	12.5 mm	WS30	Steel	8.8	Zinc plated		Yes	0057 20 350	1
M20	360 mm	12.5 mm	WS30	Steel	8.8	Zinc plated		Yes	0057 20 360	1
M20	380 mm	12.5 mm	WS30	Steel	8.8	Zinc plated		Yes	0057 20 380	1
M20	400 mm	12.5 mm	WS30	Steel	8.8	Zinc plated		Yes	0057 20 400	20
M20	460 mm	12.5 mm	WS30	Steel	8.8	Zinc plated		Yes	0057 20 460	25
M22	50 mm	14 mm	WS34	Steel	8.8	Zinc plated		Yes	0057 922 50	25
M22	60 mm	14 mm	WS34	Steel	8.8	Zinc plated		Yes	0057 922 60	25
M22	70 mm	14 mm	WS34	Steel	8.8	Zinc plated		Yes	0057 922 70	10
M22	80 mm	14 mm	WS34	Steel	8.8	Zinc plated		Yes	0057 922 80	25

Thread type x nominal diameter (d ₁)	Length (l ₁)	Head height (k ₁)	External drive (s ₁)	Material	Property class	Surface	Corrosion protection period	RoHS-compliant	Art. no.	P. Qty.
M24	20 mm	15 mm	WS36	Steel	8.8	Zinc plated		Yes	0057 24 20	25
M24	30 mm	15 mm	WS36	Steel	8.8	Zinc plated		Yes	0057 24 30	25
M24	35 mm	15 mm	WS36	Steel	8.8	Zinc plated		Yes	0057 24 35	25
M24	40 mm	15 mm	WS36	Steel	8.8	Zinc plated		Yes	0057 24 40	25
M24	45 mm	15 mm	WS36	Steel	8.8	Zinc plated		Yes	0057 24 45	25
M24	50 mm	15 mm	WS36	Steel	8.8	Zinc plated		Yes	0057 24 50	20/25
M24	55 mm	15 mm	WS36	Steel	8.8	Zinc plated		Yes	0057 24 55	1/10/25
M24	60 mm	15 mm	WS36	Steel	8.8	Zinc plated		Yes	0057 24 60	25
M24	65 mm	15 mm	WS36	Steel	8.8	Zinc plated		Yes	0057 24 65	1/10/25
M24	70 mm	15 mm	WS36	Steel	8.8	Zinc plated		Yes	0057 24 70	10/25
M24	75 mm	15 mm	WS36	Steel	8.8	Zinc plated		Yes	0057 24 75	1/10/25
M24	80 mm	15 mm	WS36	Steel	8.8	Zinc plated		Yes	0057 24 80	15/25
M24	85 mm	15 mm	WS36	Steel	8.8	Zinc plated		Yes	0057 24 85	10
M24	90 mm	15 mm	WS36	Steel	8.8	Zinc plated		Yes	0057 24 90	10
M24	100 mm	15 mm	WS36	Steel	8.8	Zinc plated		Yes	0057 24 100	10
M24	110 mm	15 mm	WS36	Steel	8.8	Zinc plated		Yes	0057 24 110	10
M24	115 mm	15 mm	WS36	Steel	8.8	Zinc plated		Yes	0057 24 115	25
M24	120 mm	15 mm	WS36	Steel	8.8	Zinc plated		Yes	0057 24 120	10
M24	125 mm	15 mm	WS36	Steel	8.8	Zinc plated		Yes	0057 24 125	25
M24	130 mm	15 mm	WS36	Steel	8.8	Zinc plated		Yes	0057 24 130	10
M24	140 mm	15 mm	WS36	Steel	8.8	Zinc plated		Yes	0057 24 140	10
M24	150 mm	15 mm	WS36	Steel	8.8	Zinc plated		Yes	0057 24 150	1/5/10
M24	160 mm	15 mm	WS36	Steel	8.8	Zinc plated		Yes	0057 24 160	1/5/10
M24	170 mm	15 mm	WS36	Steel	8.8	Zinc plated		Yes	0057 24 170	10
M24	180 mm	15 mm	WS36	Steel	8.8	Zinc plated		Yes	0057 24 180	1/5/10
M24	190 mm	15 mm	WS36	Steel	8.8	Zinc plated		Yes	0057 24 190	10
M24	200 mm	15 mm	WS36	Steel	8.8	Zinc plated		Yes	0057 24 200	10
M24	210 mm	15 mm	WS36	Steel	8.8	Zinc plated		Yes	0057 24 210	10
M24	220 mm	15 mm	WS36	Steel	8.8	Zinc plated		Yes	0057 24 220	10
M24	240 mm	15 mm	WS36	Steel	8.8	Zinc plated		Yes	0057 24 240	5
M24	250 mm	15 mm	WS36	Steel	8.8	Zinc plated		Yes	0057 24 250	10
M24	260 mm	15 mm	WS36	Steel	8.8	Zinc plated		Yes	0057 24 260	5
M24	280 mm	15 mm	WS36	Steel	8.8	Zinc plated		Yes	0057 24 280	10
M24	300 mm	15 mm	WS36	Steel	8.8	Zinc plated		Yes	0057 24 300	10
M24	320 mm	15 mm	WS36	Steel	8.8	Zinc plated		Yes	0057 24 320	10
M24	380 mm	15 mm	WS36	Steel	8.8	Zinc plated		Yes	0057 24 380	5
M24	420 mm	15 mm	WS36	Steel	8.8	Zinc plated		Yes	0057 24 420	5
M24	440 mm	15 mm	WS36	Steel	8.8	Zinc plated		Yes	0057 24 440	10
M27	40 mm	17 mm	WS41	Steel	8.8	Zinc plated		Yes	0057 27 40	25
M27	50 mm	17 mm	WS41	Steel	8.8	Zinc plated		Yes	0057 27 50	10
M27	60 mm	17 mm	WS41	Steel	8.8	Zinc plated		Yes	0057 27 60	1/5
M27	65 mm	17 mm	WS41	Steel	8.8	Zinc plated		Yes	0057 27 65	10
M27	70 mm	17 mm	WS41	Steel	8.8	Zinc plated		Yes	0057 27 70	10
M27	75 mm	17 mm	WS41	Steel	8.8	Zinc plated		Yes	0057 27 75	10
M27	80 mm	17 mm	WS41	Steel	8.8	Zinc plated		Yes	0057 27 80	10
M27	85 mm	17 mm	WS41	Steel	8.8	Zinc plated		Yes	0057 27 85	10
M27	90 mm	17 mm	WS41	Steel	8.8	Zinc plated		Yes	0057 27 90	10
M27	95 mm	17 mm	WS41	Steel	8.8	Zinc plated		Yes	0057 27 95	10
M27	100 mm	17 mm	WS41	Steel	8.8	Zinc plated		Yes	0057 27 100	10
M27	110 mm	17 mm	WS41	Steel	8.8	Zinc plated		Yes	0057 27 110	10
M27	120 mm	17 mm	WS41	Steel	8.8	Zinc plated		Yes	0057 27 120	10

Thread type x nominal diameter (d ₁)	Length (l ₁)	Head height (k ₁)	External drive (s ₁)	Material	Property class	Surface	Corrosion protection period	RoHS-compliant	Art. no.	P. Qty.
M27	130 mm	17 mm	WS41	Steel	8.8	Zinc plated		Yes	0057 27 130	10
M27	140 mm	17 mm	WS41	Steel	8.8	Zinc plated		Yes	0057 27 140	10
M27	150 mm	17 mm	WS41	Steel	8.8	Zinc plated		Yes	0057 27 150	10
M27	160 mm	17 mm	WS41	Steel	8.8	Zinc plated		Yes	0057 27 160	10
M27	180 mm	17 mm	WS41	Steel	8.8	Zinc plated		Yes	0057 27 180	10
M27	200 mm	17 mm	WS41	Steel	8.8	Zinc plated		Yes	0057 27 200	10
M27	240 mm	17 mm	WS41	Steel	8.8	Zinc plated		Yes	0057 27 240	10
M30	30 mm	18.7 mm	WS46	Steel	8.8	Zinc plated		Yes	0057 30 30	10
M30	35 mm	18.7 mm	WS46	Steel	8.8	Zinc plated		Yes	0057 30 35	10
M30	40 mm	18.7 mm	WS46	Steel	8.8	Zinc plated		Yes	0057 30 40	10
M30	45 mm	18.7 mm	WS46	Steel	8.8	Zinc plated		Yes	0057 30 45	10
M30	50 mm	18.7 mm	WS46	Steel	8.8	Zinc plated		Yes	0057 30 50	1/5/10
M30	55 mm	18.7 mm	WS46	Steel	8.8	Zinc plated		Yes	0057 30 55	10
M30	60 mm	18.7 mm	WS46	Steel	8.8	Zinc plated		Yes	0057 30 60	10
M30	65 mm	18.7 mm	WS46	Steel	8.8	Zinc plated		Yes	0057 30 65	10
M30	70 mm	18.7 mm	WS46	Steel	8.8	Zinc plated		Yes	0057 30 70	10
M30	75 mm	18.7 mm	WS46	Steel	8.8	Zinc plated		Yes	0057 30 75	10
M30	80 mm	18.7 mm	WS46	Steel	8.8	Zinc plated		Yes	0057 30 80	10
M30	85 mm	18.7 mm	WS46	Steel	8.8	Zinc plated		Yes	0057 30 85	10
M30	90 mm	18.7 mm	WS46	Steel	8.8	Zinc plated		Yes	0057 30 90	1/5
M30	100 mm	18.7 mm	WS46	Steel	8.8	Zinc plated		Yes	0057 30 100	10
M30	110 mm	18.7 mm	WS46	Steel	8.8	Zinc plated		Yes	0057 30 110	10
M30	120 mm	18.7 mm	WS46	Steel	8.8	Zinc plated		Yes	0057 30 120	1/5
M30	130 mm	18.7 mm	WS46	Steel	8.8	Zinc plated		Yes	0057 30 130	5
M30	140 mm	18.7 mm	WS46	Steel	8.8	Zinc plated		Yes	0057 30 140	5
M30	150 mm	18.7 mm	WS46	Steel	8.8	Zinc plated		Yes	0057 30 150	1/5
M30	160 mm	18.7 mm	WS46	Steel	8.8	Zinc plated		Yes	0057 30 160	5
M30	165 mm	18.7 mm	WS46	Steel	8.8	Zinc plated		Yes	0057 30 165	10
M30	170 mm	18.7 mm	WS46	Steel	8.8	Zinc plated		Yes	0057 30 170	10
M30	180 mm	18.7 mm	WS46	Steel	8.8	Zinc plated		Yes	0057 30 180	5
M30	200 mm	18.7 mm	WS46	Steel	8.8	Zinc plated		Yes	0057 30 200	10
M30	220 mm	18.7 mm	WS46	Steel	8.8	Zinc plated		Yes	0057 30 220	5
M30	230 mm	19.12 mm	WS46	Steel	8.8	Zinc plated		Yes	0057 30 230	10
M30	240 mm	18.7 mm	WS46	Steel	8.8	Zinc plated		Yes	0057 30 240	5
M30	250 mm	18.7 mm	WS46	Steel	8.8	Zinc plated		Yes	0057 30 250	10
M30	260 mm	18.7 mm	WS46	Steel	8.8	Zinc plated		Yes	0057 30 260	5
M30	280 mm	18.7 mm	WS46	Steel	8.8	Zinc plated		Yes	0057 30 280	10
M30	300 mm	18.7 mm	WS46	Steel	8.8	Zinc plated		Yes	0057 30 300	10
M30	320 mm	18.7 mm	WS46	Steel	8.8	Zinc plated		Yes	0057 30 320	5
M30	380 mm	18.7 mm	WS46	Steel	8.8	Zinc plated		Yes	0057 30 380	10
M33	70 mm	21 mm	WS50	Steel	8.8	Zinc plated		Yes	0057 33 70	10
M33	75 mm	21 mm	WS50	Steel	8.8	Zinc plated		Yes	0057 33 75	10
M33	80 mm	21 mm	WS50	Steel	8.8	Zinc plated		Yes	0057 33 80	10
M33	85 mm	21 mm	WS50	Steel	8.8	Zinc plated		Yes	0057 33 85	10
M33	90 mm	21 mm	WS50	Steel	8.8	Zinc plated		Yes	0057 33 90	10
M33	100 mm	21 mm	WS50	Steel	8.8	Zinc plated		Yes	0057 33 100	10
M33	110 mm	21 mm	WS50	Steel	8.8	Zinc plated		Yes	0057 33 110	10
M33	120 mm	21 mm	WS50	Steel	8.8	Zinc plated		Yes	0057 33 120	10
M33	130 mm	21 mm	WS50	Steel	8.8	Zinc plated		Yes	0057 33 130	5
M33	140 mm	21 mm	WS50	Steel	8.8	Zinc plated		Yes	0057 33 140	5
M33	150 mm	21 mm	WS50	Steel	8.8	Zinc plated		Yes	0057 33 150	20

Thread type x nominal diameter (d ₁)	Length (l ₁)	Head height (k ₁)	External drive (s ₁)	Material	Property class	Surface	Corrosion protection period	RoHS-compliant	Art. no.	P. Qty.
M33	160 mm	21 mm	WS50	Steel	8.8	Zinc plated		Yes	0057 33 160	10
M33	170 mm	21 mm	WS50	Steel	8.8	Zinc plated		Yes	0057 33 170	5
M33	180 mm	21 mm	WS50	Steel	8.8	Zinc plated		Yes	0057 33 180	10
M36	35 mm	22.5 mm	WS55	Steel	8.8	Zinc plated		Yes	0057 36 35	10
M36	50 mm	22.5 mm	WS55	Steel	8.8	Zinc plated		Yes	0057 36 50	10
M36	55 mm	22.5 mm	WS55	Steel	8.8	Zinc plated		Yes	0057 36 55	5
M36	60 mm	22.5 mm	WS55	Steel	8.8	Zinc plated		Yes	0057 36 60	10
M36	65 mm	22.5 mm	WS55	Steel	8.8	Zinc plated		Yes	0057 36 65	10
M36	70 mm	22.5 mm	WS55	Steel	8.8	Zinc plated		Yes	0057 36 70	10
M36	75 mm	22.5 mm	WS55	Steel	8.8	Zinc plated		Yes	0057 36 75	10
M36	80 mm	22.5 mm	WS55	Steel	8.8	Zinc plated		Yes	0057 36 80	5
M36	85 mm	22.5 mm	WS55	Steel	8.8	Zinc plated		Yes	0057 36 85	10
M36	90 mm	22.5 mm	WS55	Steel	8.8	Zinc plated		Yes	0057 36 90	5
M36	100 mm	22.5 mm	WS55	Steel	8.8	Zinc plated		Yes	0057 36 100	5
M36	110 mm	22.5 mm	WS55	Steel	8.8	Zinc plated		Yes	0057 36 110	10
M36	120 mm	22.5 mm	WS55	Steel	8.8	Zinc plated		Yes	0057 36 120	5
M36	130 mm	22.5 mm	WS55	Steel	8.8	Zinc plated		Yes	0057 36 130	10
M36	140 mm	22.5 mm	WS55	Steel	8.8	Zinc plated		Yes	0057 36 140	10
M36	150 mm	22.5 mm	WS55	Steel	8.8	Zinc plated		Yes	0057 36 150	5
M36	160 mm	22.5 mm	WS55	Steel	8.8	Zinc plated		Yes	0057 36 160	5
M36	170 mm	22.5 mm	WS55	Steel	8.8	Zinc plated		Yes	0057 36 170	5
M36	180 mm	22.5 mm	WS55	Steel	8.8	Zinc plated		Yes	0057 36 180	10
M36	200 mm	22.5 mm	WS55	Steel	8.8	Zinc plated		Yes	0057 36 200	5
M36	220 mm	22.5 mm	WS55	Steel	8.8	Zinc plated		Yes	0057 36 220	10
M36	230 mm	22.5 mm	WS55	Steel	8.8	Zinc plated		Yes	0057 36 230	1
M36	240 mm	22.5 mm	WS55	Steel	8.8	Zinc plated		Yes	0057 36 240	5
M36	250 mm	22.5 mm	WS55	Steel	8.8	Zinc plated		Yes	0057 36 250	5
M36	300 mm	22.5 mm	WS55	Steel	8.8	Zinc plated		Yes	0057 36 300	5
M36	350 mm	22.5 mm	WS55	Steel	8.8	Zinc plated		Yes	0057 36 350	1
M36	380 mm	22.5 mm	WS55	Steel	8.8	Zinc plated		Yes	0057 36 380	1
M36	650 mm	22.5 mm	WS55	Steel	8.8	Zinc plated		Yes	0057 36 650	1
M39	90 mm	25 mm	WS60	Steel	8.8	Zinc plated		Yes	0057 39 90	5
M39	95 mm	25 mm	WS60	Steel	8.8	Zinc plated		Yes	0057 39 95	1
M39	100 mm	25 mm	WS60	Steel	8.8	Zinc plated		Yes	0057 39 100	10
M39	110 mm	25 mm	WS60	Steel	8.8	Zinc plated		Yes	0057 39 110	5
M39	120 mm	25 mm	WS60	Steel	8.8	Zinc plated		Yes	0057 39 120	10
M39	130 mm	25 mm	WS60	Steel	8.8	Zinc plated		Yes	0057 39 130	1
M39	140 mm	25 mm	WS60	Steel	8.8	Zinc plated		Yes	0057 39 140	5
M39	150 mm	25 mm	WS60	Steel	8.8	Zinc plated		Yes	0057 39 150	5
M39	170 mm	25 mm	WS60	Steel	8.8	Zinc plated		Yes	0057 39 170	5
M39	180 mm	25 mm	WS60	Steel	8.8	Zinc plated		Yes	0057 39 180	5
M39	200 mm	25 mm	WS60	Steel	8.8	Zinc plated		Yes	0057 39 200	5
M39	210 mm	25 mm	WS60	Steel	8.8	Zinc plated		Yes	0057 39 210	5
M42	50 mm	26 mm	WS65	Steel	8.8	Zinc plated		Yes	0057 42 50	10
M42	60 mm	26 mm	WS65	Steel	8.8	Zinc plated		Yes	0057 42 60	5
M42	70 mm	26 mm	WS65	Steel	8.8	Zinc plated		Yes	0057 42 70	5
M42	80 mm	26 mm	WS65	Steel	8.8	Zinc plated		Yes	0057 42 80	5
M42	90 mm	26 mm	WS65	Steel	8.8	Zinc plated		Yes	0057 42 90	10
M42	100 mm	26 mm	WS65	Steel	8.8	Zinc plated		Yes	0057 42 100	5
M42	110 mm	26 mm	WS65	Steel	8.8	Zinc plated		Yes	0057 42 110	5
M42	120 mm	26 mm	WS65	Steel	8.8	Zinc plated		Yes	0057 42 120	5

Thread type x nominal diameter (d ₁)	Length (l ₁)	Head height (k ₁)	External drive (s ₁)	Material	Property class	Surface	Corrosion protection period	RoHS-compliant	Art. no.	P. Qty.
M42	130 mm	26 mm	WS65	Steel	8.8	Zinc plated		Yes	0057 42 130	5
M42	140 mm	26 mm	WS65	Steel	8.8	Zinc plated		Yes	0057 42 140	5
M42	150 mm	26 mm	WS65	Steel	8.8	Zinc plated		Yes	0057 42 150	5
M42	160 mm	26 mm	WS65	Steel	8.8	Zinc plated		Yes	0057 42 160	5
M42	180 mm	26 mm	WS65	Steel	8.8	Zinc plated		Yes	0057 42 180	5
M42	200 mm	26 mm	WS65	Steel	8.8	Zinc plated		Yes	0057 42 200	5
M42	240 mm	26 mm	WS65	Steel	8.8	Zinc plated		Yes	0057 42 240	5
M42	260 mm	26 mm	WS65	Steel	8.8	Zinc plated		Yes	0057 42 260	1
M42	280 mm	26 mm	WS65	Steel	8.8	Zinc plated		Yes	0057 42 280	5
M42	340 mm	25.58 mm	WS65	Steel	8.8	Zinc plated		Yes	0057 42 340	5
M45	80 mm	28 mm	WS70	Steel	8.8	Zinc plated		Yes	0057 45 80	5
M45	120 mm	28 mm	WS70	Steel	8.8	Zinc plated		Yes	0057 45 120	5
M45	180 mm	28 mm	WS70	Steel	8.8	Zinc plated		Yes	0057 45 180	5
M45	190 mm	28 mm	WS70	Steel	8.8	Zinc plated		Yes	0057 45 190	1
M48	60 mm	30 mm	WS75	Steel	8.8	Zinc plated		Yes	0057 48 60	5
M48	70 mm	30 mm	WS75	Steel	8.8	Zinc plated		Yes	0057 48 70	5
M48	80 mm	30 mm	WS75	Steel	8.8	Zinc plated		Yes	0057 48 80	5
M48	90 mm	30 mm	WS75	Steel	8.8	Zinc plated		Yes	0057 48 90	1
M48	100 mm	30 mm	WS75	Steel	8.8	Zinc plated		Yes	0057 48 100	5
M48	110 mm	30 mm	WS75	Steel	8.8	Zinc plated		Yes	0057 48 110	5
M48	120 mm	30 mm	WS75	Steel	8.8	Zinc plated		Yes	0057 48 120	5
M48	130 mm	30 mm	WS75	Steel	8.8	Zinc plated		Yes	0057 48 130	5
M48	140 mm	30 mm	WS75	Steel	8.8	Zinc plated		Yes	0057 48 140	5
M48	160 mm	30 mm	WS75	Steel	8.8	Zinc plated		Yes	0057 48 160	1
M48	180 mm	30 mm	WS75	Steel	8.8	Zinc plated		Yes	0057 48 180	5
M48	220 mm	30 mm	WS75	Steel	8.8	Zinc plated		Yes	0057 48 220	1
M48	260 mm	30 mm	WS75	Steel	8.8	Zinc plated		Yes	0057 48 260	1
M52	110 mm	33 mm	WS80	Steel	8.8	Zinc plated		Yes	0057 52 110	1
M52	200 mm	33 mm	WS80	Steel	8.8	Zinc plated		Yes	0057 52 200	1
M56	60 mm	35 mm	WS85	Steel	8.8	Zinc plated		Yes	0057 56 60	5
M56	70 mm	35 mm	WS85	Steel	8.8	Zinc plated		Yes	0057 56 70	5
M56	80 mm	35 mm	WS85	Steel	8.8	Zinc plated		Yes	0057 56 80	5
M56	100 mm	35 mm	WS85	Steel	8.8	Zinc plated		Yes	0057 56 100	5
M56	130 mm	35 mm	WS85	Steel	8.8	Zinc plated		Yes	0057 56 130	1
M56	140 mm	35 mm	WS85	Steel	8.8	Zinc plated		Yes	0057 56 140	1
M56	150 mm	35 mm	WS8	Steel	8.8	Zinc plated		Yes	0057 56 150	10
M56	160 mm	35 mm	WS85	Steel	8.8	Zinc plated		Yes	0057 56 160	1
M56	180 mm	35 mm	WS85	Steel	8.8	Zinc plated		Yes	0057 56 180	5
M56	200 mm	35 mm	WS8	Steel	8.8	Zinc plated		Yes	0057 56 200	1
M56	240 mm	35 mm	WS85	Steel	8.8	Zinc plated		Yes	0057 56 240	1
M64	60 mm	40 mm	WS95	Steel	8.8	Zinc plated		Yes	0057 64 60	5
M64	150 mm	40 mm	WS95	Steel	8.8	Zinc plated		Yes	0057 64 150	5
M64	190 mm	40 mm	WS95	Steel	8.8	Zinc plated		Yes	0057 64 190	1
M64	220 mm	40 mm	WS95	Steel	8.8	Zinc plated		Yes	0057 64 220	1

Notice

ISO 4017 replaces DIN 933 | There is some similarity | Nominal dimensions extended | Width across flats changed for M10, M12, M14 and M22.